

# SHIMANO®

## 1987 REPAIR MANUAL

Shimano American Corporation, One Shimano Dr.  
Irvine, CA 92718

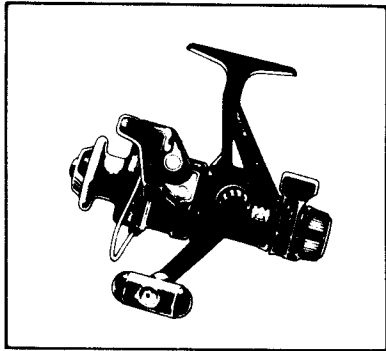

### TO ORDER:

This reel belongs to the "Rear Drag" series.  
Please order parts using the abbreviation  
"RD" and the part number.

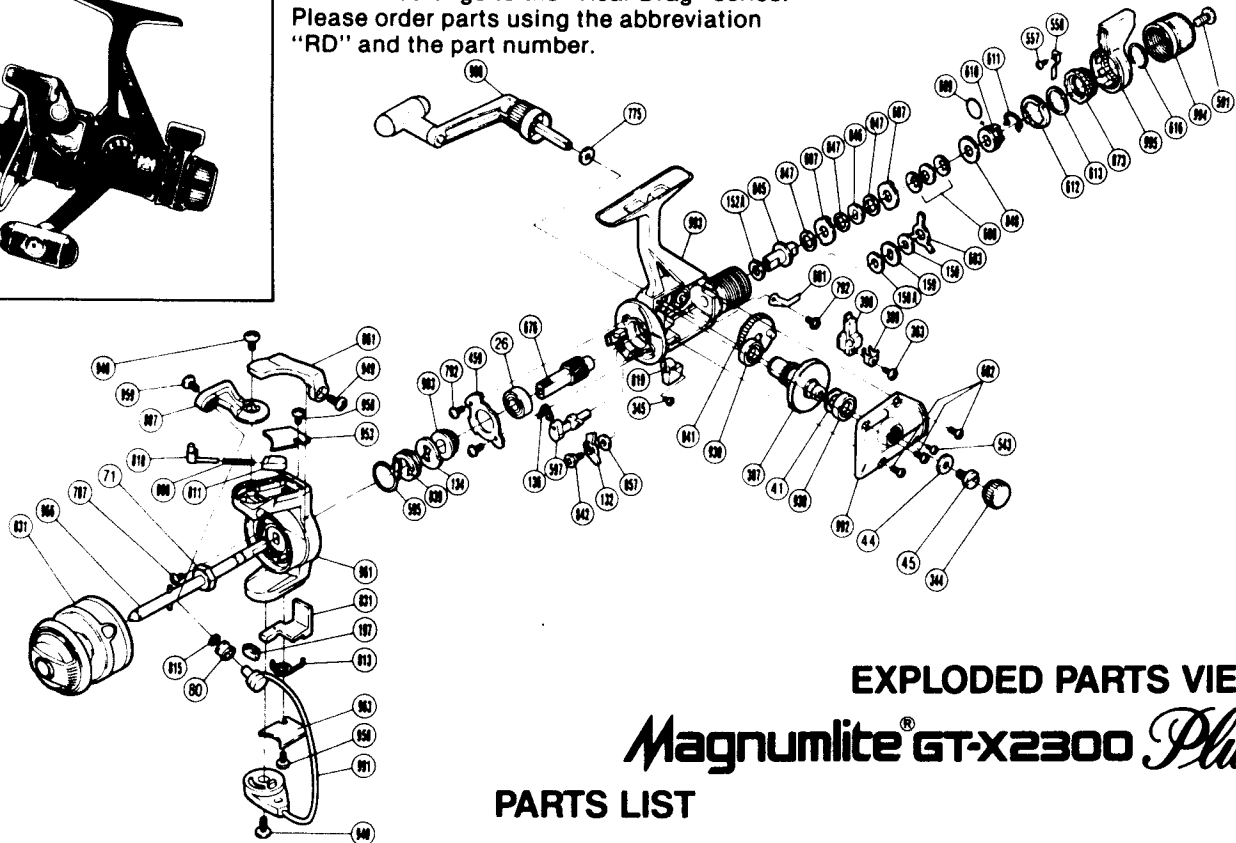

### EXPLODED PARTS VIEW

## Magnumlite® GT-X2300 Plus

### PARTS LIST

#### PART # DESCRIPTION

- 26. Ball Bearing
- 41. Drive Gear Washer
- 44. Handle Lock Washer
- 45. Handle Lock Screw  
(Originally 796)
- 71. Rotor Nut
- 80. Line Roller
- 132. Anti-Reverse Pawl
- 134. Anti-Reverse Ratchet
- 136. Anti-Reverse Cam Spring
- 150. Drag Washer "C<sub>1</sub>"
- 150A. Drag Washer "C<sub>2</sub>"
- 152A. Drag Washer "D<sub>2</sub>"
- 159. Click Gear
- 197. Bail Trip Slide Cam
- 344. Handle Screw Cap
- 345. Anti-Reverse Lever Screw
- 363. Slider Retainer Screw
- 387. Drive Gear
- 389. Oscillating Slider  
Retainer
- 390. Oscillating Slider
- 459. Bearing Retainer
- 543. Side Cover Screw B
- 557. Fightin' Drag Click Screw
- 558. Fightin' Drag Click
- 591. Drag Programmer Screw

#### PART # DESCRIPTION

- 595. Anti-Reverse Pawl Spring
- 597. Anti-Reverse Cam
- 601. Drag Click
- 602. Side Cover Screw A
- 603. Eared Washer "B"
- 607. Eared Washer "B"
- 608. Coned Disk Springs
- 609. "O" Ring
- 610. Pressure Screw
- 611. Hold Click Spring
- 612. Lever Click Gear
- 613. Fightin' Pressure Screw  
Washer
- 616. Lever Hold Spring
- 676. Pinion Gear
- 775. Handle Lock Spacer
- 787. Nut Lock Screw
- 792. Multi Purpose Screw
- 807. Bail Arm
- 808. Bail Spring
- 810. Bail Spring Guide A
- 811. Bail Spring Guide B
- 813. Lever Spring
- 815. Line Roller Washer
- 819. Anti-Reverse Lever
- 831. Spool Assembly (Universal)
- 836. Bail Trip Lever

#### PART # DESCRIPTION

- 839. Anti-Reverse Spring  
Holder
- 841. Oscillating Gear
- 842. Anti-Reverse Pawl Screw
- 845. Drag Shaft
- 846. Key Washer "A"
- 847. Drag Washer "H<sub>1</sub>"
- 848. Drag Spring Washer "A"
- 857. Anti-Reverse Pawl Spacer
- 861. Quick-Fire II Trigger
- 873. Fightin' Pressure Screw
- 903. Pinion Spacer
- 908. Handle Assembly
- 930. Ball Bearing
- 940. Bail Trip Cam Screw
- 949. Trigger Screw
- 953. Bail Spring Cover
- 958. Bail Trip Cover Screw
- 959. Line Roller Screw
- 961. Rotor
- 963. Bail Trip Cover
- 966. Main Shaft
- 991. Bail Assembly
- 992. Side Cover
- 993. Body
- 994. Drag Programmer
- 995. Fightin' Drag Lever

Prices and specifications subject to change without notice.

JUNE 1986