

SHIMANO

1996 Repair Supplement

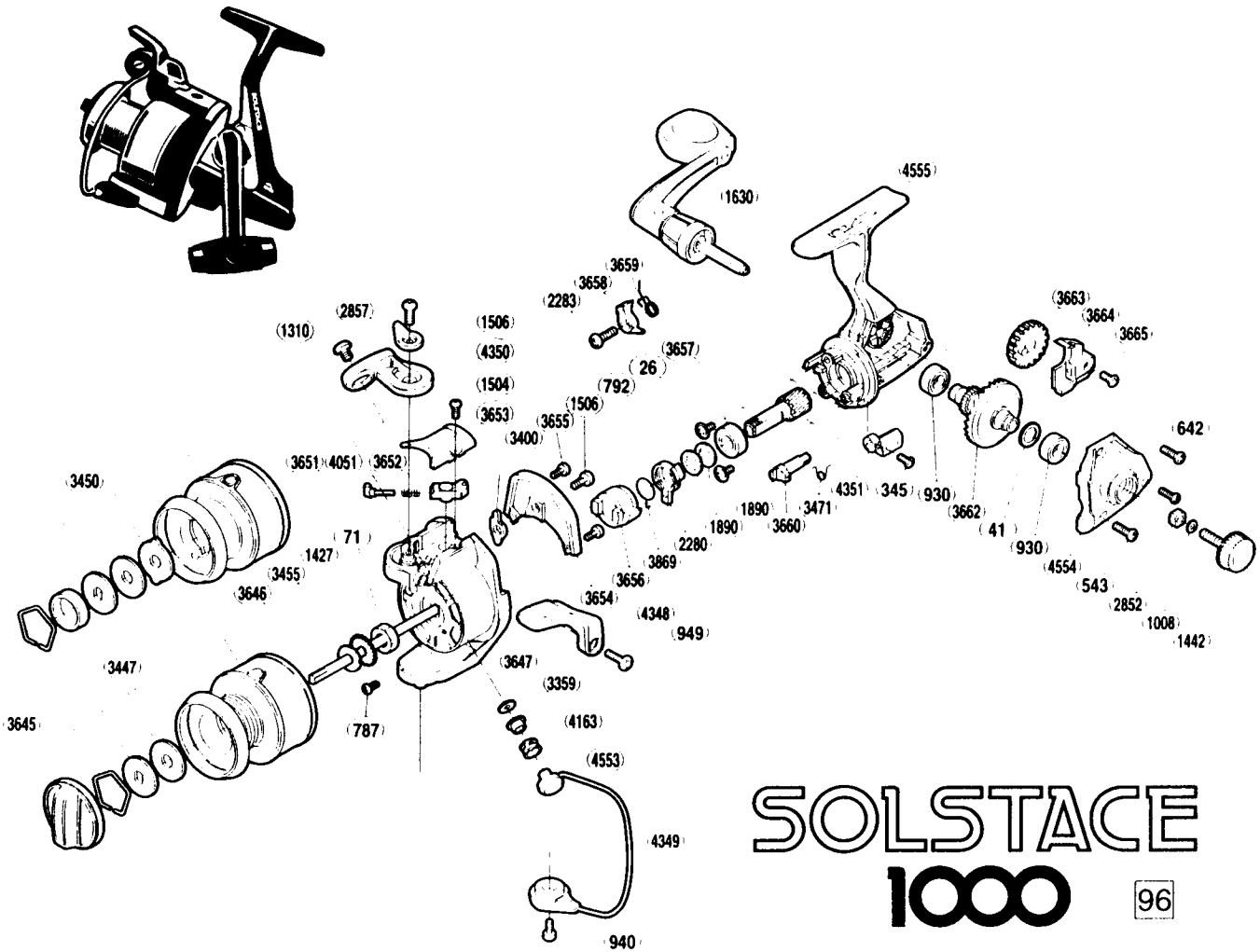

SOLSTACE

1000

96

SO1000FA

| Part # | Description | Part # | Description | Part # | Description |
|---------|---------------------------|---------|---------------------------|---------|------------------------------|
| RD 0026 | Ball Bearing | RD 2280 | Anti-Reverse Lock Out | RD 3657 | Pinion Gear |
| RD 0041 | Drive Gear Washer | RD 2283 | Anti-Reverse Pawl Screw | RD 3658 | Anti-Reverse Pawl |
| RD 0071 | Rotor Nut | RD 2852 | Handle Screw Lock | RD 3659 | Anti-Reverse Pawl Spring |
| RD 0345 | Anti-Reverse Lever Screw | RD 2857 | Trigger Cam | RD 3660 | Anti-Reverse Cam |
| RD 0543 | Side Cover Screw (black) | RD 3359 | Line Roller Washer | RD 3662 | Drive Gear |
| RD 0642 | Side Cover Screw (silver) | RD 3400 | Bail Trip Lever | RD 3663 | Oscillating Gear |
| RD 0787 | Nut Lock Screw | RD 3447 | Spool Assembly (aluminum) | RD 3664 | Oscillating Slider |
| RD 0792 | Bearing Retainer Screw | RD 3450 | Spool Assembly (graphite) | RD 3665 | Slider Retainer Screw |
| RD 0930 | Ball Bearing | RD 3455 | Spool Washer | RD 3869 | Anti-Reverse Lock Out Spring |
| RD 0940 | Bail Hold Support Screw | RD 3471 | Anti-Reverse Cam Spring | RD 4051 | Bail Spring |
| RD 0949 | Trigger Screw | RD 3645 | Drag Knob | RD 4163 | Line Roller Bushing |
| RD 1008 | Handle Lock Washer | RD 3646 | Main Shaft | RD 4348 | Quick-Fire II Trigger |
| RD 1310 | Line Roller Screw | RD 3647 | Rotor | RD 4349 | Bail Assembly |
| RD 1427 | Spool Support | RD 3651 | Bail Spring Guide (A) | RD 4350 | Bail Arm |
| RD 1442 | Handle Screw Cap | RD 3652 | Bail Spring Guide (B) | RD 4351 | Anti-Reverse Lever |
| RD 1504 | Bail Spring Cover Screw | RD 3653 | Bail Spring Cover | RD 4553 | Line Roller (Power) |
| RD 1506 | Multi Purpose Screw | RD 3654 | Counterbalance Cover | RD 4554 | Side Cover |
| RD 1630 | Handle Assembly | RD 3655 | Cover Screw | RD 4555 | Body |
| RD 1890 | Bushing Washer | RD 3656 | Anti-Reverse Ratchet | | |