

SHIMANO[®]

1988 REPAIR MANUAL

Shimano American Corporation, One Shimano Dr.
Irvine, CA 92718

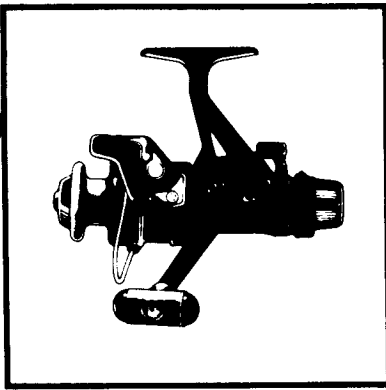

EXPLODED PARTS VIEW

Speed Master CX3000SS

with *Fightin Star*

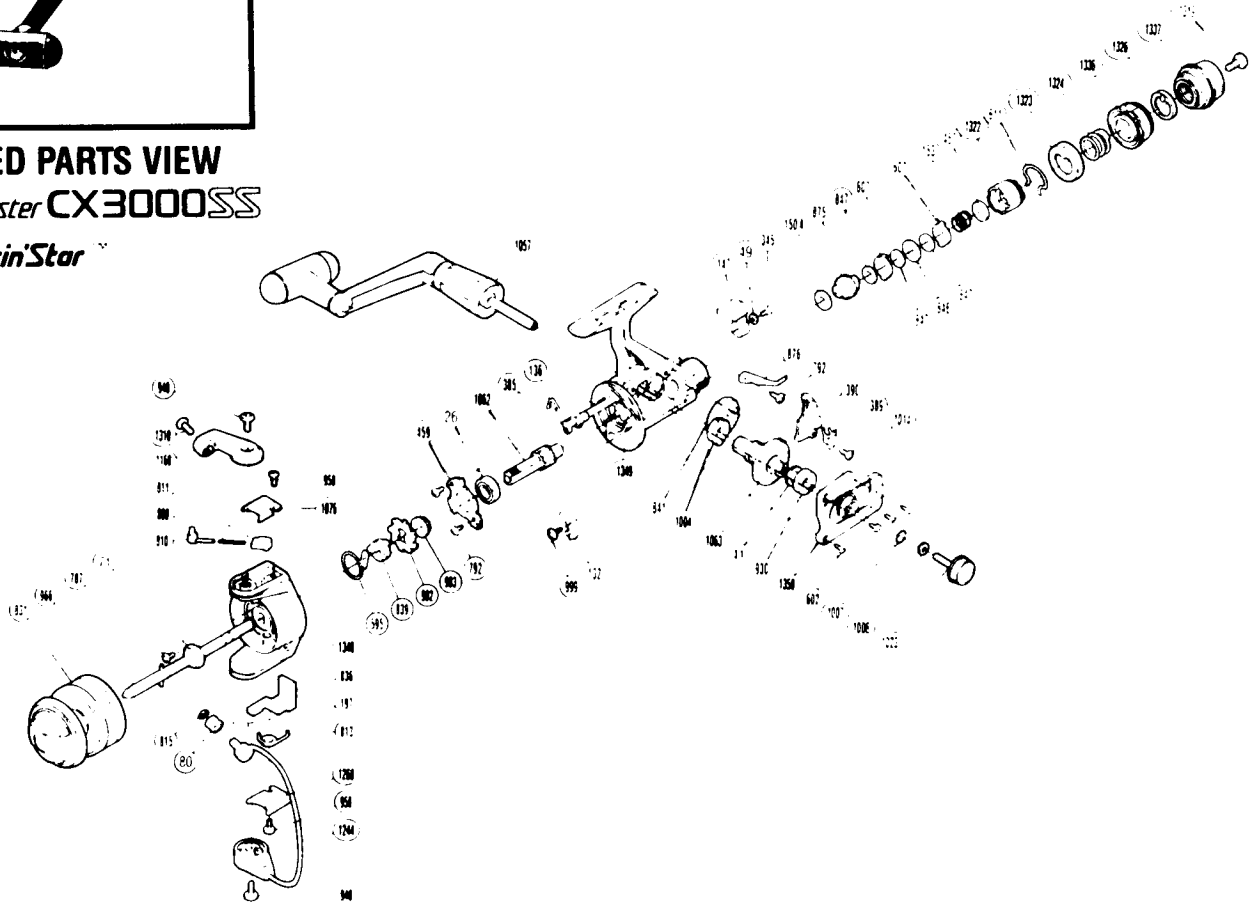

PARTS LIST

PART # DESCRIPTION

| | |
|----------|-----------------------------|
| RD 0026 | Ball Bearing |
| RD 0041 | Drive Gear Washer |
| RD 0049 | Lock Washer |
| RD 0071 | Rotor Nut |
| RD 0132 | Anti-Reverse Pawl Assembly |
| RD 0136 | Anti-Reverse Cam Spring |
| RD 0147 | Anti-Reverse Lever |
| RD 0150A | Drag Washer "C2" (White) |
| RD 0153 | Drag (Coil) Spring |
| RD 0197 | Bail Trip Slide Cam |
| RD 0345 | Anti-Reverse Lever Screw |
| RD 0385 | Anti-Reverse Cam |
| RD 0389 | Oscillating Slider Retainer |
| RD 0390 | Oscillating Slider |
| RD 0457 | Drag Spring Washer "A" |
| RD 0459 | Bearing Retainer |
| RD 0595 | Anti-Reverse Pawl Spring |
| RD 0602 | Side Cover Screw A |
| RD 0607 | Eared Washer "B" |
| RD 0611 | Hold Click Spring |
| RD 0787 | Nut Lock Screw |
| RD 0792 | Bearing Retainer Screw |

PART # DESCRIPTION

| | |
|---------|----------------------------|
| RD 0808 | Bail Spring |
| RD 0810 | Bail Spring Guide A |
| RD 0811 | Bail Spring Guide B |
| RD 0813 | Lever Spring |
| RD 0815 | Line Roller Washer |
| RD 0831 | Spool Assembly (Universal) |
| RD 0836 | Bail Trip Lever |
| RD 0839 | Anti-Reverse Spring Holder |
| RD 0841 | Oscillating Gear |
| RD 0846 | Key Washer "A" |
| RD 0847 | Drag Washer "H1" |
| RD 0875 | Drag Shaft |
| RD 0876 | Drag Click |
| RD 0902 | Anti-Reverse Ratchet |
| RD 0903 | Pinion Spacer |
| RD 0930 | Ball Bearing |
| RD 0940 | Bail Trip Cam Screw |
| RD 0958 | Bail Trip Cover Screw |
| RD 0966 | Main Shaft |
| RD 0999 | Anti-Reverse Pawl Screw |
| RD 1004 | Bushing A |
| RD 1007 | Lock Washer Retainer |

PART # DESCRIPTION

| | |
|---------|-----------------------|
| RD 1008 | Handle Lock Washer |
| RD 1014 | Slider Retainer Screw |
| RD 1023 | Handle Screw Cap |
| RD 1046 | Sic Ceramic Roller |
| RD 1057 | Handle Assembly |
| RD 1062 | Pinion Gear |
| RD 1063 | Drive Gear |
| RD 1076 | Bail Spring Cover |
| RD 1160 | Bail Arm |
| RD 1244 | Bail Assembly |
| RD 1268 | Bail Trip Cover |
| RD 1310 | Line Roller Screw |
| RD 1319 | Drag Knob Screw |
| RD 1322 | Pressure Screw |
| RD 1323 | Pre-Set Spring Cover |
| RD 1324 | Pre-Set Spring |
| RD 1326 | Pre-Set Cam |
| RD 1336 | Pre-Set Ring |
| RD 1337 | Drag Knob |
| RD 1348 | Rotor |
| RD 1349 | Body |
| RD 1350 | Side Cover |