

# SHIMANO®

## 1987 REPAIR MANUAL

Shimano American Corporation, One Shimano Dr.  
Irvine, CA 92718

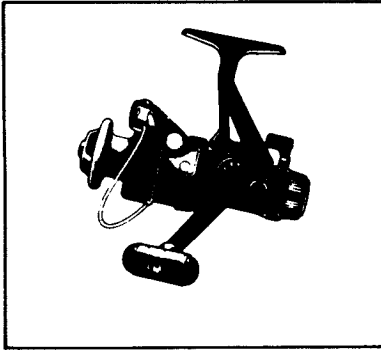

### TO ORDER:

This reel belongs to the "Rear Drag" series.  
Please order parts using the abbreviation  
"RD" and the part number.

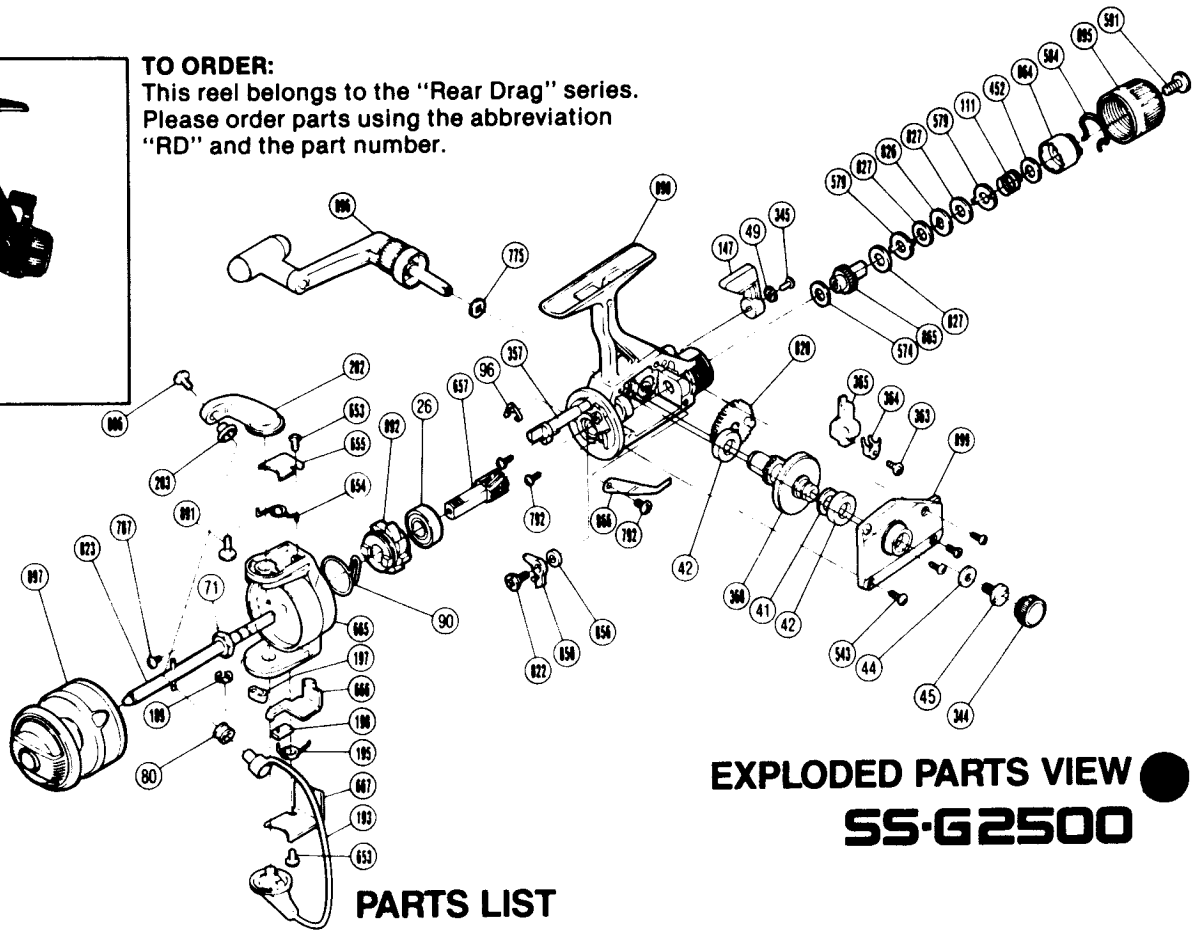

## EXPLODED PARTS VIEW SS-G2500

### PARTS LIST

#### PART # DESCRIPTION

- 26. Ball Bearing
- 41. Drive Gear Washer
- 42. Bushing
- 44. Handle Lock Washer
- 45. Handle Lock Screw (Originally 796)
- 49. Lock Washer
- 71. Rotor Nut
- 80. Line Roller
- 90. Anti-Reverse Pawl Spring
- 96. Anti-Reverse Cam Spring
- 111. Drag Coil Spring
- 147. Anti-Reverse Lever
- 189. "E" Lock
- 193. Bail Assembly
- 195. Lever Spring
- 197. Bail Trip Slide Cam
- 198. Trip Lever Guide
- 202. Bail Arm
- 203. Line Roller Washer
- 344. Handle Screw Cap

#### PART # DESCRIPTION

- 345. Anti-Reverse Lever Screw
- 357. Anti-Reverse Cam
- 360. Drive Gear
- 363. Slider Retainer Screw
- 364. Oscillating Slider Retainer
- 365. Oscillating Slider
- 452. Drag Spring Washer "A"
- 543. Side Cover Screw
- 574. Drag Washer "C<sub>2</sub>"
- 579. Eared Washer "B"
- 584. Hold Click Spring
- 591. Drag Knob Screw
- 653. Bail Trip Cover Screw
- 654. Bail Spring
- 655. Bail Spring Cover
- 657. Pinion Gear
- 665. Rotor
- 666. Bail Trip Lever
- 667. Bail Trip Cover
- 775. Handle Lock Spacer

#### PART # DESCRIPTION

- 787. Nut Lock Screw
- 792. Multi Purpose Screw
- 806. Line Roller Screw
- 820. Oscillating Gear
- 822. Anti-Reverse Pawl Spring
- 823. Main Shaft
- 826. Key Washer "A"
- 827. Drag Washer "H,"
- 850. Anti-Reverse Pawl
- 856. Anti-Reverse Pawl Spacer
- 864. Pressure Screw
- 865. Drag Shaft
- 866. Drag Click
- 891. Bail Arm Screw
- 892. Anti-Reverse Ratchet
- 895. Drag Knob
- 896. Handle Assembly
- 897. Spool Assembly (Universal)
- 898. Body
- 899. Side Cover