

# SHIMANO®

## 1987 REPAIR MANUAL

Shimano American Corporation, One Shimano Dr.  
Irvine, CA 92718

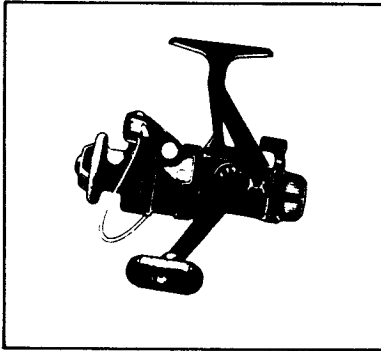

**TO ORDER:**  
This reel belongs to the "Rear Drag" series.  
Please order parts using the abbreviation  
"RD" and the part number.

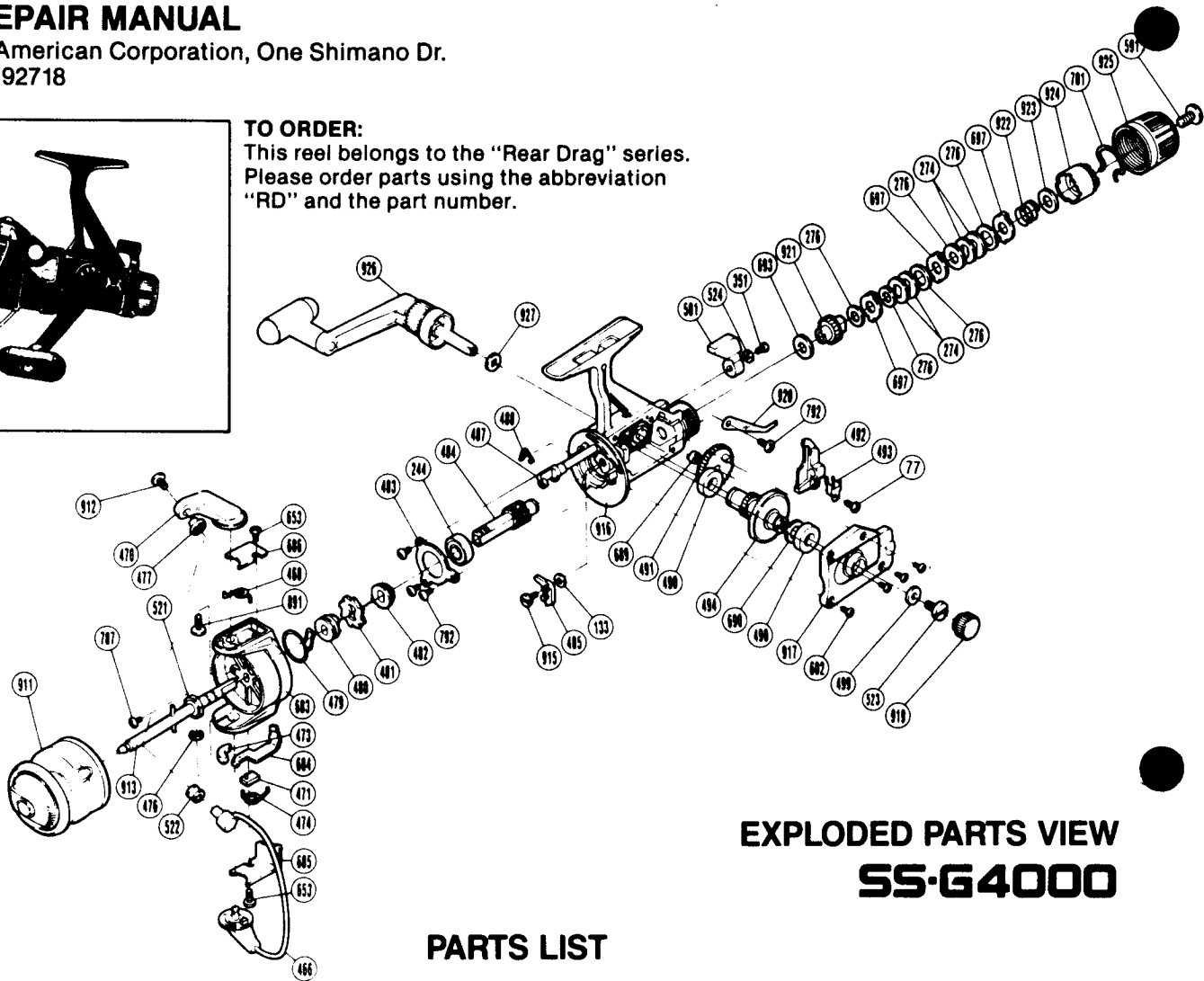

## EXPLODED PARTS VIEW SS-G4000

### PARTS LIST

#### PART # DESCRIPTION

77. Slider Retainer Screw  
133. Anti-Reverse Pawl Spacer  
244. Ball Bearing  
274. Key Washer "A"  
276. Drag Washer "C<sub>1</sub>"  
351. Anti-Reverse Lever Screw  
466. Bail Assembly  
468. Bail Spring  
470. Bail Arm  
471. Trip Lever Guide  
473. Bail Trip Slide Cam  
474. Lever Spring  
476. "E" Lock  
477. Line Roller Washer  
479. Anti-Reverse Pawl Spring  
480. Anti-Reverse Spring Holder  
481. Anti-Reverse Ratchet  
482. Pinion Spacer A  
483. Bearing Retainer  
484. Pinion Gear  
485. Anti-Reverse Pawl  
487. Anti-Reverse Cam

#### PART # DESCRIPTION

488. Anti-Reverse Cam Spring  
490. Bushing  
491. Oscillating Gear  
492. Oscillating Slider  
493. Oscillating Slider Retainer  
494. Drive Gear  
499. Handle Lock Washer  
501. Anti-Reverse Lever  
521. Rotor Nut  
522. Line Roller  
523. Handle Lock Screw  
524. Lock Washer  
591. Drag Knob Screw  
602. Side Cover Screw  
653. Bail Trip Cover Screw  
683. Rotor  
684. Bail Trip Lever  
685. Bail Trip Cover  
686. Bail Spring Cover  
689. Oscillating Gear Bushing  
690. Drive Gear Washer

#### PART # DESCRIPTION

693. Drag Washer "C<sub>2</sub>"  
697. Eared Washer "B"  
701. Hold Click Spring  
787. Nut Lock Screw  
792. Multi Purpose Screw  
891. Bail Arm Screw  
911. Spool Assembly(Universal)  
912. Line Roller Screw  
913. Main Shaft  
915. Anti-Reverse Pawl Screw  
916. Body  
917. Side Cover  
919. Handle Screw Cap  
920. Drag Click  
921. Drag Shaft  
922. Drag Coil Spring  
923. Drag Spring Washer "A"  
924. Pressure Screw  
925. Drag Knob  
926. Handle Assembly  
927. Handle Lock Spacer