

Exploded View

SHIMANO

DYNA-BALANCE

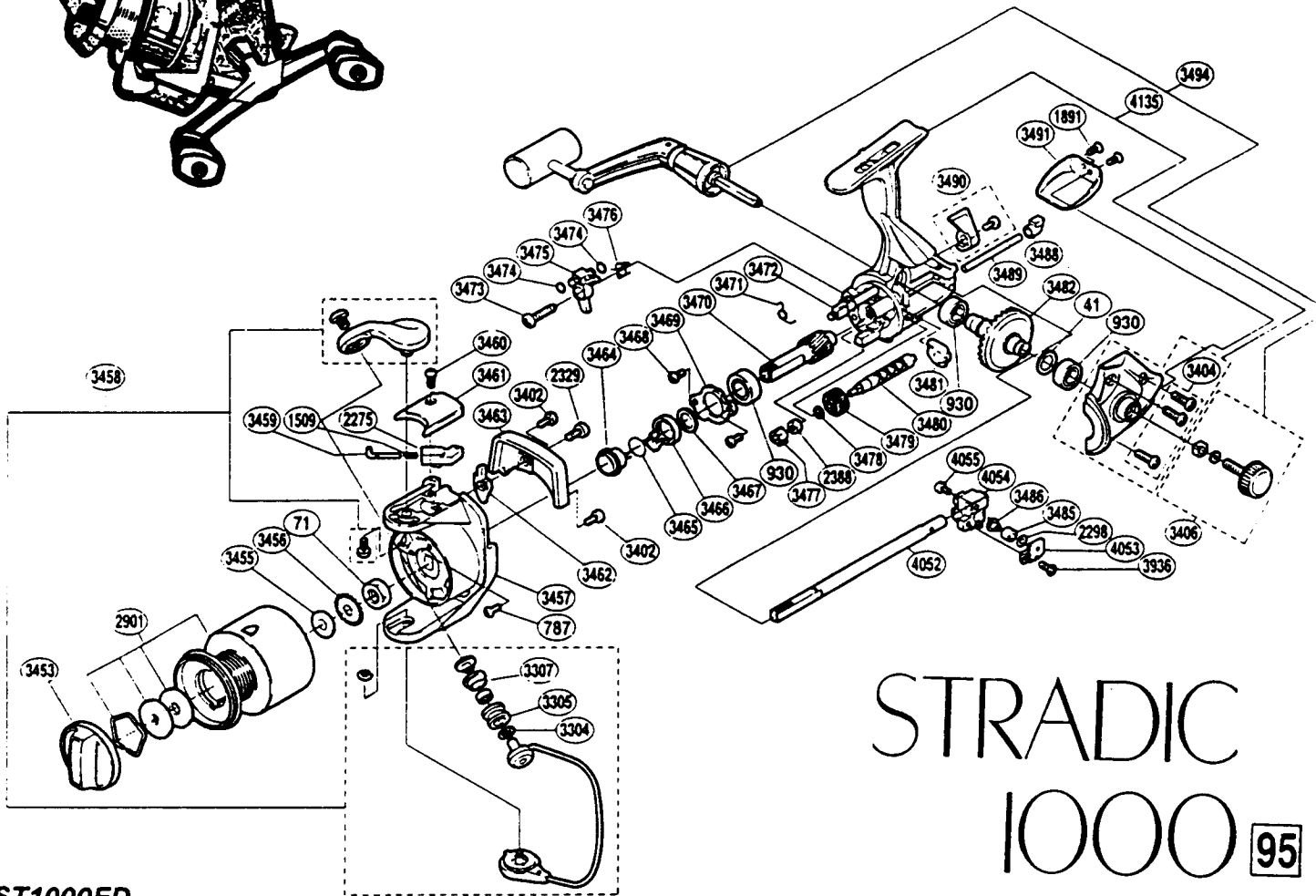

STRADIC 1000 95

ST1000FD

Part #	Description	Part #	Description	Part #	Description
RD 0041	Drive Gear Washer	RD 3457	Rotor	RD 3477	Worm Bearing
RD 0071	Rotor Nut	RD 3458	Bail Assembly	RD 3478	Worm Shaft Spacer
RD 0787	Nut Lock Screw	RD 3459	Bail Spring Guide (A)	RD 3479	Idle Gear
RD 0930	Ball Bearing	RD 3460	Bail Spring Cover Screw	RD 3480	Worm Shaft
RD 1509	Bail Spring	RD 3461	Bail Spring Cover	RD 3481	Bushing
RD 1891	Rear Protector Screw	RD 3462	Bail Trip Lever	RD 3482	Drive Gear
RD 2275	Bail Spring Guide (B)	RD 3463	Counterbalance Cover	RD 3485	Oscillating Slider Bushing
RD 2298	Spacer	RD 3464	Lock Out Spring Holder	RD 3486	Oscillating Pawl
RD 2329	Bail Trip Lever Screw	RD 3465	Anti-Reverse Lock Out Spring	RD 3488	Oscillating Guide Holder
RD 2388	Ball Bearing	RD 3466	Anti-Reverse Lock Out	RD 3489	Oscillating Guide
RD 2901	Spool Assembly	RD 3467	Bushing Washer	RD 3490	Anti-Reverse Lever Assembly
RD 3304	Bearing Spacer	RD 3468	Bearing Retainer Screw	RD 3491	Rear Protector
RD 3305	SIC Ceramic Roller	RD 3469	Bearing Retainer	RD 3494	Handle Assembly
RD 3307	Line Roller Bushing	RD 3470	Pinion Gear	RD 3936	Oscillating Pawl Cover Screw
RD 3402	Cover Screw	RD 3471	Anti-Reverse Cam Spring	RD 4052	Main Shaft
RD 3404	Side Cover Screw	RD 3472	Anti-Reverse Cam	RD 4053	Oscillating Pawl Cover
RD 3406	Handle Screw Cap Assembly	RD 3473	Anti-Reverse Pawl Spring	RD 4054	Oscillating Slider
RD 3453	Drag Knob	RD 3474	"O" Ring	RD 4055	Slider Retainer Screw
RD 3455	Spool Washer	RD 3475	Anti-Reverse Pawl	RD 4135	Body Assembly
RD 3456	Spool Support	RD 3476	Anti-Reverse Pawl Spring		