

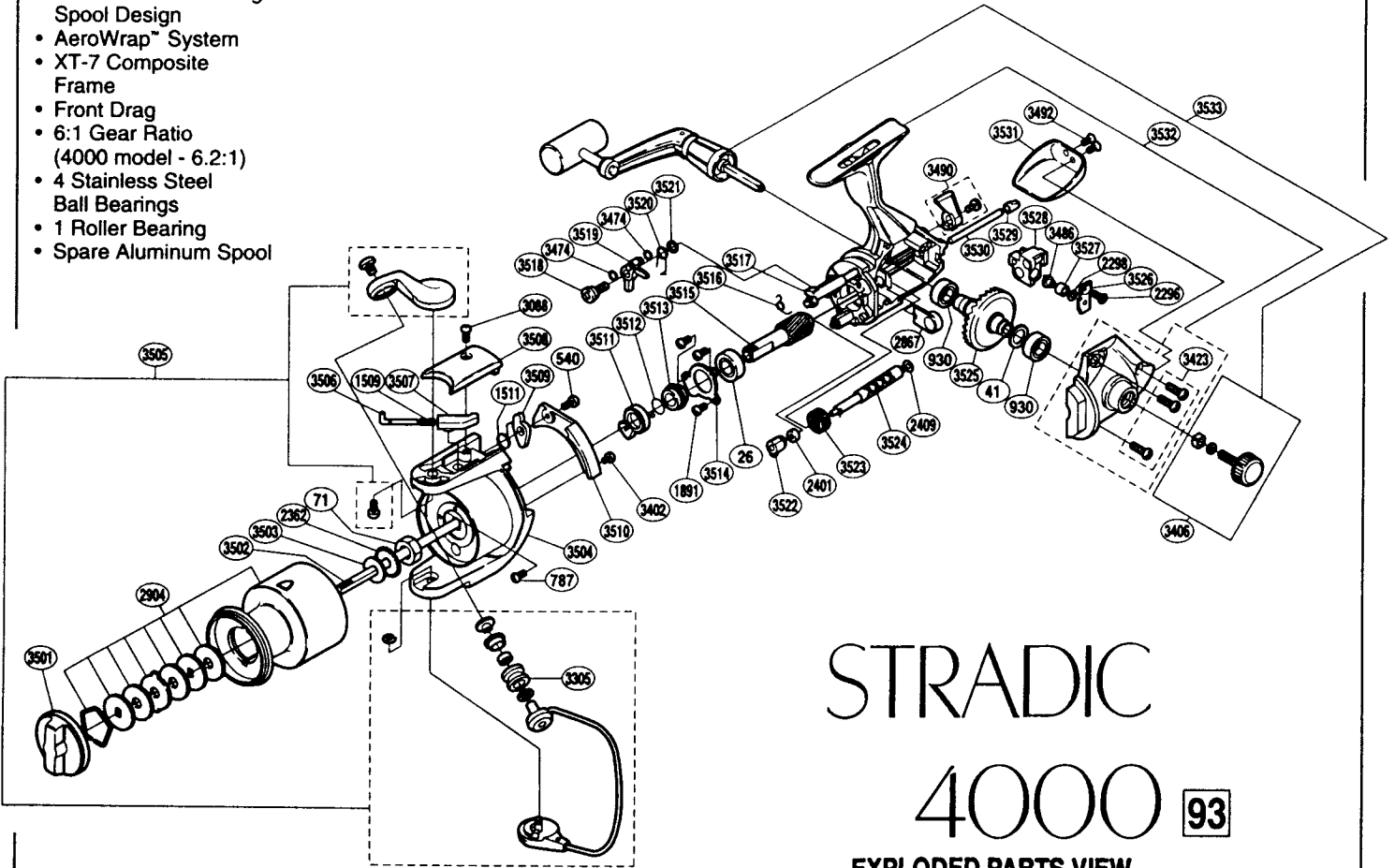

**AERO®STRADIC™**  
Spinning Reels

**Stratoradical**

- **Dyna-Balance**
- Super Stopper Anti-Reverse
- Aluminum Aero® Long Spool Design
- AeroWrap™ System
- XT-7 Composite Frame
- Front Drag
- 6:1 Gear Ratio (4000 model - 6.2:1)
- 4 Stainless Steel Ball Bearings
- 1 Roller Bearing
- Spare Aluminum Spool



# STRADIC 4000 93

**EXPLODED PARTS VIEW**

MODEL NO.	LINE / CAPACITY	GEAR RATIO	WT. (OZ.)	BEARINGS
ST-4000FB	8/240,10/200,12/160	6.2:1	12.0	5

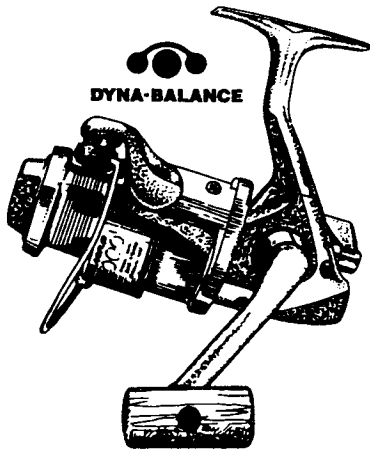

A good thing has just gotten better! Stradic™ has been redesigned. Over the past two years Stradic™ became known for its exceptional smoothness and appearance. If you liked it then, you should really like it now.

How has Stradic™ been so greatly improved? Most prominently, Stradic™ now has DynaBalance™, which eliminates rotor wobble to create the smoothest retrieves you've ever experienced. On appearance, just take a look at Stradic's picture. Hooksets are quicker with the new Super Stopper™ anti-reverse. Not changing - Stradic™ still features a spare aluminum spool, AeroWrap™, an oversized ball bearing roller line guide, and fast gear ratios.