

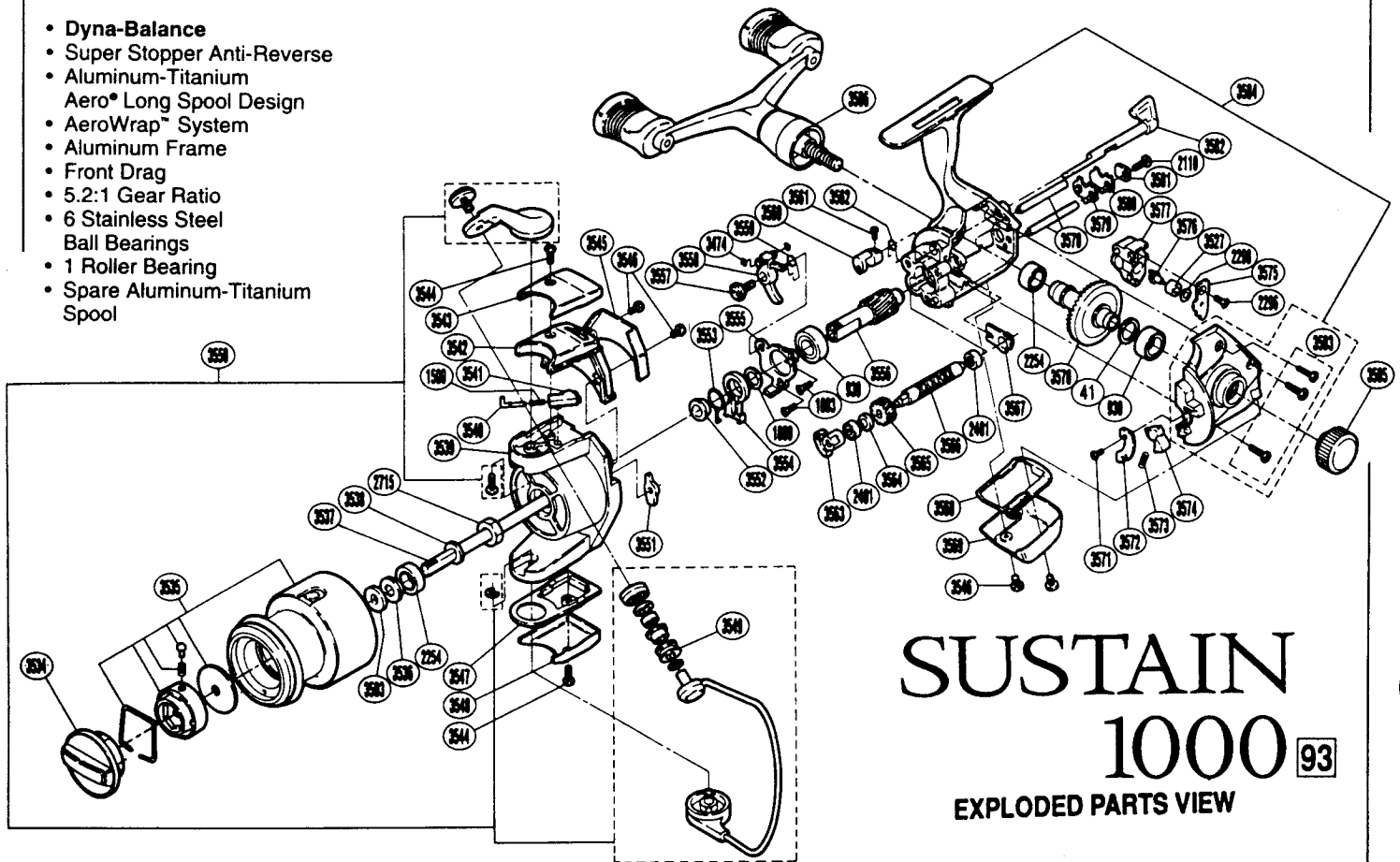

AERO® SUSTAIN™
Spinning Reels

Greatest Spinning
Reel on Earth

- Dyna-Balance
- Super Stopper Anti-Reverse
- Aluminum-Titanium Aero® Long Spool Design
- AeroWrap™ System
- Aluminum Frame
- Front Drag
- 5.2:1 Gear Ratio
- 6 Stainless Steel Ball Bearings
- 1 Roller Bearing
- Spare Aluminum-Titanium Spool



SUSTAIN 1000 93 EXPLODED PARTS VIEW

MODEL NO.	LINE / CAPACITY	GEAR RATIO	WT. (OZ.)	BEARINGS
SA-1000F	2/270,4/140,6/110	5.2:1	7.9	7

No holds were barred when we set out to make this reel. We stretched our minds and manufacturing capabilities to the limit to make the best operating reel possible. The result is Sustain™, which has unsurpassed levels of precision, smoothness and durability. The price tag is high, but for the connoisseur who's looking for the ultimate, the search is over.

Precision - Cold forging, a process where aluminum is pounded into shape with incredibly heavy amounts of weight, is used to make the tapered aluminum spools, drive gear, pinion and idle gears. Cold forged parts are extremely strong since the parts are not stressed by heat and they can be made to extremely tight tolerances. Sustain's body, rotor and side cover are made from die-cast aluminum for strength and lightness. The precision fit between these parts makes Sustain™ run like a fine Swiss watch.

Smoothness - 7 (8 - 4000 size) ball bearings support all stress points and ensure exceptionally smooth retrieves. Lightweight titanium is used on the spool lip, oversized ball bearing line roller guide, and the bail wire. This low-friction material lets line pass without resistance and wear. AeroWrap™ creates a two-speed spool oscillation via a worm gear to lay the line on the spool in an even pattern. This pattern minimizes line-to-line friction on the cast to create smoother, further casts. Last, but not least, DynaBalance™ with a double paddle handle eliminates rotor wobble for the smoothest retrieve you've ever felt.

Durability - All the materials used to make Sustain™ so precise and smooth have the double effect of also making the reel very durable. It doesn't stop here, however, the Super Stopper™ anti-reverse system reduces handle backplay and the wear resulting from this backplay. A stainless steel rotor protector and rear housing aprons protect the reel. Finally, Sustain™ comes with a cloth reel bag to protect it when it's not in use.

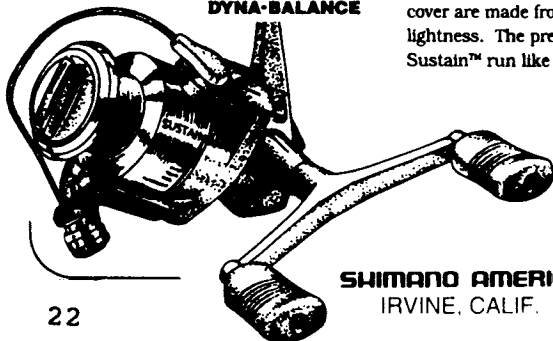

SHIMANO AMERICAN CORPORATION ONE SHIMANO DR., P.O. BOX 19615
IRVINE, CALIF. 92713-9615 PHONE: 714-951-5003 FAX: 714-951-6212