

# ISYMETRE

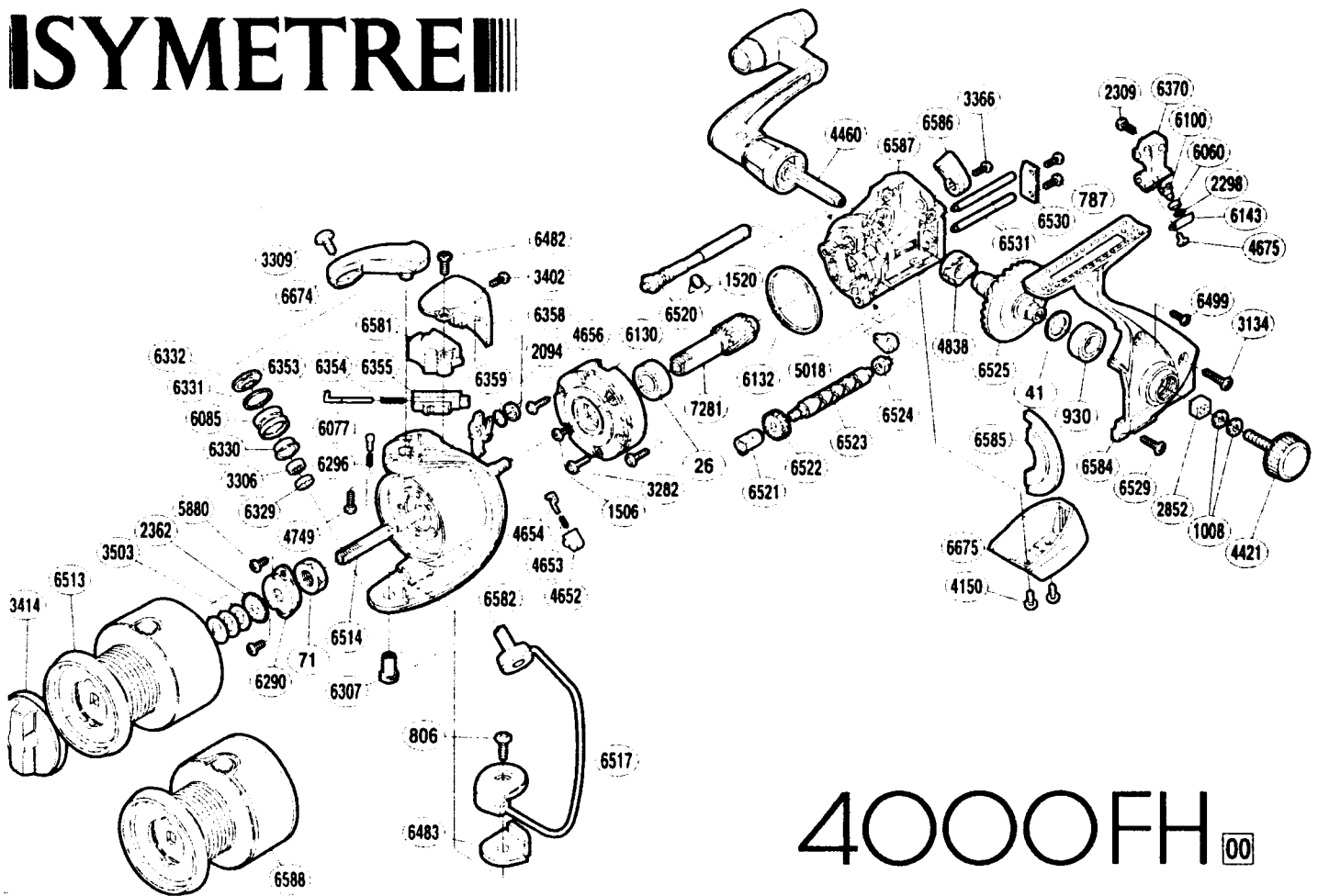

## 4000FH 00

RD No.	PARTS NAMES	RD No.	PARTS NAMES	RD No.	PARTS NAMES
0026	Ball Bearing	4654	Lever Spring Guide (A)	6482	Protector Screw (large)
0041	Drive Gear Washer	4656	Trip Lever Spacer	6483	Bail Hold Support Spacer
0071	Rotor Nut	4675	Oscillating Pawl Cover Screw	6499	Side Cover Screw (small)
0787	Worm Shaft Retainer Screw	4749	Bail Arm Screw	6513	Spool Assembly (aluminum)
0806	Bail Hold Support Screw	4838	Drive Gear Bushing	6514	Main Shaft
0930	Ball Bearing	5018	Bushing	6517	Bail Assembly
1008	Handle Lock Washer	5880	Nut Lock Screw	6520	Anti-Reverse Cam
1506	Clutch Cover Screw	6060	Oscillating Slider Bushing	6521	Worm Bushing (front)
1520	Anti-Reverse Cam Spring	6077	Click Pin	6522	Idle Gear
2094	Spacer	6085	Line Roller	6523	Worm Shaft
2298	Spacer	6100	Oscillating Pawl	6524	Worm Bushing (rear)
2309	Slider Retainer Screw	6130	Roller Clutch Assembly	6525	Drive Gear
2362	Spool Support	6132	Friction Ring	6529	Side Cover Screw (medium)
2852	Handle Screw Lock	6143	Oscillating Pawl Cover	6530	Worm Shaft Retainer
3134	Side Cover Screw (long)	6290	Rotor Nut Lock Plate	6531	Oscillating Guide
3282	Roller Clutch Screw	6296	Click Spring	6581	Bail Spring Cover
3306	Ball Bearing	6307	Bail Hold Support Shaft	6582	Rotor
3309	Line Roller Screw	6329	Bearing Spacer	6584	Side Cover
3366	Anti-Reverse Lever Screw	6330	Line Roller Bushing	6585	Side Cover Flange
3402	Protector Screw (small)	6331	Line Roller Spacer	6586	Anti-Reverse Lever
3414	Drag Knob	6332	Line Roller Washer	6587	Body
3503	Spool Washer	6353	Bail Spring Guide (A)	6588	Spool Assembly (graphite)
4150	Rear Protector Screw	6354	Bail Spring	6674	Bail Arm
4421	Handle Screw Cap	6355	Bail Spring Guide (B)	6675	Rear Protector
4460	Handle Assembly	6358	Rotor Protector	7281	Pinion Gear
4652	Lever Spring Guide (B)	6359	Bail Trip Lever		
4653	Lever Spring	6370	Oscillating Slider		