

# SHIMANO®

## 1994 REPAIR MANUAL

Shimano American Corporation, One Shimano Dr.  
Irvine, CA 92718

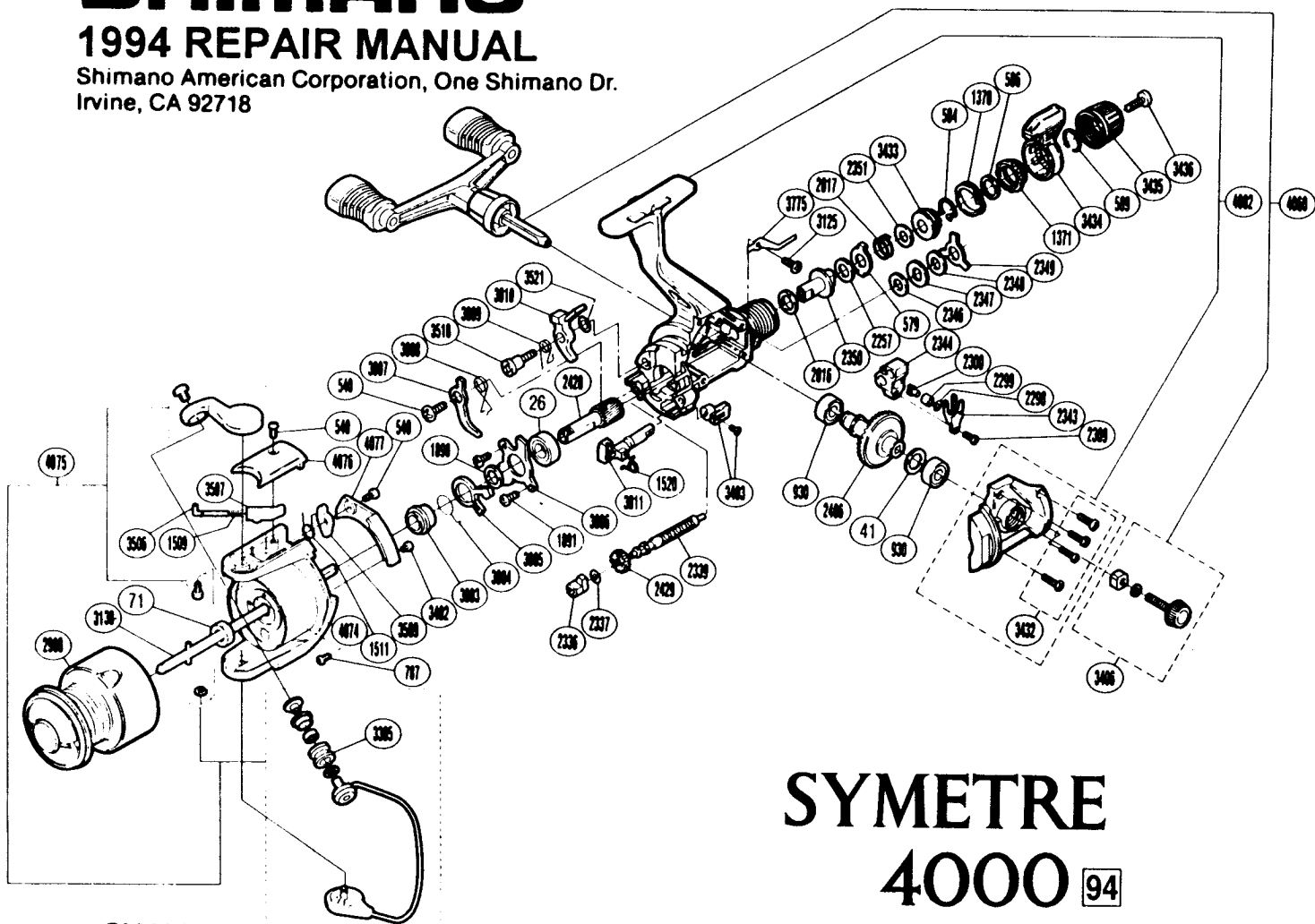

**SY4000RB**

# SYMETRE 4000 94

| PART #  | DESCRIPTION                    | PART #  | DESCRIPTION                 | PART #  | DESCRIPTION                   |
|---------|--------------------------------|---------|-----------------------------|---------|-------------------------------|
| RD 0026 | Ball Bearing                   | RD 2337 | Worm Shaft Spacer           | RD 3434 | Fightin' Drag II Lever        |
| RD 0041 | Drive Gear Washer              | RD 2339 | Worm Shaft                  | RD 3435 | Drag Programmer               |
| RD 0071 | Rotor Nut                      | RD 2343 | Oscillating Slider Retainer | RD 3436 | Drag Programmer Screw         |
| RD 0540 | Multi Purpose Screw            | RD 2344 | Oscillating Slider          | RD 3506 | Bail Spring Guide (A)         |
| RD 0579 | Eared Washer "B"               | RD 2346 | Drag Washer "C2" (white)    | RD 3507 | Bail Spring Guide (B)         |
| RD 0584 | Hold Click Spring              | RD 2347 | Click Gear                  | RD 3509 | Bail Trip Lever               |
| RD 0586 | Fightin' Pressure Screw Washer | RD 2348 | Drag Washer "C1"            | RD 3518 | Anti-reverse Pawl Screw       |
| RD 0589 | Lever Hold Spring              | RD 2349 | Eared Washer "BF"           | RD 3521 | Anti-reverse Pawl Spacer      |
| RD 0787 | Nut Lock Screw                 | RD 2350 | Drag Shaft                  | RD 3775 | Drag Click                    |
| RD 0930 | Ball Bearing                   | RD 2351 | Drag Spring Washer          | RD 3803 | Lock Out Spring Holder        |
| RD 1370 | Lever Click Gear               | RD 2406 | Drive Gear                  | RD 3804 | Anti-reverse Lock Out Spring  |
| RD 1371 | Fightin' Pressure Screw        | RD 2428 | Pinion Gear                 | RD 3805 | Anti-reverse Lock Out         |
| RD 1509 | Bail Spring                    | RD 2429 | Idle Gear                   | RD 3806 | Bearing Retainer              |
| RD 1511 | Lever Spring                   | RD 2908 | Spool Assembly              | RD 3807 | Anti-reverse Cam (B)          |
| RD 1520 | Anti-Reverse Cam Spring        | RD 3125 | Drag Click Screw            | RD 3808 | Anti-reverse Cam (B) Spring   |
| RD 1890 | Bushing Washer                 | RD 3130 | Main Shaft                  | RD 3809 | Anti-reverse Pawl Spring      |
| RD 1891 | Bearing Retainer Screw         | RD 3304 | Bearing Spacer              | RD 3810 | Anti-reverse Pawl             |
| RD 2016 | Drag Washer "H2" (white)       | RD 3305 | SiC Ceramic Roller          | RD 3811 | Anti-reverse Cam (A)          |
| RD 2017 | Drag Coil Spring               | RD 3307 | Line Roller Bushing         | RD 4060 | Double Paddle Handle Assembly |
| RD 2257 | Drag Washer "H1"               | RD 3402 | Cover Screw                 | RD 4074 | Rotor                         |
| RD 2298 | Spacer                         | RD 3403 | Anti-Reverse Lever Assembly | RD 4075 | Bail Assembly                 |
| RD 2299 | Oscillating Slider Bushing     | RD 3406 | Handle Screw Cap Assembly   | RD 4076 | Bail Spring Cover             |
| RD 2300 | Oscillating Pawl               | RD 3432 | Side Cover Screws           | RD 4077 | Counterbalance Cover          |
| RD 2309 | Slider Retainer Screw          | RD 3433 | Pressure Screw Assembly     | RD 4082 | Body Assembly                 |
| RD 2336 | Worm Bearing (front)           |         |                             |         |                               |