

# Exploded View

# SHIMANO

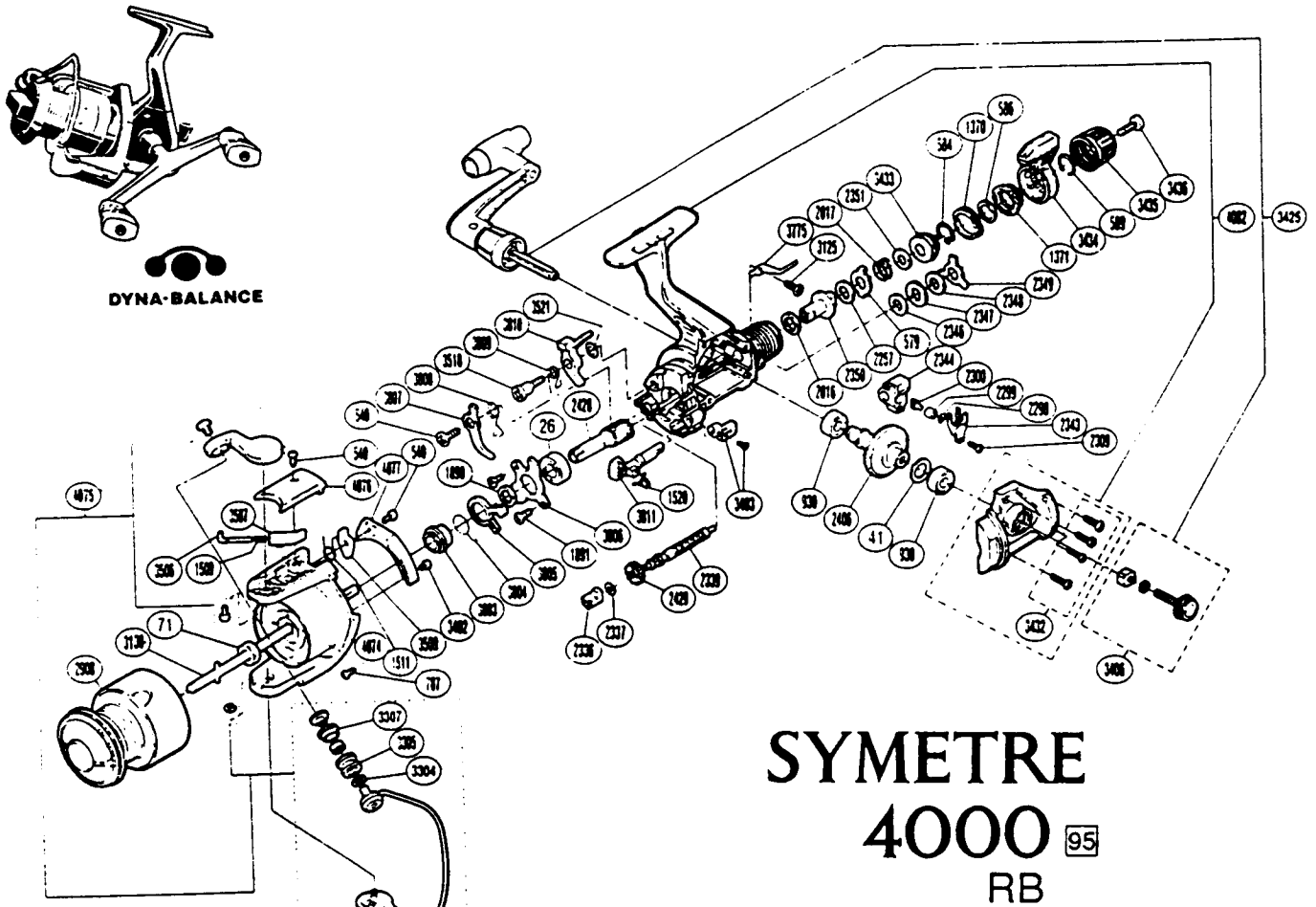

SY4000RB

Part#	Description	Part#	Description	Part #	Description
RD 0026	Ball Bearing	RD 2337	Worm Shaft Spacer	RD 3434	Fightin' Drag II Lever
RD 0041	Drive Gear Washer	RD 2339	Worm Shaft	RD 3435	Drag Programmer
RD 0071	Rotor Nut	RD 2343	Oscillating Slider Retainer	RD 3436	Drag Programmer Screw
RD 0540	Multi Purpose Screw	RD 2344	Oscillating Slider	RD 3506	Bail Spring Guide (A)
RD 0579	Eared Washer "B"	RD 2346	Drag Washer "C2" (white)	RD 3507	Bail Spring Guide (B)
RD 0584	Hold Click Spring	RD 2347	Click Gear	RD 3509	Bail Trip Lever
RD 0586	Fightin' Pressure Screw Washer	RD 2348	Drag Washer "C1"	RD 3518	Anti-Reverse Pawl Screw
RD 0589	Lever Hold Spring	RD 2349	Eared Washer "B"	RD 3521	Anti-Reverse Pawl Spacer
RD 0787	Nut Lock Screw	RD 2350	Drag Shaft	RD 3775	Drag Click
RD 0930	Ball Bearing	RD 2351	Drag Spring Washer	RD 3803	Lock Out Spring Holder
RD 1370	Lever Click Gear	RD 2406	Drive Gear	RD 3804	Anti-Reverse Lock Out Spring
RD 1371	Fightin' Pressure Screw	RD 2428	Pinion Gear	RD 3805	Anti-Reverse Lock Out
RD 1509	Bail Spring	RD 2429	Idle Gear	RD 3806	Bearing Retainer
RD 1511	Lever Spring	RD 2908	Spool Assembly	RD 3807	Anti-Reverse Cam (B)
RD 1520	Anti-Reverse Cam Spring	RD 3125	Drag Click Screw	RD 3808	Anti-Reverse Cam (B) Spring
RD 1890	Bushing Washer	RD 3130	Main Shaft	RD 3809	Anti-Reverse Pawl Spring
RD 1891	Bearing Retainer Screw	RD 3304	Bearing Spacer	RD 3810	Anti-Reverse Pawl
RD 2016	Drag Washer "H2" (white)	RD 3305	SIC Ceramic Roller	RD 3811	Anti-Reverse Cam (A)
RD 2017	Drag Coil Spring	RD 3307	Line Roller Bushing	RD 4074	Rotor
RD 2257	Drag Washer "H1"	RD 3402	Cover Screw	RD 4075	Bail Assembly
RD 2298	Spacer	RD 3403	Anti-Reverse Lever Assembly	RD 4076	Bail Spring Cover
RD 2299	Oscillating Slider Bushing	RD 3406	Handle Screw Cap Assembly	RD 4077	Counterbalance Cover
RD 2300	Oscillating Pawl	RD 3425	Handle Assembly	RD 4082	Body Assembly
RD 2309	Slider Retainer Screw	RD 3432	Side Cover Screws		
RD 2336	Worm Bearing	RD 3433	Pressure Screw Assembly		