

1987 REPAIR MANUAL

Shimano American Corporation, One Shimano Dr.
Irvine, CA 92718

TO ORDER:

This reel belongs to the "Rear Drag" series
Please order parts using the abbreviation
"RD" and the part number.

※ Please look here for "S" mark here
(e.g. 87^S (KB-JAPAN))

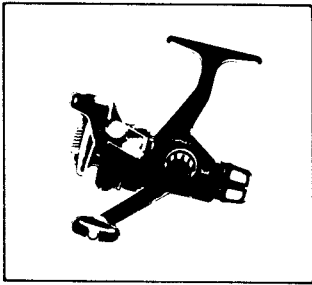

EXPLODED PARTS VIEW

TX110 Plus

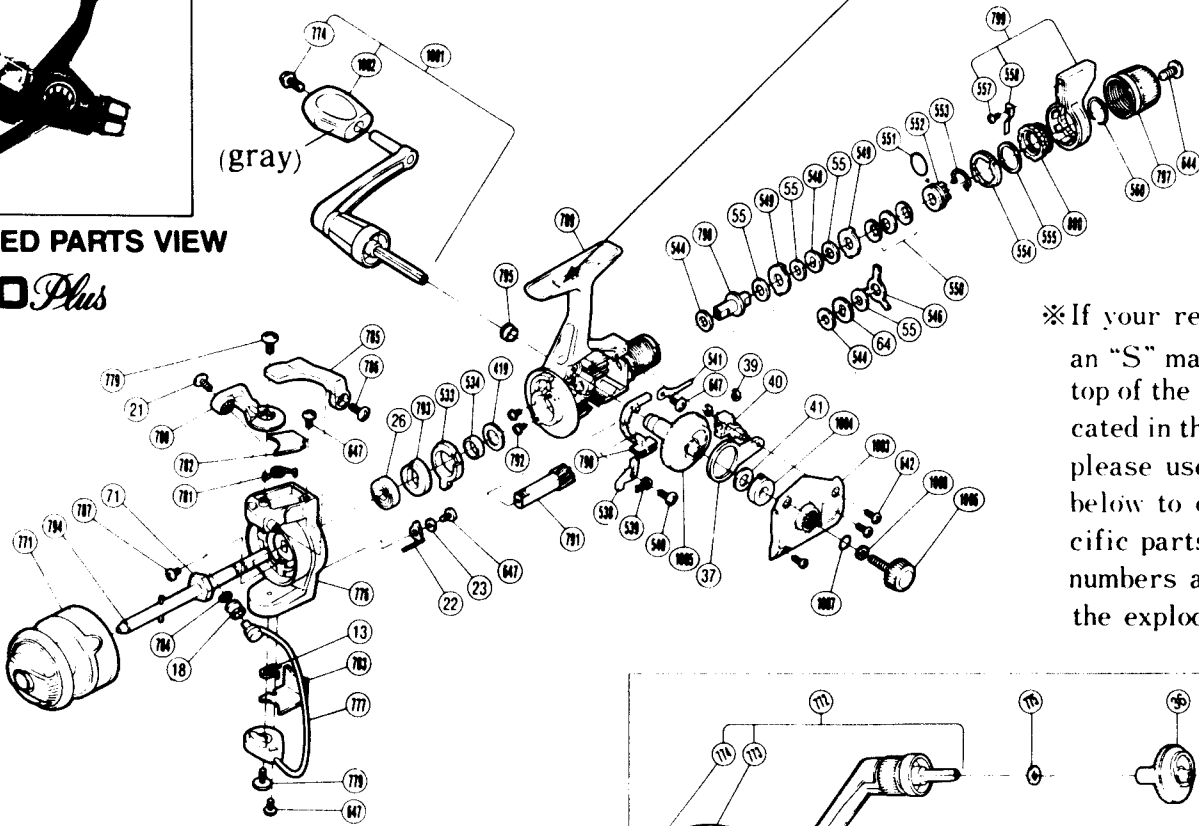

※ If your reel does not have an "S" mark molded on the top of the reel foot as indicated in the exploded view, please use the parts view below to order these specific parts. All other parts numbers are as shown in the exploded view.

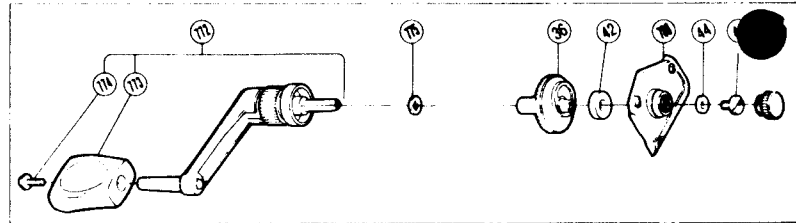

PARTS LIST

PART # DESCRIPTION

13.	Lever Spring
18.	Line Roller
21.	Line Roller Screw (orig. 778)
22.	Bail Trip Lever
23.	Trip Lever Spacer
26.	Ball Bearing
36.	Drive Gear
37.	Oscillating Arm
39.	"C" Lock
40.	Oscillating Block
41.	Drive Gear Washer
42.	Bushing A
44.	Handle Lock Washer
45.	Handle Lock Screw (Originally 796)
46A.	Handle Screw Cap
55.	Drag Washer "C ₁ "
64.	Click Gear
71.	Rotor Nut
419.	Bushing Washer
533.	Anti-Reverse Lock Out
534.	Pinion Spacer
538.	Anti-Reverse Pawl
539.	Anti-Reverse Pawl Spring
540.	Anti-Reverse Pawl Screw
541.	Drag Click
544.	Drag Washer "C ₂ "

PART # DESCRIPTION

546.	Eared Washer "B"
548.	Key Washer "A"
549.	Eared Washer "B"
550.	Coned Disc Springs
551.	"O" Ring
552.	Pressure Screw
553.	Hold Click Spring
554.	Lever Click Gear
555.	Fightin' Pressure Screw Washer
557.	Fightin' Drag Click Screw
558.	Fightin' Drag Click
560.	Lever Hold Spring
642.	Side Cover Screw
644.	Drag Programmer Screw
647.	Multi Purpose Screw
771.	Spool Assembly (Universal)
772.	Handle
773.	Handle Knob
774.	Handle Knob Screw
775.	Handle Lock Spacer
776.	Rotor
777.	Bail Assembly
785.	Quick-Fire II Trigger
786.	Trigger Screw
787.	Nut Lock Screw

PART # DESCRIPTION PRICE

788.	Side Cover	1.25
789.	Body	3.30
790.	Anti-Reverse Switch	.25
791.	Pinion Gear	1.85
792.	Multi Purpose Screw	.15
793.	Anti-Reverse Ratchet	.45
794.	Main Shaft	.90
795.	Bushing B	.25
797.	Drag Programmer	.85
798.	Drag Shaft	.45
799.	Fightin' Drag Lever	.65
800.	Fightin' Pressure Screw	.25
1001.	Handle Assembly ("S" Version)	3.55
1002.	Handle Knob ("S" Version)	.25
1003.	Side Cover ("S" Version)	1.50
1004.	Bushing A ("S" Version)	.35
1005.	Drive Gear ("S" Version)	1.00
1006.	Handle Screw Cap ("S" Version)	.75
1007.	Lock Washer Retainer ("S" Version)	.15
1008.	Handle Lock Washer ("S" Version)	.15

Prices and specifications subject to change without notice.

JUNE 1986