

EXPLODED PARTS VIEW
TX110Q

*Please look here
for (89) mark here

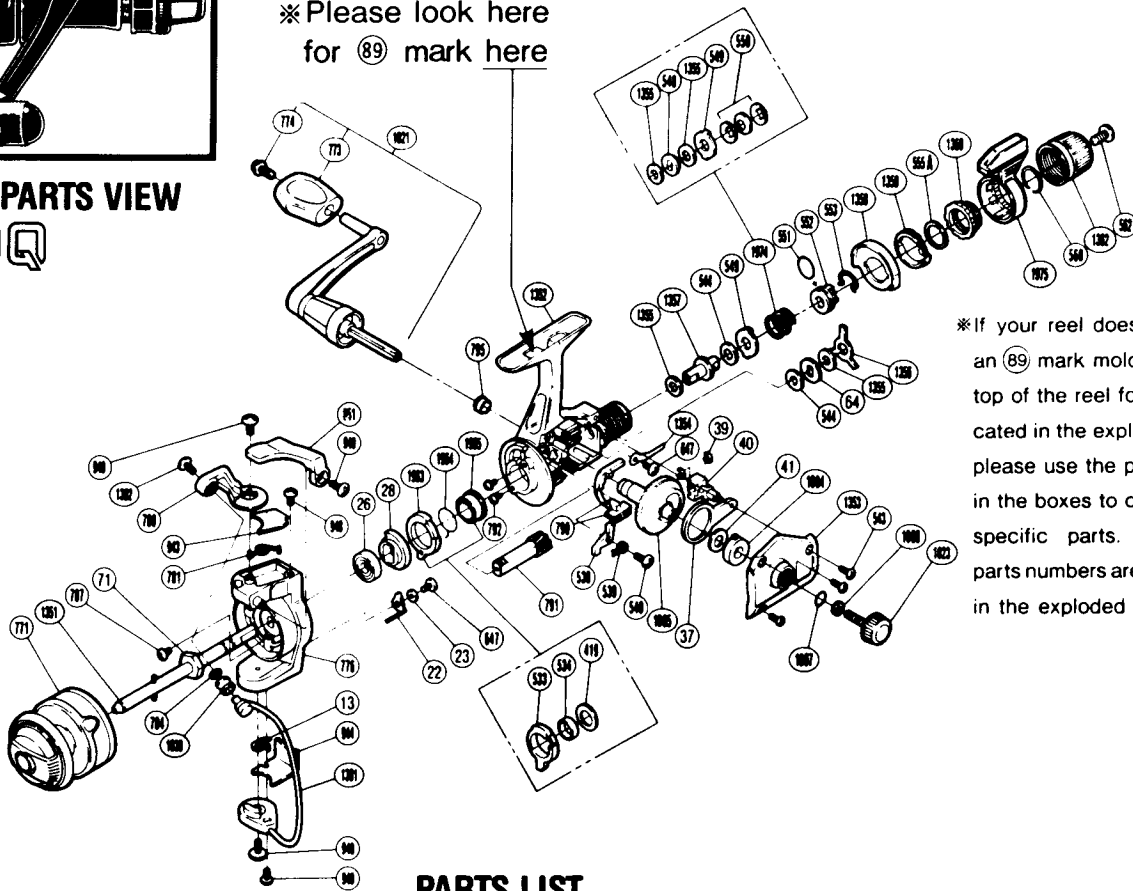

*If your reel does not have an (89) mark molded on the top of the reel foot as indicated in the exploded view, please use the parts views in the boxes to order these specific parts. All other parts numbers are as shown in the exploded view.

PARTS LIST

PART # DESCRIPTION

- RD 0013 (Trip) Lever Spring
- RD 0022 (Bail) Trip Lever
- RD 0023 Trip Lever Spacer
- RD 0026 Ball Bearing
- RD 0028 Anti-Reverse Ratchet
- RD 0037 Oscillating Arm
- RD 0039 "C" Lock
- RD 0040 Oscillating Block
- RD 0041 Drive Gear Washer
- RD 0064 Click Gear
- RD 0071 Rotor Nut
- RD 0419 Bushing Washer (B)
- RD 0533 Anti-Reverse Lock Out
- RD 0534 Pinion Spacer
- RD 0538 Anti-Reverse Pawl
- RD 0539 Anti-Reverse Pawl Spring
- RD 0540 Anti-Reverse Pawl Screw
- RD 0543 Side Cover Screw (B)
- RD 0544 Drag Washer "C2" (White)
- RD 0548 Key Washer "A"
- RD 0549 Eared Washer "B"
- RD 0550 Coned Disc Spring
- RD 0551 "O" Ring
- RD 0552 Pressure Screw
- RD 0553 Hold Click Spring

PART # DESCRIPTION

- RD 0555A Fightin' Pressure Screw Washer
- RD 0560 Lever Hold Spring
- RD 0562 Drag Programmer Screw
- RD 0647 Nut Lock Screw
- RD 0771 Spool Assembly
- RD 0773 Handle Knob
- RD 0774 Handle Knob Screw
- RD 0776 Rotor
- RD 0780 Bail Arm
- RD 0781 Bail Spring
- RD 0784 Line Roller Washer
- RD 0787 Nut Lock Screw
- RD 0790 Anti-Reverse Switch (Black)
- RD 0791 Pinion Gear
- RD 0792 Bearing Retainer Screw
- RD 0795 Bushing B
- RD 0851 Quick-Fire II Trigger
- RD 0940 Bail Trip Cam Screw
- RD 0943 Bail Spring Cover
- RD 0944 Bail Trip Cover
- RD 0948 Bail Trip Cover Screw
- RD 0949 Trigger Screw
- RD 1004 Bushing A
- RD 1005 Drive Gear
- RD 1007 Lock Washer Retainer

PART # DESCRIPTION

- RD 1008 Handle Lock Washer
- RD 1021 Handle Assembly
- RD 1023 Handle Screw Cap
- RD 1038 Sic Ceramic Roller
- RD 1301 Bail Assembly
- RD 1302 Line Roller Screw
- RD 1351 Main Shaft
- RD 1352 Body
- RD 1353 Side Cover
- RD 1354 Drag Click
- RD 1355 Drag Washer "C1"
- RD 1356 Eared Washer "BF"
- RD 1357 Drag Shaft
- RD 1358 Lever Quadrant
- RD 1359 Lever Click Gear
- RD 1360 Fightin' Pressure Screw
- RD 1362 Drag Programmer
- RD 1963 Anti-Reverse Lock Out
- RD 1964 Anti-Reverse Lock Out Spring
- RD 1965 Pinion Spacer
- RD 1974 Drag Coil Spring
- RD 1975 Fightin' Drag II Lever
- RD 0550 Coned Disc Spring
- RD 1355 Drag Washer "C1"