

## 1987 REPAIR MANUAL

Shimano American Corporation, One Shimano Dr.  
Irvine, CA 92718

※ Please look here for "S" mark here  
(e.g. 87<sup>S</sup> (KB)-JAPAN)

### TO ORDER:

This reel belongs to the "Rear Drag" series.  
Please order parts using the abbreviation  
"RD" and the part number.

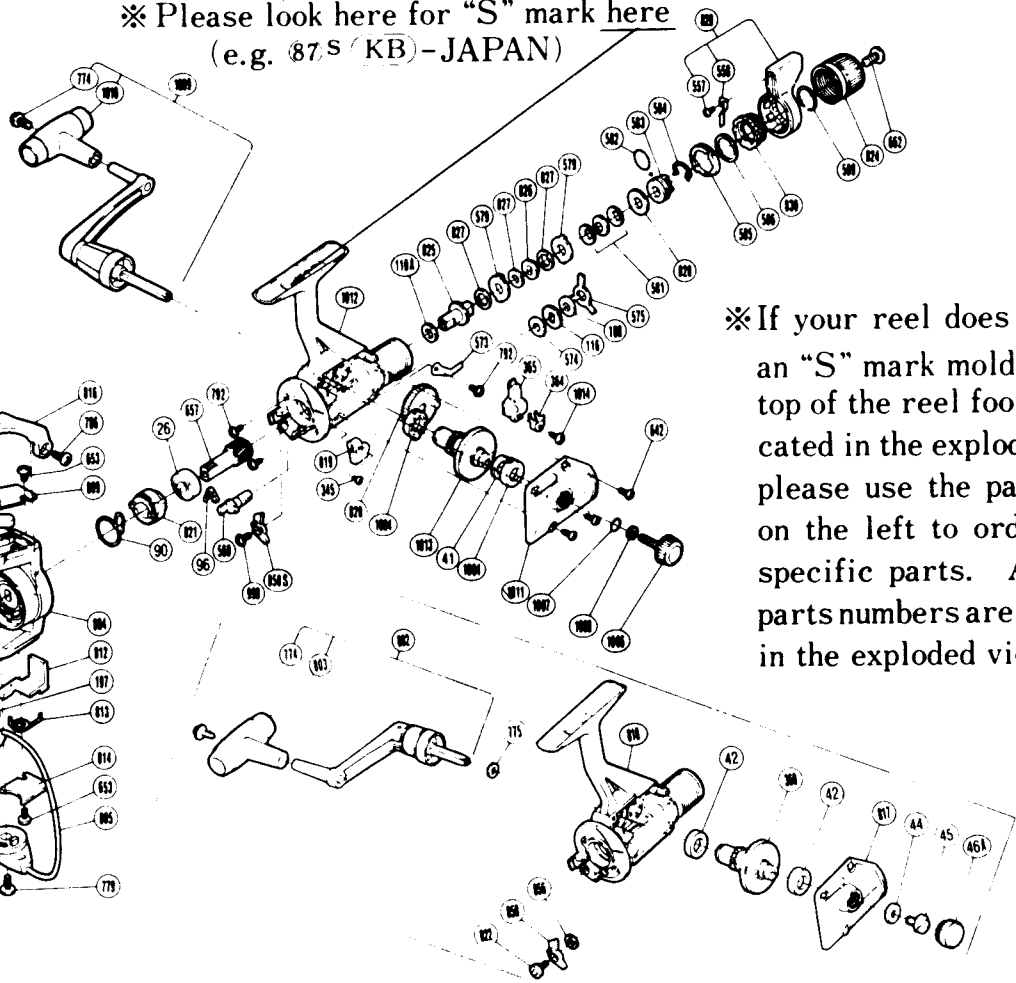
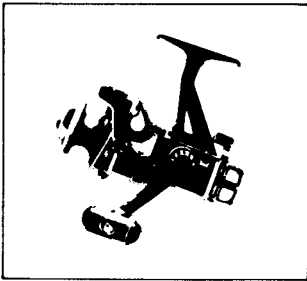

※ If your reel does not have an "S" mark molded on the top of the reel foot as indicated in the exploded view, please use the parts view on the left to order these specific parts. All other parts numbers are as shown in the exploded view.

### EXPLODED PARTS VIEW

**TX120 Plus**

### PARTS LIST

#### PART # DESCRIPTION

- 26. Ball Bearing
- 41. Drive Gear Washer
- 42. Bushing
- 44. Handle Lock Washer
- 45. Handle Lock Screw (Originally 796)
- 46A. Handle Screw Cap
- 71. Rotor Nut
- 80. Line Roller
- 88. Line Roller Screw (orig. 806)
- 90. Anti-Reverse Pawl Spring
- 96. Anti-Reverse Cam Spring
- 108. Drag Washer "C<sub>1</sub>"
- 110A. Drag Washer "D<sub>2</sub>"
- 116. Click Gear
- 197. Bail Trip Slide Cam
- 345. Anti-Reverse Lever Screw
- 360. Drive Gear
- 363. Slider Retainer Screw
- 364. Oscillating Slider Retainer
- 365. Oscillating Slider
- 557. Fightin' Drag Click Screw
- 558. Fightin' Drag Click
- 569. Anti-Reverse Cam
- 573. Drag Click
- 574. Drag Washer "C<sub>2</sub>"
- 575. Eared Washer "BF"
- 579. Eared Washer "B"
- 581. Coned Disc Springs
- 582. "O" Ring
- 583. Pressure Screw
- 584. Hold Click Spring

#### PART # DESCRIPTION

- 585. Lever Click Gear
- 586. Fightin' Pressure Screw Washer
- 589. Lever Hold Spring
- 642. Side Cover Screw
- 653. Bail Trip Cover Screw
- 657. Pinion Gear
- 662. Drag Programmer Screw
- 774. Handle Knob Screw
- 775. Handle Lock Spacer
- 779. Bail Trip Cam Screw
- 786. Trigger Screw
- 787. Nut Lock Screw
- 792. Multi Purpose Screw
- 801. Spool Assembly (Universal)
- 802. Handle
- 803. Handle Knob
- 804. Rotor
- 805. Bail Assembly
- 807. Bail Arm
- 808. Bail Spring
- 809. Bail Spring Cover
- 810. Ball Spring Guide A
- 811. Ball Spring Guide B
- 812. Bail Trip Lever
- 813. Lever Spring
- 814. Bail Trip Cover
- 815. Line Roller Washer
- 816. Quick-Fire II Trigger
- 817. Side Cover
- 818. Body
- 819. Anti-Reverse Lever
- 820. Oscillating Gear

#### PART # DESCRIPTION

- 821. Anti-Reverse Ratchet
- 822. Anti-Reverse Pawl Screw
- 823. Main Shaft
- 824. Drag Programmer
- 825. Drag Shaft
- 826. Key Washer "A"
- 827. Drag Washer "H<sub>1</sub>"
- 828. Drag Spring Washer "A"
- 829. Fightin' Drag Lever
- 830. Fightin' Pressure Screw
- 850. Anti-Reverse Pawl
- 850S. Anti-Reverse Pawl ("S" Version)
- 856. Anti-Reverse Pawl Spacer
- 998. Anti-Reverse Pawl Screw ("S" Version)
- 1004. Bushing ("S" Version)
- 1006. Handle Screw Cap ("S" Version)
- 1007. Lock Washer Retainer ("S" Version)
- 1008. Handle Lock Washer ("S" Version)
- 1009. Handle Assembly ("S" Version)
- 1010. Handle Knob ("S" Version)
- 1011. Side Cover ("S" Version)
- 1012. Body ("S" Version)
- 1013. Drive Gear ("S" Version)
- 1014. Slider Retainer Screw ("S" Version)