

EXPLODED PARTS VIEW
B-Mag 2000II

SHIMANO®

1990 REPAIR MANUAL

Shimano American Corporation, One Shimano Dr.
Irvine, CA 92718

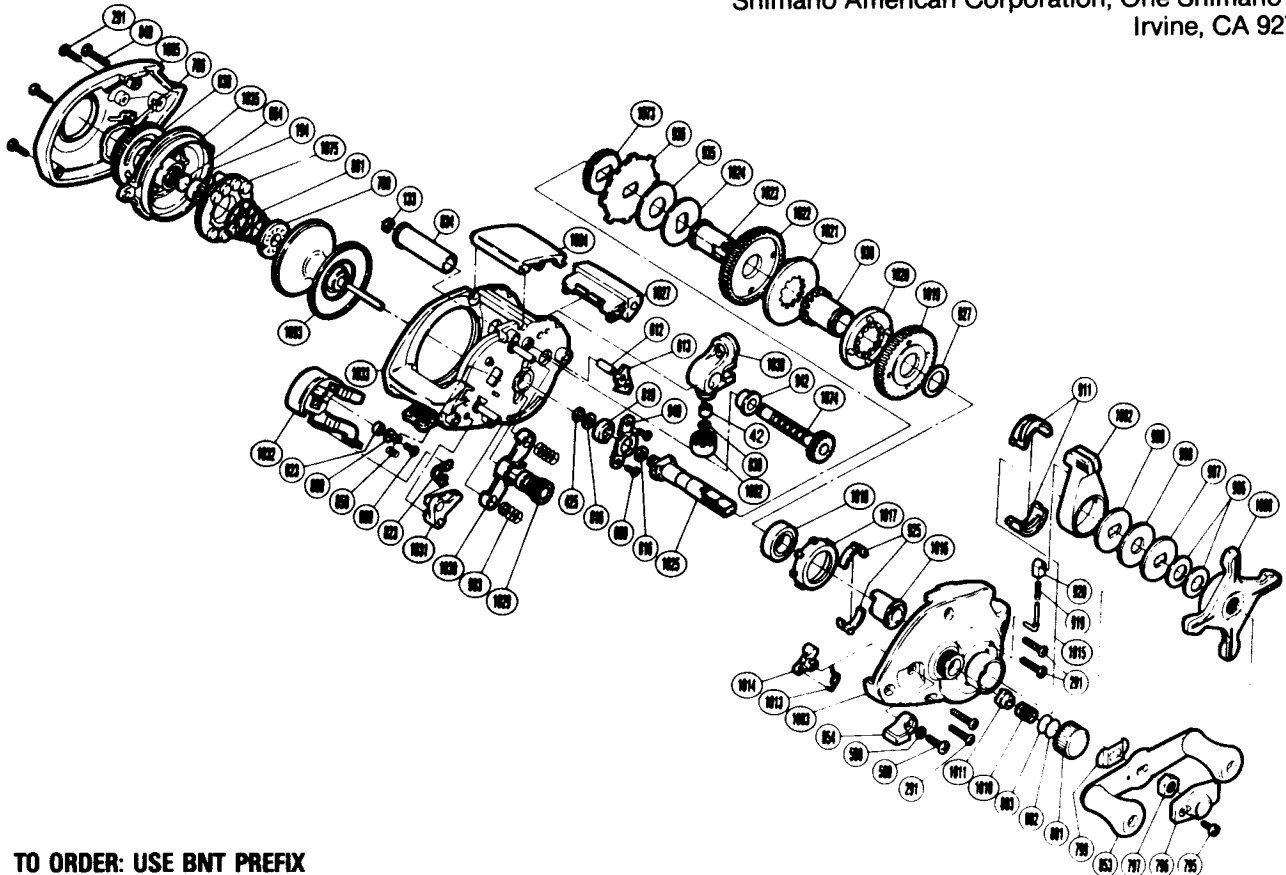

**TO ORDER: USE BNT PREFIX
WITH PART NUMBER**

PARTS LIST

BNT #	DESCRIPTION	BNT #	DESCRIPTION	BNT #	DESCRIPTION
0042	Line Guide Pawl	0834	Level Wind Guard	1014	Flipping Cam
0133	Worm Shaft Retainer	0838	Magnetic Control Dial	1015	Shift Spring Guide (A)
0194	Ball Bearing	0840	Left Side Plate Screw	1016	Drag Shaft (B)
0291	Side Plate Screw	0853	Handle Assembly	1017	Bearing Holder
0425	Clutchbutton Lock	0854	Flipping Lever	1018	Drive Shaft Bearing (B)
0589	Flipping Lever Screw	0859	Flipping Retractor Spring	1019	Drive Gear (L)
0590	Lock Washer	0860	Yoke Plate Washer (B)	1020	Shift Clutch (L)
0609	Drive Shaft Retainer Screw	0906	Coned Disc Spring	1021	Shift Clutch (H)
0612	Anti-Reverse Pawl Pin	0907	Key Washer (A)	1022	Drive Gear (H)
0613	Anti-Reverse Pawl	0908	Drag Washer (D)	1023	Drag Shaft (A)
0661	Magnet Retainer Spring	0909	Key Washer (C)	1024	Drive Shaft Washer
0664	Spacer (B)	0911	Shift Cam	1025	Drive Shaft
0766	Dial Friction Washer	0919	Shift Spring	1027	Level Wind Protector
0780	Magnet Retainer Lock	0920	Shift Spring Guide (B)	1029	Pinion Gear
0795	Handle Nut Plate Screw	0925	Shift Arm	1030	Yoke
0796	Handle Nut Plate	0927	Drive Gear Washer	1031	Joint Plate
0797	Handle Nut	0930	Shift Sleeve	1032	Clutch Button
0799	Friction Washer	0935	Drag Washer (A)	1033	One-Piece Frame
0801	Cast Control Cap	0936	Anti-Reverse Ratchet	1035	Dial Case
0802	Spool Tension Spacer (B)	0940	Drive Shaft Retainer	1039	Line Guide
0803	Spool Tension Spacer (A)	0942	Worm Bearing	1073	Idle Gear
0816	Drive Shaft Washer	0993	Yoke Spring	1074	Worm Shaft
0819	Drive Shaft Bushing	1008	Star Drag	1075	Magnet Retainer
0823	Retractor Spring	1010	Spool Tension Spring	1092	Pawl Cap
0825	Yoke Plate Washer (A)	1011	Spool Shaft Bushing (A)	1093	Spool
0830	Spacer (Optional)	1013	Cam Spring		

Prices and specifications subject to change without notice.

1/1990