

SHIMANO®

1994 REPAIR MANUAL

Shimano American Corporation, One Shimano Dr.
Irvine, CA 92718

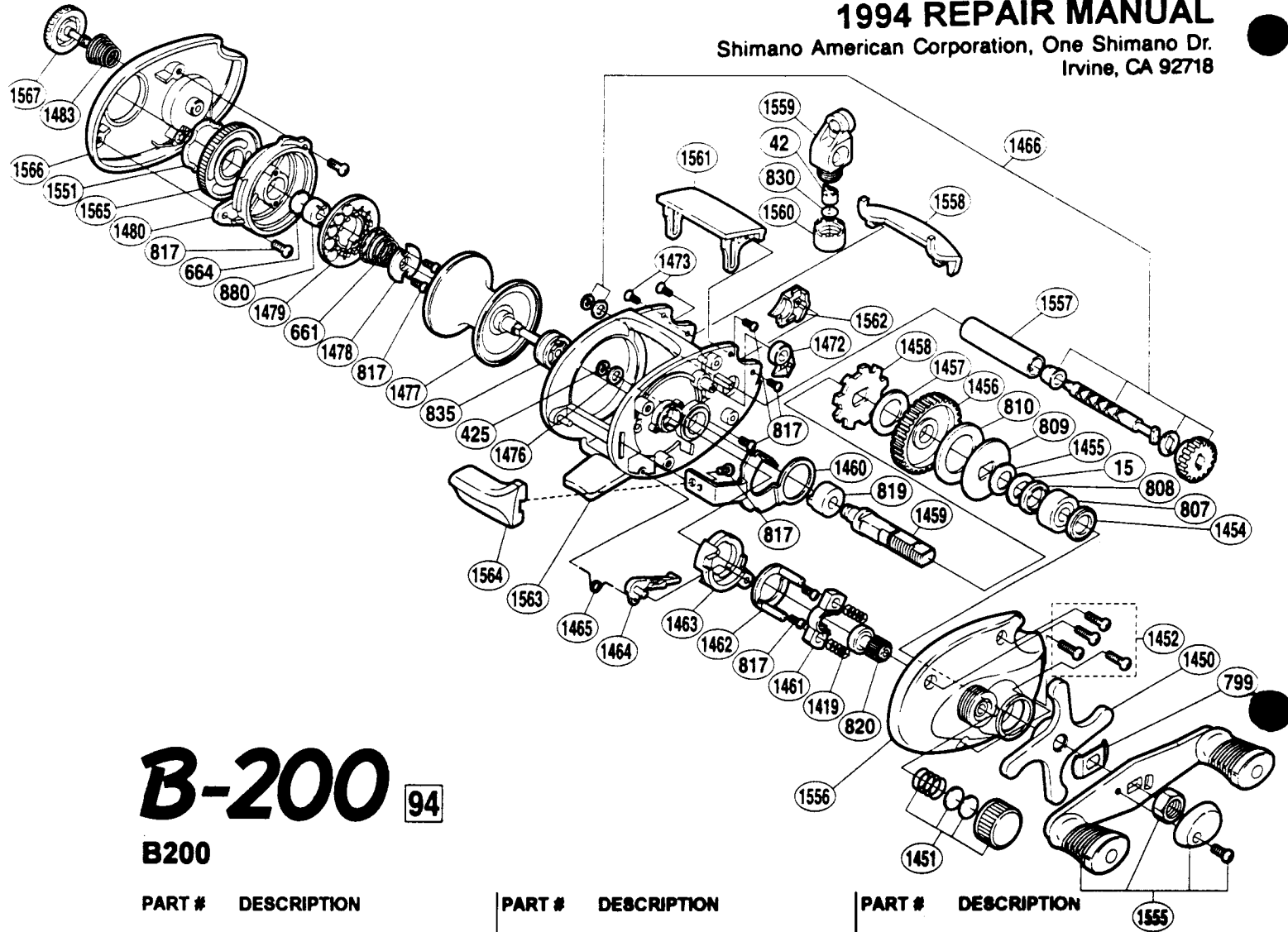

B-200 94

B200

| PART # | DESCRIPTION |
|---------|---------------------------|
| BNT0015 | Drag Spring Washer |
| BNT0042 | Line Guide Pawl |
| BNT0425 | Drive Gear Retainer |
| BNT0661 | Magnet Retainer Spring |
| BNT0664 | Spacer (B) |
| BNT0799 | Friction Washer |
| BNT0807 | Drive Shaft Bearing |
| BNT0808 | Friction Washer (B) |
| BNT0809 | Key Washer |
| BNT0810 | Drag Washer |
| BNT0817 | Multi Purpose Screw |
| BNT0819 | Drive Shaft Bushing |
| BNT0820 | Pinion Gear |
| BNT0830 | Spacer (optional) |
| BNT0835 | Spool Shaft Bushing (B) |
| BNT0880 | Spool Shaft Bushing (C) |
| BNT1419 | Yoke Spring |
| BNT1450 | Star Drag |
| BNT1451 | Cast Control Cap Assembly |

| PART # | DESCRIPTION |
|---------|------------------------|
| BNT1452 | Side Palte Screws |
| BNT1454 | Bearing Bushing |
| BNT1455 | Drag Spring Washer |
| BNT1456 | Drive Gear |
| BNT1457 | Drive Shaft Washer (B) |
| BNT1458 | Anti-reverse Ratchet |
| BNT1459 | Drive Shaft |
| BNT1460 | Clutch Plate |
| BNT1461 | Yoke |
| BNT1462 | Clutch Cam Retainer |
| BNT1463 | Clutch Cam |
| BNT1464 | Clutch Pawl |
| BNT1465 | Clutch Pawl Spring |
| BNT1466 | Worm Shaft Assembly |
| BNT1472 | Anti-reverse Pawl |
| BNT1473 | Multi Purpose Screw |
| BNT1476 | Drive Shaft Washer (D) |
| BNT1477 | Spool |

| PART # | DESCRIPTION |
|---------|--------------------------|
| BNT1478 | Magnet Holder |
| BNT1479 | Magnet Retainer |
| BNT1480 | Dial Case |
| BNT1483 | Lock Spring |
| BNT1551 | Dial Friction Washer |
| BNT1555 | Handle Assembly |
| BNT1556 | Right Side Plate |
| BNT1557 | Level Wind Guard |
| BNT1558 | Level Wind Protector |
| BNT1559 | Line Guide |
| BNT1560 | Pawl Cap |
| BNT1561 | Thumb Rest |
| BNT1562 | Drive Shaft Cover |
| BNT1563 | One-Piece Frame |
| BNT1564 | Quick-Fire II Clutch Bar |
| BNT1565 | Magnetic Control Dial |
| BNT1566 | Left Side Plate |
| BNT1567 | Lock Screw Cap |