

SHIMANO®

1987 REPAIR MANUAL

Shimano American Corporation, One Shimano Dr.
Irvine, CA 92718

TO ORDER:

This reel belongs to the "Bantam" series.
Please order parts using the abbreviation
"BNT" and the part number.

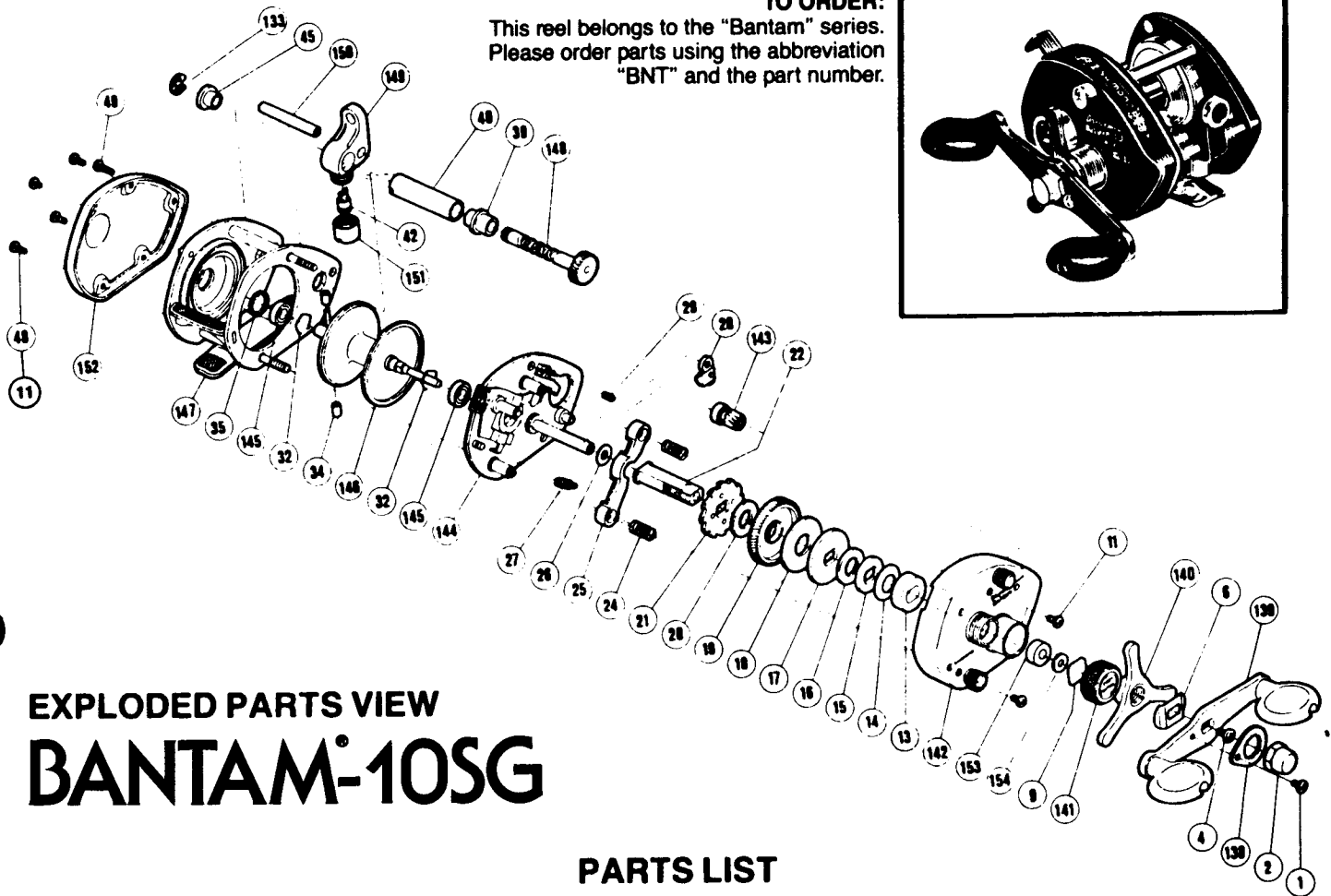
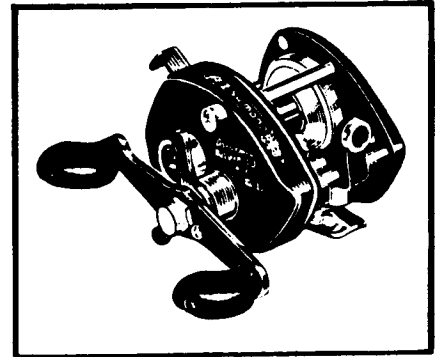

EXPLODED PARTS VIEW BANTAM-10SG

PARTS LIST

PART # DESCRIPTION

- 1. Handle Nut Lock Screw
- 2. Handle Nut
- 4. Drive Shaft Retainer Screw
- 6. Friction Washer
- 9. Cast Control Spacer
- 11. Sideplate Screw
- 13. Drive Shaft Bearing
- 14. Drag Spring Washer
- 15. "D" Washer
- 16. Drag Spacer
- 17. Pressure Plate
- 18. Drag Washer
- 19. Drive Gear
- 20. Base Drag Washer
- 21. Anti-Reverse Ratchet
- 22. Drive Shaft
- 24. Pinion Yoke Spring
- 25. Pinion Yoke

PART # DESCRIPTION

- 26. Drive Shaft Shim
- 27. Retractor Spring #1
- 28. Anti-Reverse Dog
- 29. Retractor Spring #2
- 32. Bearing Lock
- 34S. Centrifugal Brake Weights (Small)
- 34L. Centrifugal Brake Weights (Large)
- 35. Left Bearing Spacer
- 39. Level Wind Bearing Right
- 40. Level Wind Guard
- 42. Level Wind Pawl
- 45. Level Wind Bearing Left
- 48. Left Side Plate Screw
- 49. Left Stabilizer Bar Screw
- 60. Line Guide Pawl Spacer (optional)

PART # DESCRIPTION

- 133. Level Wind Gear Lock
- 138. Handle Nut Lock Plate
- 139. Handle
- 140. Drag Tri Star
- 141. Cast Control Cap
- 142. Right Sideplate
- 143. Pinion Gear
- 144. Set Plate
- 145. Spool Shaft Bushing
- 146. Spool
- 147. Frame
- 148. Level Wind Gear
- 149. Line Guide
- 150. Stabilizer Bar
- 151. Pawl Cap
- 152. Left Sideplate
- 153. Cast Control Bushing
- 154. Felt Oil Retainer

*Optional—not shown in exploded view.