

# SHIMANO®

## 1987 REPAIR MANUAL

Shimano American Corporation, One Shimano Dr.  
Irvine, CA 92718

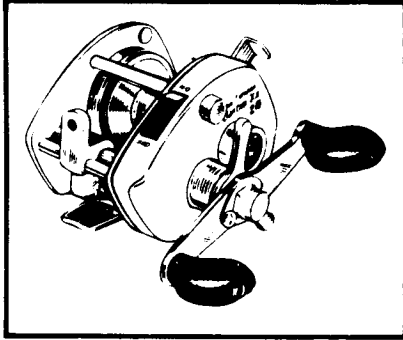

### TO ORDER:

This reel belongs to the "Bantam" series.  
Please order parts using the abbreviation  
"BNT" and the part number.

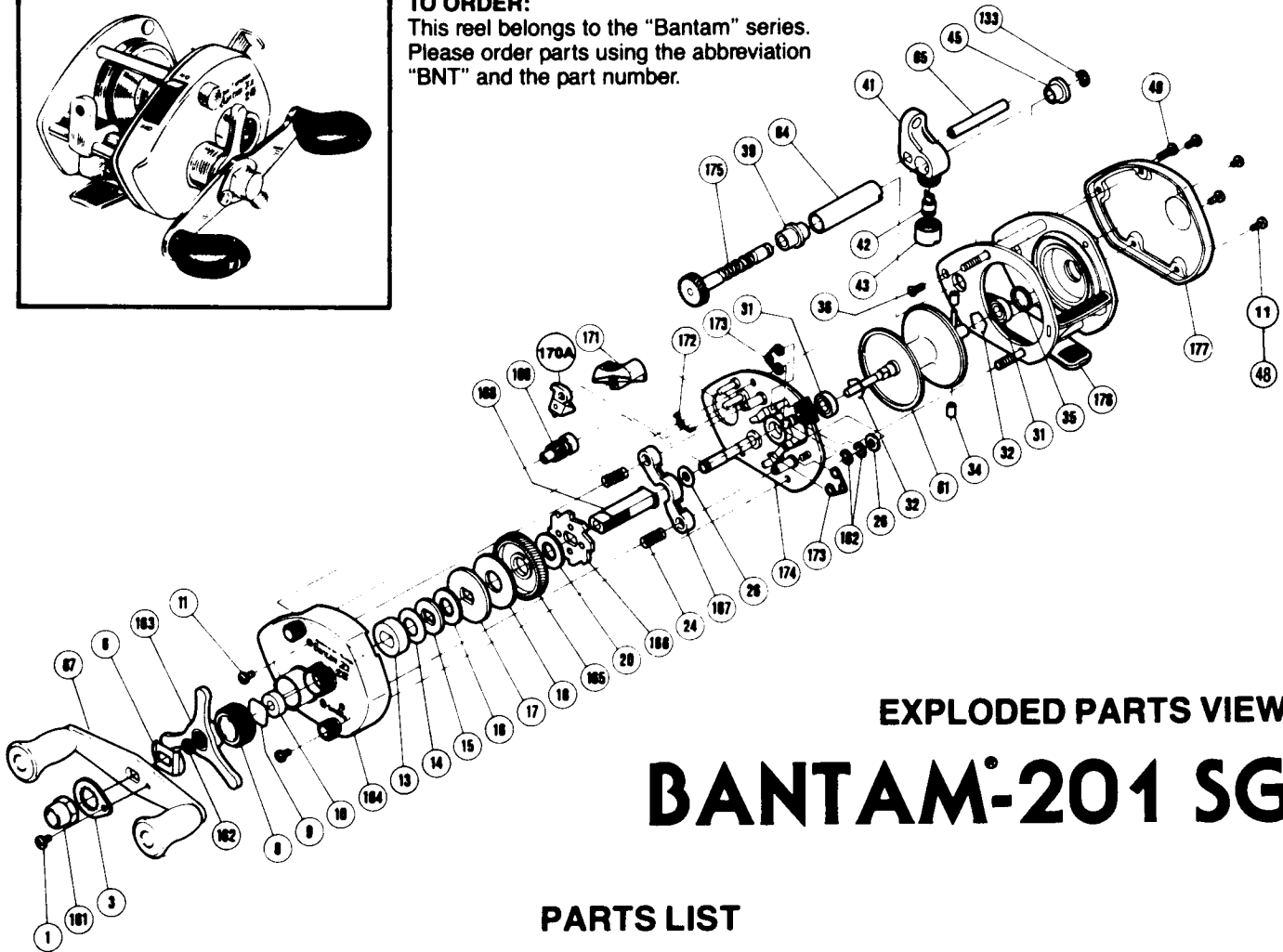

### EXPLODED PARTS VIEW

# BANTAM-201 SG

## PARTS LIST

### PART # DESCRIPTION

- 1. Handle Nut Lock Screw
- 3. Handle Nut Lock Plate
- 6. Friction Washer
- 8. Cast Control Cap
- 9. Cast Control Spacer
- 10. Cast Control Bushing
- 11. Side Plate Screw
- 13. Drive Shaft Bearing
- 14. Drag Spring Washer
- 15. "D" Washer
- 16. Drag Spacer
- 17. Pressure Plate
- 18. Drag Washer
- 20. Base Drag Washer
- 24. Pinion Yoke Spring
- 26. Drive Shaft Shim
- 31. Spool Shaft Bearing
- 32. Bearing Lock

### PART # DESCRIPTION

- 34S. Centrifugal Brake  
Weights (Small)
- 34L. Centrifugal Brake  
Weights (Large)
- 35. Bearing Spacer
- 36. Stabilizer Bar Screw
- 39. Level Wind Bearing
- 41. Line Guide
- 42. Level Wind Pawl
- 43. Pawl Cap
- 45. Level Wind Bearing
- 48. Side Plate Screw
- 49. Stabilizer Bar Screw
- 60. Line Guide Pawl Shim  
(optional) \*
- 61. Spool
- 64. Level Wind Guard
- 65. Stabilizer Bar

### PART # DESCRIPTION

- 67. Handle
- 133. Level Wind Gear Lock
- 161. Handle Nut
- 162. "C" Lock
- 163. Drag Tri-Star
- 164. Left Side Plate
- 165. Drive Gear
- 166. Anti-Reverse Ratchet
- 167. Pinion Yoke
- 168. Drive Shaft
- 169. Pinion Gear
- 170A. Anti-Reverse Dog
- 171. Anti-Reverse Switch
- 172. Switch Spring
- 173. Retractor Spring
- 174. Set Plate
- 175. Level Wind Gear
- 176. Frame
- 177. Right Side Plate

\*Optional—not shown in exploded view.

Prices and specifications subject to change without notice.

JUNE 1986