

SHIMANO

REPAIR MANUAL

Shimano American Corporation, 205 Jefferson Road
Parisippany, N.J. 07054

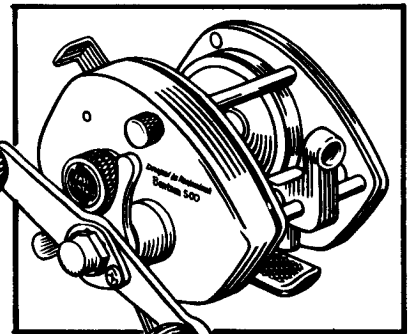

BANTAM 500

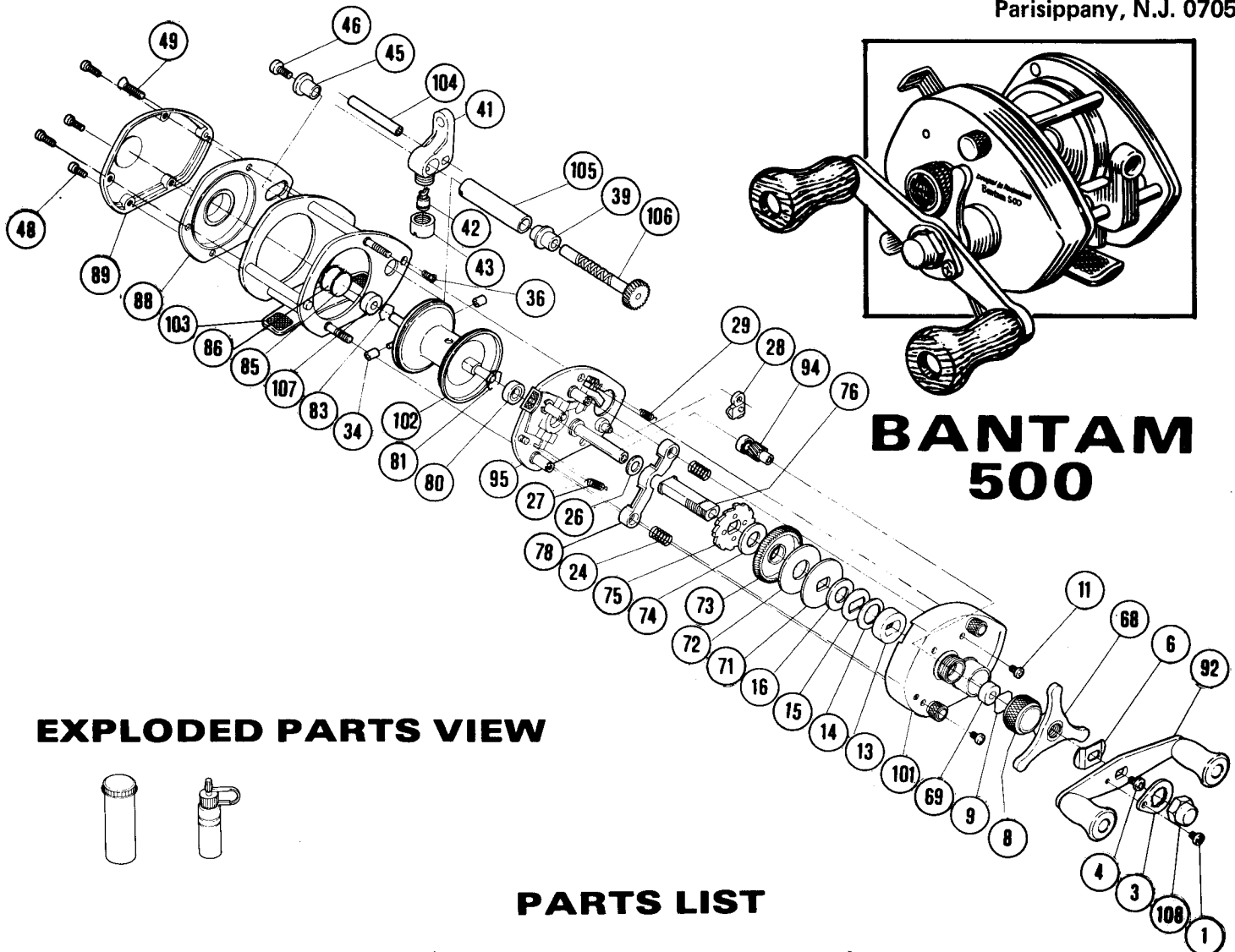

EXPLODED PARTS VIEW

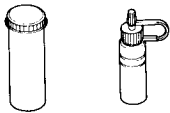

PARTS LIST

PART #	DESCRIPTION	PRICE	PART #	DESCRIPTION	PRICE	PART #	DESCRIPTION	PRICE
1	Handle Nut Lock Screw	.15	39	Level Wind Bearing (Right)	.20	80	Right Spool Bearing	6.50
3	Handle Nut Lock Plate	.30	41	Line Guide	2.50	81	Right Bearing Lock	.15
4	Drive Shaft Retainer Screw	.15	42	Level Wind Pawl	1.00	83	Left Bearing Lock	.15
6	Friction Washer	.20	43	Pawl Cap	.50	85	Left Bearing Spacer	.15
8	Cast Control Cap	.95	45	Level Wind Bearing (Left)	.20	86	Left Bearing Shim	.15
9	Cast Control Spacer	.15	46	Level Wind Retainer Screw	.15	88	Left Bearing Plate	6.40
11	Right Sideplate Screw	.15	48	Left Side Plate Screw	.20	89	Left Side Plate	2.00
13	Drive Shaft Bearing	.15	49	Left Stabilizer Bar Screw	.15	92	Handle	6.50
14	Drag Spring Washer	.15	60	Line Guide Pawl Spacer*	.15	94	Pinion Gear	5.00
15	"D" Washer	.20	68	Drag Tri-Star	2.35	95	Set Plate	14.75
16	Drag Spacer	.40	69	Spool Shaft Bushing	.25	101	Right Side Plate	12.50
24	Pinion Yoke Spring	.15	71	Pressure Plate	.35	102	Spool	20.00
26	Drive Shaft Shim	.15	72	Drag Washer	.15	103	Frame	17.00
27	Retractor Spring #1	.60	73	Drive Gear	3.50	104	Stabilizer Bar	1.60
28	Anti Reverse Dog	1.00	74	Base Drag Washer	.25	105	Level Wind Guard	3.00
29	Retractor Spring #2	.35	75	Anti Reverse Ratchet	1.90	106	Level Wind Gear	3.75
34	Centrifugal Brake Weights	.15	76	Drive Shaft	5.65	107	Left Spool Bearing	1.20
36	Right Stabilizer Bar Screw	.15	78	Pinion Yoke	.25	108	Handle Nut	.75

Prices and specifications subject to change without notice.

*Optional - not shown in exploded view.