

⚡ Please check the head of the "Magnetic Control Dial" here to see whether you have an old or new-type reel.

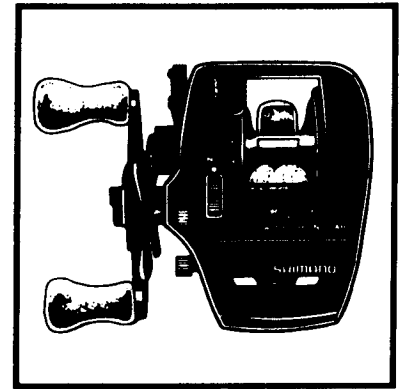
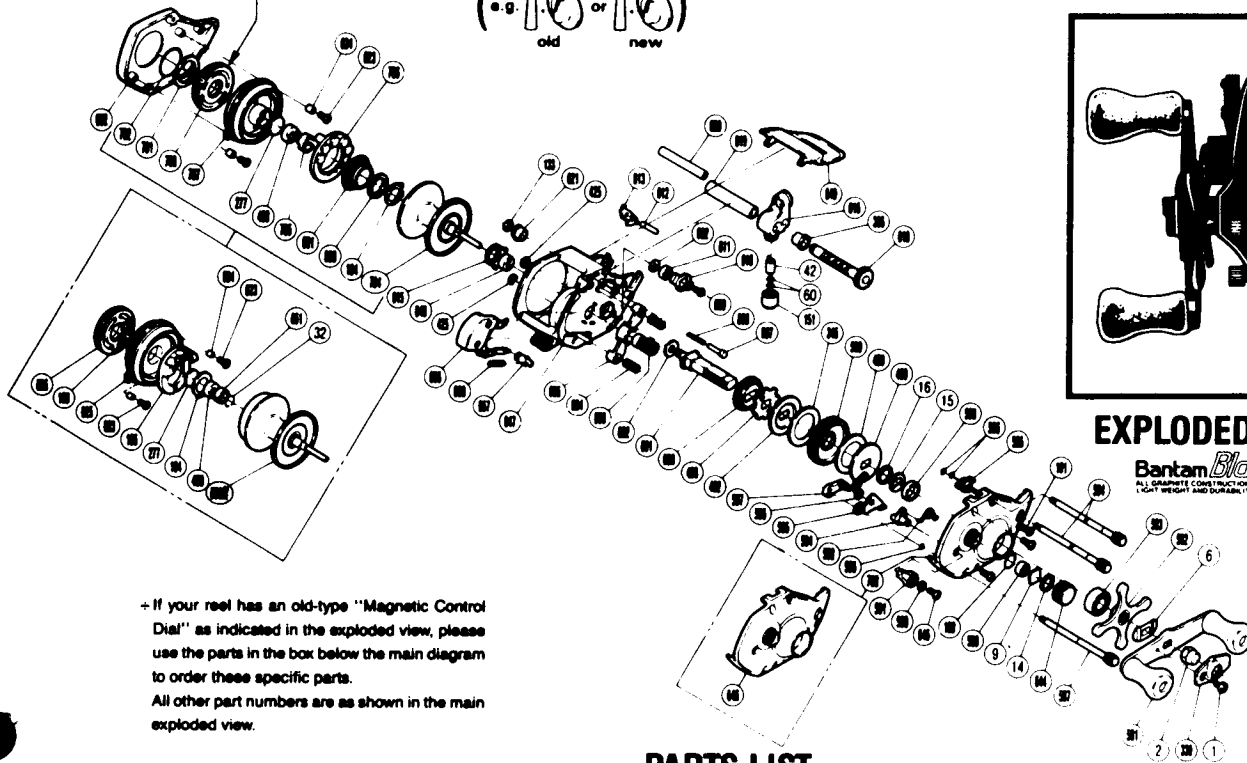
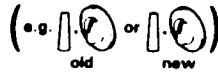

EXPLODED PARTS VIEW

Bantam Black Magnum 100
ALL CARBIDE CONSTRUCTION FOR STRENGTH AND BALL BEARING SYSTEM
LIGHT WEIGHT AND DURABILITY.

⚡ If your reel has an old-type "Magnetic Control Dial" as indicated in the exploded view, please use the parts in the box below the main diagram to order these specific parts.
All other part numbers are as shown in the main exploded view.

PARTS LIST

PART #	DESCRIPTION
BNT 0001	Handle Screw "B"
BNT 0002	Handle Nut
BNT 0006	Friction Washer (A)
BNT 0009	Spacer (A)
BNT 0014	Friction Washer (B)
BNT 0015	Drag Spring Washer
BNT 0016	Friction Washer (C)
BNT 0032	Bearing Retainer
BNT 0042	Line Guide Pawl
BNT 0060	Spacer (Optional)
BNT 0133	Worm Shaft Retainer
BNT 0151	Pawl Cap
BNT 0184	Magnet Retainer Lock
BNT 0185	Magnet Retainer (Assembly)
BNT 0188	O Ring
BNT 0191	Side Plate Screw
BNT 0277	Spacer (B)
BNT 0330	Handle Nut (Lock) Plate
BNT 0345	Drive Shaft Washer "B"
BNT 0356	Worm Bearing "A"
BNT 0425	Clutchbutton Lock
BNT 0458	Bushing "A"
BNT 0489	Key Washer "A"
BNT 0490	Drag Washer
BNT 0492	Key Washer "B"
BNT 0493	Anti-Reverse Ratchet
BNT 0581	Handle Assembly
BNT 0582	Star Drag
BNT 0583	Drive Shaft Bearing
BNT 0584	Left Side Plate Bolt "C"
BNT 0585	Anti-Reverse Switch
BNT 0586	Bolt Retainer
BNT 0587	Left Side Plate Bolt "A"
BNT 0588	Spool Shaft Bushing
BNT 0590	Lock Washer
BNT 0591	Flipping Lever
BNT 0593	Cam Spring
BNT 0594	Flipping Cam
BNT 0595	Joint Plate
BNT 0596	Retractor Spring
BNT 0597	Retractor Spring Guide
BNT 0598	Bushing
BNT 0599	Drive Gear
BNT 0600	Idle Gear
BNT 0601	Drive Shaft
BNT 0602	Drive Shaft Washer "C"
BNT 0603	Pinion Gear
BNT 0604	Yoke Spring
BNT 0605	Yoke
BNT 0606	Clutch Button
BNT 0607	Switch Spring Pin
BNT 0608	Switch Spring
BNT 0609	Drive Shaft Retainer Screw
BNT 0610	Drive Shaft Retainer
BNT 0611	Drive Shaft Bushing
BNT 0612	Anti-Reverse Pawl Pin
BNT 0613	Anti-Reverse Pawl
BNT 0615	Bearing Retainer
BNT 0616	Line Guide
BNT 0618	Worm Shaft
BNT 0619	Level Wind Guard
BNT 0620	Stabilizer Bar
BNT 0621	Worm Bearing "B"
BNT 0623	Dial Case Screw
BNT 0624	Screw Support
BNT 0625	Dial Case
BNT 0626	Magnetic Control Dial
BNT 0644	Cast Control Cap
BNT 0645	Flipping Lever Screw
BNT 0646	Right Side Plate
BNT 0647	One-Piece Frame
BNT 0648	Spool Shaft Bushing
BNT 0649	Thumb Rest
BNT 0650R	Spool (Right Handle)
BNT 0651	Bushing Spacer
BNT 0652	Left Side Plate
BNT 0657	Clutch Button Guide Pin
BNT 0658	Flipping Retractor Spring
BNT 0660	Spring Spacer
BNT 0661	Magnet Retainer Spring
BNT 0701	Thrust Washer Spacer (Optional)
BNT 0702	Dial O Ring
BNT 0703	Right Side Plate
BNT 0704	Spool
BNT 0705	Bushing Retainer
BNT 0706	Magnet Retainer
BNT 0707	Dial Case
BNT 0708	Magnet Control Dial