

SHIMANO

1988 REPAIR MANUAL

Shimano American Corporation, One Shimano Dr.
Irvine, CA 92718

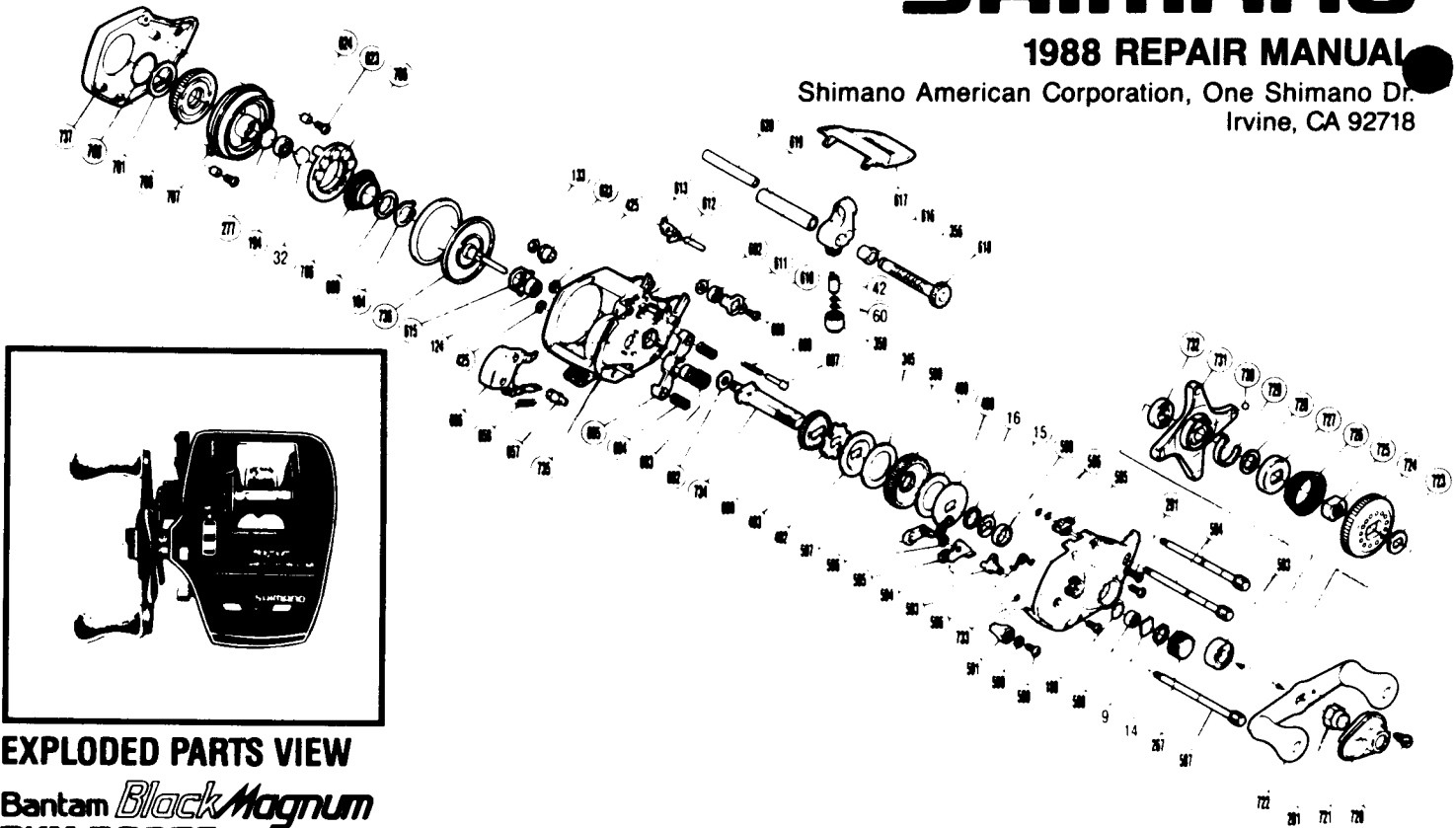

EXPLODED PARTS VIEW

Bantam *Black Magnum*
BKM-200FS

PARTS LIST

PART # DESCRIPTION

BNT 0009 Spacer (A)
BNT 0014 Friction Washer (B)
BNT 0015 Drag Spring Washer
BNT 0016 Friction Washer (C)
BNT 0032 Bearing Retainer
BNT 0042 Line Guide Pawl
BNT 0060 Spacer (Optional)
BNT 0124 Spool Shaft Bearing
BNT 0133 Worm Shaft Retainer
BNT 0184 Magnet Retainer Lock
BNT 0188 O Ring
BNT 0194 Ball Bearing
BNT 0267 Cast Control Cap
BNT 0277 Spacer (B)
BNT 0281 Handle Nut
BNT 0291 Side Plate Screw
BNT 0345 Drive Shaft Washer "B"
BNT 0356 Worm Bearing "A"
BNT 0358 Pawl Cap
BNT 0425 Clutchbutton Lock
BNT 0489 Key Washer "A"
BNT 0490 Drag Washer
BNT 0492 Key Washer "B"
BNT 0493 Anti-Reverse Ratchet
BNT 0583 Drive Shaft Bearing
BNT 0584 Left Side Plate Bolt "C"
BNT 0585 Anti-Reverse Switch
BNT 0586 Bolt Retainer
BNT 0587 Left Side Plate Bolt "A"
BNT 0588 Spool Shaft Bushing

PART # DESCRIPTION

BNT 0589 Flipping Lever Screw
BNT 0590 Lock Washer
BNT 0591 Flipping Lever
BNT 0593 Cam Spring
BNT 0594 Flipping Cam
BNT 0595 Joint Plate
BNT 0596 Retractor Spring
BNT 0597 Retractor Spring Guide
BNT 0598 Bushing
BNT 0599 Drive Gear
BNT 0600 Idle Gear
BNT 0602 Drive Shaft Washer "C"
BNT 0603 Pinion Gear
BNT 0604 Yoke Spring
BNT 0605 Yoke
BNT 0606 Clutch Button
BNT 0607 Switch Spring Pin
BNT 0608 Switch Spring
BNT 0609 Drive Shaft Retainer Screw
BNT 0610 Drive Shaft Retainer
BNT 0611 Drive Shaft Bushing
BNT 0612 Anti-Reverse Pawl Pin
BNT 0613 Anti-Reverse Pawl
BNT 0615 Bearing Retainer
BNT 0616 Line Guide
BNT 0617 Thumb Rest
BNT 0618 Worm Shaft
BNT 0619 Level Wind Guard
BNT 0620 Stabilizer Bar
BNT 0621 Worm Bearing "B"

PART # DESCRIPTION

BNT 0623 Dial Case Screw
BNT 0624 Screw Support
BNT 0657 Clutch Button Guide Pin
BNT 0658 Flipping Retractor Spring
BNT 0660 Spring Spacer
BNT 0661 Magnet Retainer Spring
BNT 0701 Thrust Washer Spacer (Optional)
BNT 0706 Magnet Retainer
BNT 0707 Dial Case
BNT 0708 Magnet Control Dial
BNT 0720 Handle Nut Plate Screw
BNT 0721 Handle Nut Plate
BNT 0722 Handle Assembly
BNT 0723 Friction Washer "A"
BNT 0724 Pre-Set Dial
BNT 0725 Pre-Set Nut
BNT 0726 Pre-Set Spring
BNT 0727 Strike
BNT 0728 Pre-Set Washer
BNT 0729 Strike Spring
BNT 0730 Strike Ball
BNT 0731 Star Drag
BNT 0732 Drive Shaft Cam
BNT 0733 Right Side Plate
BNT 0734 Drive Shaft
BNT 0735 One-Piece Frame
BNT 0736 Spool
BNT 0737 Left Side Plate
BNT 0766 Dial Friction Washer