

SHIMANO®

1988 REPAIR MANUAL

Shimano American Corporation, One Shimano Dr.
Irvine, CA 92718

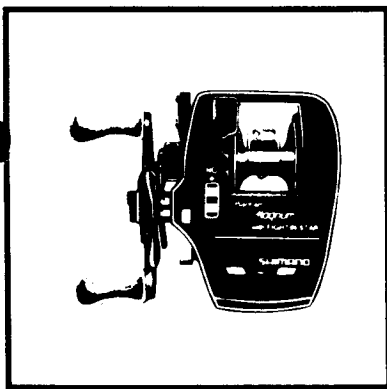

EXPLODED PARTS VIEW

Bantam *Black Magnum*
BKM-201FS

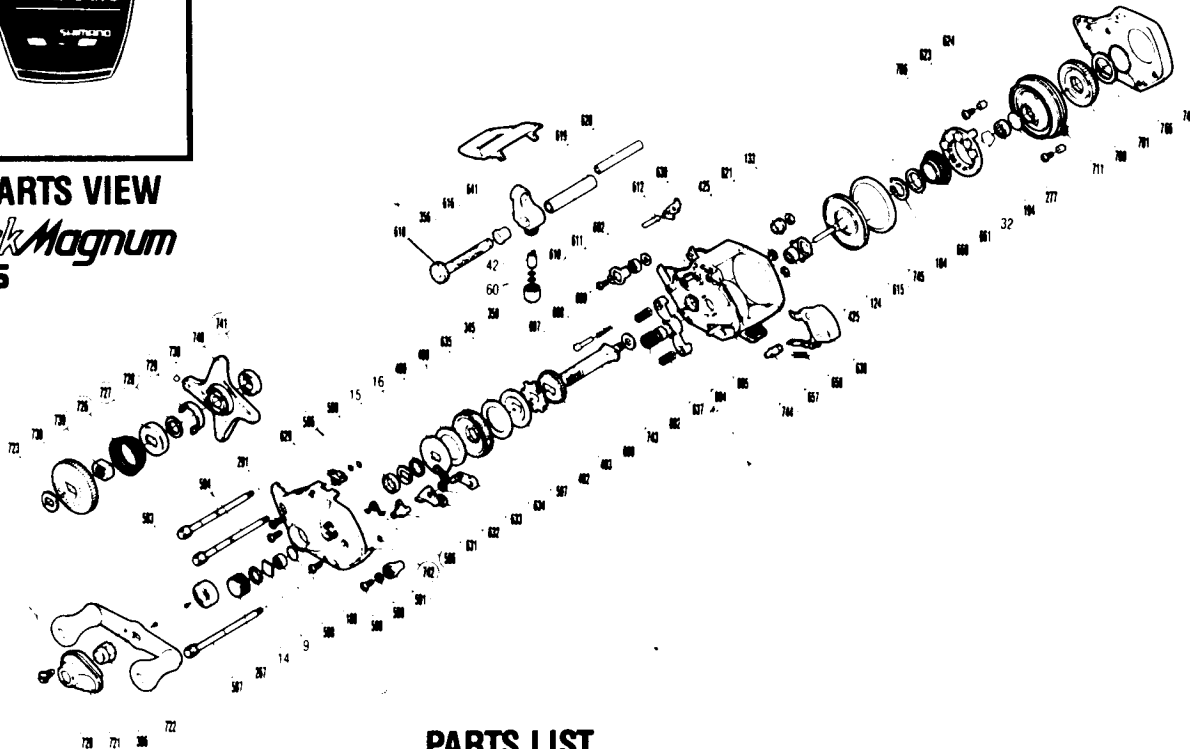

PARTS LIST

PART # DESCRIPTION

BNT 0009	Spacer (A)
BNT 0014	Friction Washer (B)
BNT 0015	Drag Spring Washer
BNT 0016	Friction Washer (C)
BNT 0032	Bearing Retainer
BNT 0042	Line Guide Pawl
BNT 0060	Spacer (Optional)
BNT 0124	Spool Shaft Bearing
BNT 0133	Worm Shaft Retainer
BNT 0184	Magnet Retainer Lock
BNT 0188	O Ring
BNT 0194	Ball Bearing
BNT 0267	Cast Control Cap
BNT 0277	Spacer (B)
BNT 0291	Side Plate Screw
BNT 0306	Handle Nut
BNT 0345	Drive Shaft Washer "B"
BNT 0356	Worm Bearing "A"
BNT 0358	Pawl Cap
BNT 0425	Clutchbutton Lock
BNT 0489	Key Washer "A"
BNT 0490	Drag Washer
BNT 0492	Key Washer "B"
BNT 0493	Anti-Reverse Ratchet
BNT 0583	Drive Shaft Bearing
BNT 0584	Left Side Plate Bolt "C"
BNT 0586	Bolt Retainer
BNT 0587	Left Side Plate Bolt "A"
BNT 0588	Spool Shaft Bushing
BNT 0589	Flipping Lever Screw

PART # DESCRIPTION

BNT 0590	Lock Washer
BNT 0591	Flipping Lever
BNT 0597	Retractor Spring Guide
BNT 0598	Bushing
BNT 0600	Idle Gear
BNT 0602	Drive Shaft Washer "C"
BNT 0604	Yoke Spring
BNT 0605	Yoke
BNT 0607	Switch Spring Pin
BNT 0608	Switch Spring
BNT 0609	Drive Shaft Retainer Screw
BNT 0610	Drive Shaft Retainer
BNT 0611	Drive Shaft Bushing
BNT 0612	Anti-Reverse Pawl Pin
BNT 0615	Bearing Retainer
BNT 0616	Line Guide
BNT 0618	Worm Shaft
BNT 0619	Level Wind Guard
BNT 0620	Stabilizer Bar
BNT 0621	Worm Bearing "B"
BNT 0623	Dial Case Screw
BNT 0624	Screw Support
BNT 0629	Anti-Reverse Switch
BNT 0631	Cam Spring
BNT 0632	Flipping Cam
BNT 0633	Joint Plate
BNT 0634	Retractor Spring
BNT 0635	Drive Gear
BNT 0637	Pinion Gear
BNT 0638	Clutch Button

PART # DESCRIPTION

BNT 0639	Anti-Reverse Pawl
BNT 0641	Thumb Rest
BNT 0657	Clutch Button Guide Pin
BNT 0658	Flipping Retractor Spring
BNT 0660	Spring Spacer
BNT 0661	Magnet Retainer Spring
BNT 0701	Thrust Washer Spacer (Optional)
BNT 0702	Dial "O" Ring
BNT 0706	Magnet Retainer
BNT 0708	Magnet Control Dial
BNT 0711	Dial Case
BNT 0720	Handle Nut Plate Screw
BNT 0721	Handle Nut Plate
BNT 0722	Handle Assembly
BNT 0723	Friction Washer "A"
BNT 0726	Pre-Set Spring
BNT 0727	Strike
BNT 0728	Pre-Set Washer
BNT 0729	Strike Spring
BNT 0730	Strike Ball
BNT 0738	Pre-Set Dial
BNT 0739	Pre-Set Nut
BNT 0740	Star Drag
BNT 0741	Drive Shaft Cam
BNT 0742	Left Side Plate
BNT 0743	Drive Shaft
BNT 0744	One-Piece Frame
BNT 0745	Spool
BNT 0746	Right Side Plate

Prices and specifications subject to change without notice.

OCTOBER, 1987