

# SHIMANO®

## 1996 Repair Supplement

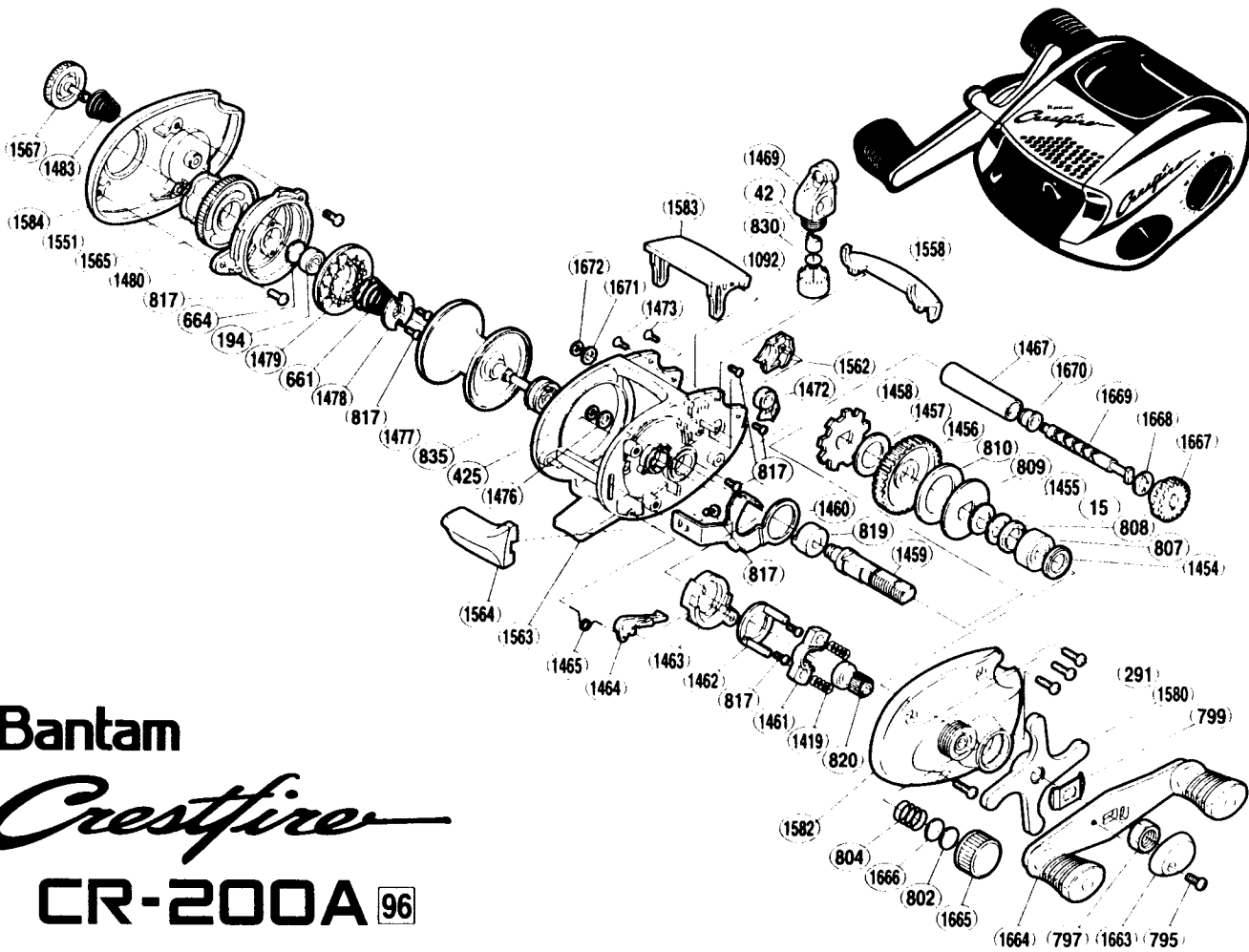

### Bantam

# *Crestfire*

## CR-200A 96

#### CR200A

Part #	Description	Part #	Description	Part #	Description
BNT0015	Drag Spring Washer	BNT1419	Yoke Spring	BNT1483	Lock Spring
BNT0042	Line Guide Pawl	BNT1454	Bearing Bushing	BNT1551	Dial Friction Washer
BNT0194	Ball Bearing	BNT1455	Drag Spring Washer	BNT1558	Level Wind Protector
BNT0291	Right Side Plate Screw	BNT1456	Drive Gear	BNT1562	Drive Shaft Cover
BNT0425	Drive Gear Retainer	BNT1457	Drive Shaft Washer (B)	BNT1563	One-Piece Frame
BNT0661	Magnet Retainer Spring	BNT1458	Anti-Reverse Ratchet	BNT1564	Quick-Fire II Clutch Bar
BNT0664	Spacer (B)	BNT1459	Drive Shaft	BNT1565	Magnetic Control Dial
BNT0795	Handle Nut Plate Screw	BNT1460	Clutch Plate	BNT1567	Lock Screw Cap
BNT0797	Handle Nut	BNT1461	Yoke	BNT1580	Star Drag
BNT0802	Spool Tension Spacer (B)	BNT1462	Clutch Cam Retainer	BNT1582	Right Side Plate
BNT0804	Spool Tension Spring	BNT1463	Clutch Cam	BNT1583	Thumb Rest
BNT0799	Friction Washer	BNT1464	Clutch Pawl	BNT1584	Left Side Plate
BNT0807	Drive Shaft Bearing	BNT1465	Clutch Pawl Spring	BNT1663	Handle Nut Plate
BNT0808	Friction Washer (B)	BNT1467	Level Wind Guard	BNT1664	Handle Assembly
BNT0809	Key Washer	BNT1469	Line Guide	BNT1665	Cast Control Cap
BNT0810	Drag Washer	BNT1472	Anti-Reverse Pawl	BNT1666	Spool Tension Spacer (A)
BNT0817	Multi-Purpose Screw	BNT1473	Multi-Purpose Screw	BNT1667	Worm Gear
BNT0819	Drive Shaft Bushing	BNT1476	Drive Shaft Washer (D)	BNT1668	Worm Shaft Washer (A)
BNT0820	Pinion Gear	BNT1477	Spool	BNT1669	Worm Shaft
BNT0830	Spacer (optional)	BNT1478	Magnet Holder	BNT1670	Worm Bushing
BNT 0835	Spool Shaft Bushing (B)	BNT1479	Magnet Retainer	BNT1671	Worm Shaft Washer (B)
BNT 1092	Pawl Cap	BNT1480	Dial Case	BNT1672	"E" Lock