

## BANTAM® MAGNUMLITE® 1500X PLUS

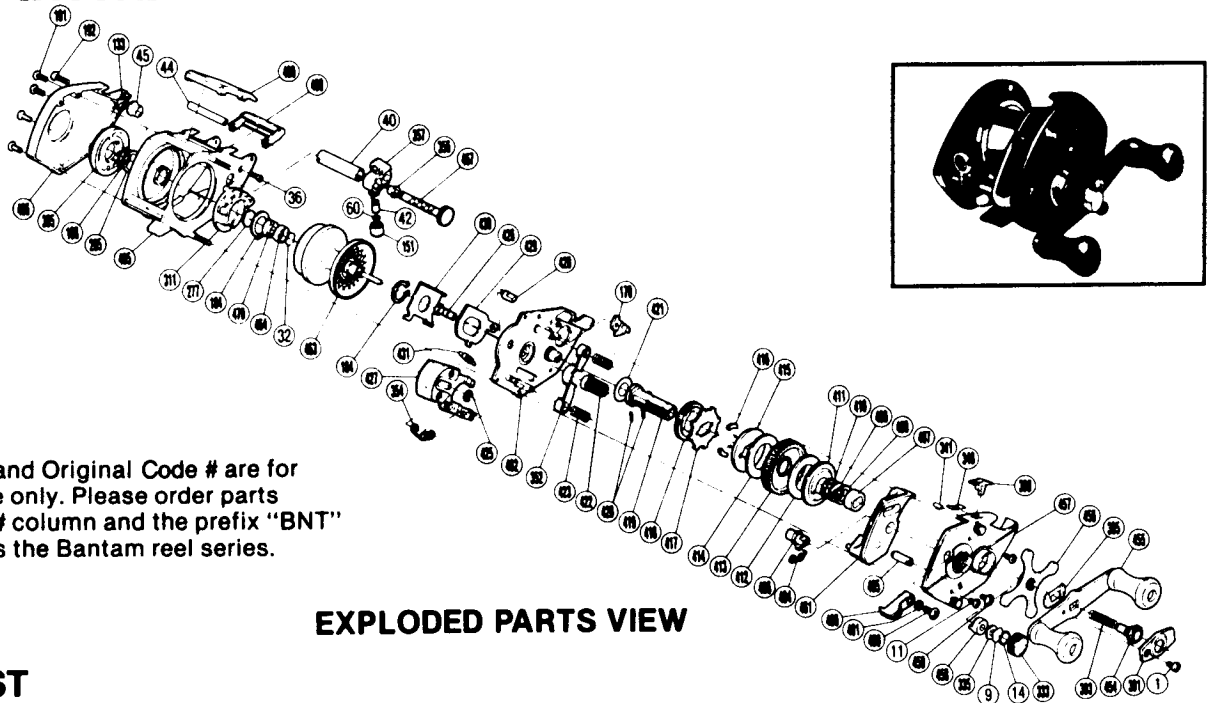

### TO ORDER:

Original Key # and Original Code # are for cross-reference only. Please order parts using the Part # column and the prefix "BNT" which indicates the Bantam reel series.

### EXPLODED PARTS VIEW

### PARTS LIST

PART #	ORIGINAL KEY #	ORIGINAL CODE #	DESCRIPTION	PART #	ORIGINAL KEY #	ORIGINAL CODE #	DESCRIPTION
1.	1.	7-0014 30100S	Handle Screw "B"	422.	42.	6-1729 06710S	Pinion Gear Assembly
391.	2.	7-2124 06710S	Handle Screw Lock Plate	423.	43.	7-1817 06710S	Yoke Spring
454.	3.	7-2123 06730S	Handle Screw "A"	352.	44.	7-1816 06700S	Yoke
393.	4.	7-2166 06710S	Drive Shaft Spring	462.	45.	6-1809 06730S	Set Plate Assembly
455.	5.	6-2129 06710S	Handle Assembly	354.	46.	7-1821 06700S	Retractor Spring
395.	6.	7-2116 06710S	Friction Washer "A"	425.	47.	7-1861 06100S	Clutch Button Lock
456.	7.	6-2119 06730S	Star Drag Assembly	426.	48.	7-1833 06710S	Fight'n Lever Cam
457.	8.	6-2019 06730S	Right Side Plate Assembly	427.	49.	6-1813 06700S	Clutch Button
398.	9.	7-1850 06710S	Anti-Reverse Switch	428.	50.	7-1894 06710S	Slide Cam
340.	10.	7-1852 06700S	Switch Spring	429.	51.	7-1891 06710S	Slide Plate
341.	11.	7-1413 01100S	Switch Spring Lock	430.	52.	7-1892 06710S	Slide Plate Cover
333.	12.	7-2010 06700S	Cast Control Cap	431.	53.	7-1893 06710S	Slide Plate Spring
14.	13.	7-2111 06100S	Right Bearing Spacer	463.	54.	7-1701 06730S	Spool Assembly
9.	14.	7-2060 06100S	Cast Control Spacer	32.	55.	7-1516 06100S	Bearing Retainer
335.	15.	7-2066 06700S	Right Bearing Washer	464.	56.	7-1599 06120S	Bearing Spacer
458.	16.	7-2051 06730S	Bushing "A"	184.	57.	7-0040 50700S	Magnet Retainer Lock
459.	17.	7-0013 00530S	Retractor Guide Screw	277.	58.	7-1515 06370S	Left Bearing Spacer
11.	18.	7-0013 00500S	Right Side Plate Screw	311.	59.	7-1593 06440S	Magnet Retainer Assembly
400.	19.	7-0013 403110	Fight'n Lever Screw	465.	60.	6-1509 06730S	Frame Assembly
401.	20.	7-0023 30110S	Fight'n Lever Screw Washer	265.	61.	7-0020 90300S	Thrust Washer Spacer (Optional)
460.	21.	7-2045 06710S	Fight'n Lever	188.	62.	7-2005 06100S	O Ring
461.	22.	7-2030 06730S	Clutch Button Attachment	365.	63.	7-1442 06700S	Magnetic Control Dial
404.	23.	7-2046 06710S	Joint Cam Yoke Spring	466.	64.	7-1401 06730S	Left Side Plate
405.	24.	7-2065 06710S	Retractor Guide	467.	65.	6-1609 06730S	Worm Shaft Assembly
406.	25.	7-2044 06710S	Joint Cam Yoke	356.	66.	7-1605 06700S	Worm Bearing "A"
407.	26.	7-2113 06710S	Bushing "B"	357.	67.	6-1619 06700S	Line Guide Assembly
408.	27.	7-2111 06710S	Friction Washer "B"	40.	68.	7-1606 06100S	Level Wind Guard
409.	28.	7-2112 06710S	Drag Spring Washer	151.	69.	7-1612 06000S	Pawl Cap
410.	29.	7-2110 06710S	Friction Washer "C"	60.	70.	7-1431 06100S	Line Guide Pawl Washer (Optional)
411.	30.	7-2108 06710S	Key Washer "A"	42.	71.	7-1602 06700S	Line Guide Pawl
412.	31.	7-2143 06710S	Drag Washer	36.	72.	7-0012 00100S	Right Stabilizer Bar Screw
413.	32.	7-2106 06710S	Drive Gear	468.	73.	7-1621 06730S	Level Wind Protector
414.	33.	7-2107 06700S	Drive Shaft Washer "B"	469.	74.	7-1507 06730S	Thumb Rest
415.	34.	7-2105 06710S	Key Washer "B"	44.	75.	7-1607 06100S	Stabilizer Bar
416.	35.	7-2170 06710S	Gear Protector Rubber	45.	76.	7-1601 06100S	Worm Bearing "B"
417.	36.	7-2103 06710S	Anti-Reverse Ratchet	133.	77.	7-1618 06000S	Worm Shaft Retainer
418.	37.	7-2157 06710S	Level Wind Drive Gear	192.	78.	7-0013 00600S	Left Stabilizer Bar Screw
419.	38.	6-2102 06710S	Drive Shaft	191.	79.	7-0013 00400S	Left Side Plate Screw
420.	39.	7-2167 06710S	Drive Shaft Lock	470.	80.	7-1517 06730S	Bushing "D"
421.	40.	7-2158 06710S	Drive Shaft Washer "A"				
170.	41.	7-1824 06700S	Anti-Reverse Pawl Assembly				