

SHIMANO®

1987 REPAIR MANUAL

Shimano American Corporation, One Shimano Dr.
Irvine, CA 92718

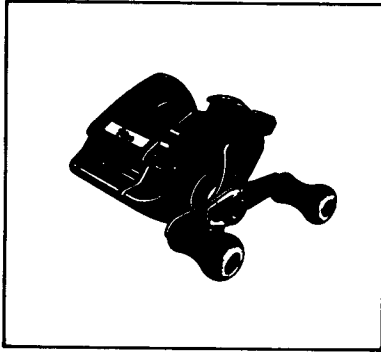

TO ORDER:

This reel belongs to the "Bantam" series.
Please order parts using the abbreviation
"BNT" and the part number.

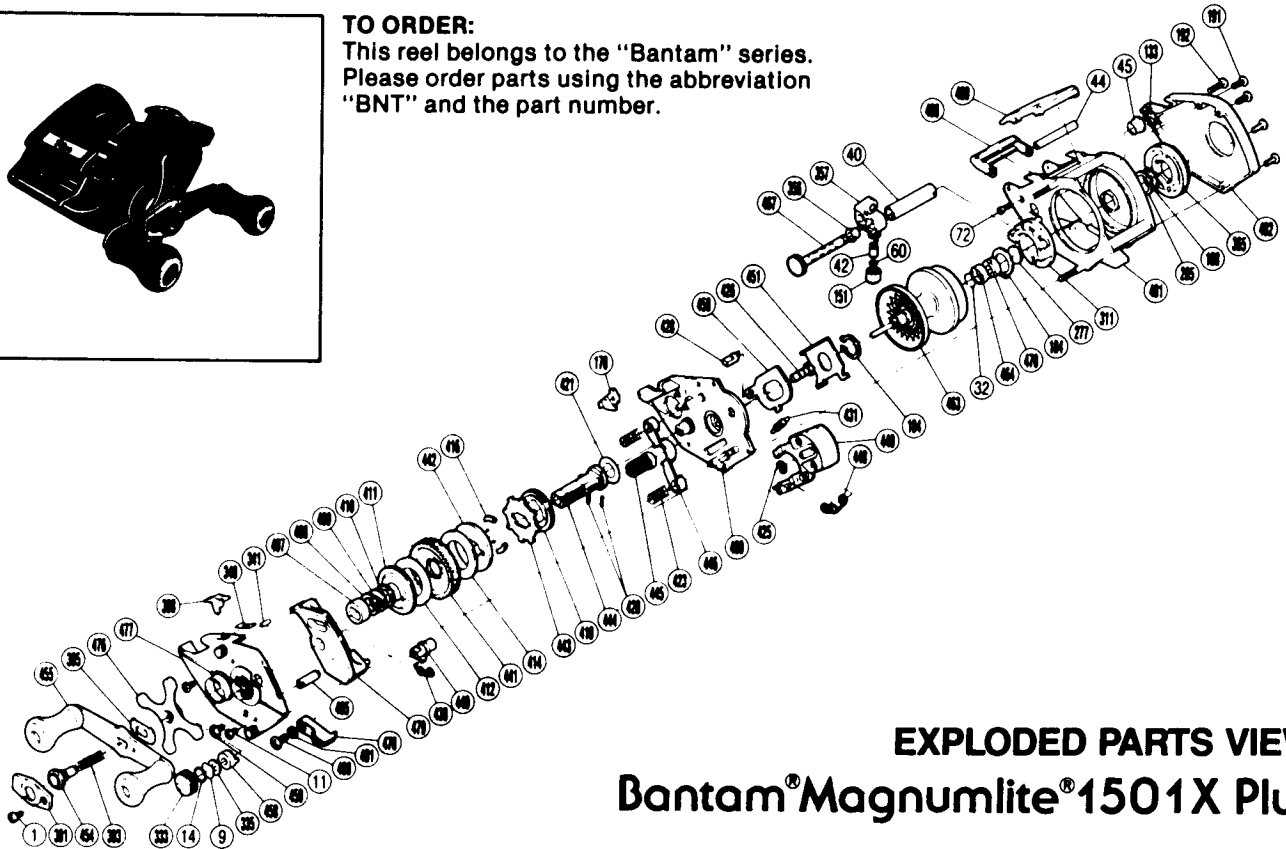

EXPLODED PARTS VIEW

Bantam® Magnumlite® 1501X Plus

PARTS LIST

PART # DESCRIPTION

- 1. Handle Screw "B"
- 9. Cast Control Spacer
- 11. Left Side Plate Screw
- 14. Left Bearing Spacer
- 32. Bearing Retainer
- 36. Left Stabilizer Bar Screw
- 40. Level Wind Guard
- 42. Line Guide Pawl
- 44. Stabilizer Bar
- 45. Worm Bearing "B"
- 60. Line Guide Pawl Washer (Optional)
- 133. Worm Shaft Retainer
- 151. Pawl Cap
- 170. Anti-Reverse Pawl Assembly
- 184. Magnet Retainer Lock
- 188. O Ring
- 191. Right Side Plate Screw
- 192. Right Stabilizer Bar Screw
- 265. Thrust Washer Spacer (Optional)
- 277. Right Bearing Spacer
- 311. Magnet Retainer Assembly
- 333. Cast Control Cap
- 335. Left Bearing Washer
- 340. Switch Spring
- 341. Switch Spring Lock

PART # DESCRIPTION

- 356. Worm Bearing "A"
- 357. Line Guide Assembly
- 365. Magnetic Control Dial
- 391. Handle Screw Lock Plate
- 393. Drive Shaft Spring
- 395. Friction Washer "A"
- 398. Anti-Reverse Switch
- 400. Fightin' Lever Screw
- 401. Fightin' Lever Screw Washer
- 405. Retractor Guide
- 407. Bushing "B"
- 408. Friction Washer "B"
- 409. Drag Spring Washer
- 410. Friction Washer "C"
- 411. Key Washer "A"
- 412. Drag Washer
- 414. Drive Shaft Washer "B"
- 416. Gear Protector Rubber
- 418. Level Wind Drive Gear
- 420. Drive Shaft Lock
- 421. Drive Shaft Washer "A"
- 423. Yoke Spring
- 425. Clutch Button Lock
- 426. Fightin' Lever Cam
- 428. Slide Cam
- 431. Slide Plate Spring
- 439. Joint Cam Yoke Spring

PART # DESCRIPTION

- 440. Joint Cam Yoke
- 441. Drive Gear
- 442. Key Washer "B"
- 443. Anti-Reverse Ratchet
- 444. Drive Shaft
- 445. Pinion Gear Assembly
- 446. Yoke
- 448. Retractor Spring
- 449. Clutch Button
- 450. Slide Plate
- 451. Slide Plate Cover
- 454. Handle Screw "A"
- 455. Handle Assembly
- 458. Bushing "A"
- 459. Retractor Guide Screw
- 463. Spool Assembly
- 464. Bearing Spacer
- 467. Worm Shaft Assembly
- 468. Level Wind Protector
- 469. Thumb Rest
- 470. Bushing "D"
- 476. Star Drag Assembly
- 477. Left Side Plate Assembly
- 478. Fightin' Lever
- 479. Clutch Button Attachment
- 480. Set Plate Assembly
- 481. Frame Assembly
- 482. Right Side Plate