

Shimano American Corporation, One Shimano Dr.  
Irvine, CA 92718

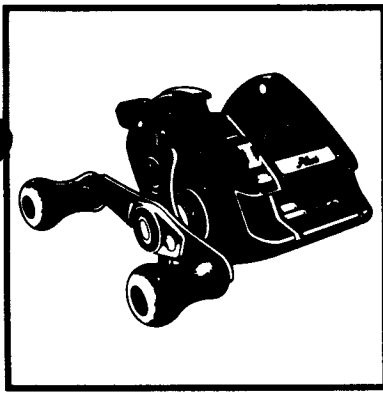

### EXPLODED PARTS VIEW

Bantam  
*Magnumite 2001GT Plus*

◆ Please check the head of the "Magnetic Control Dial" here to see whether you have an old or new-type reel.

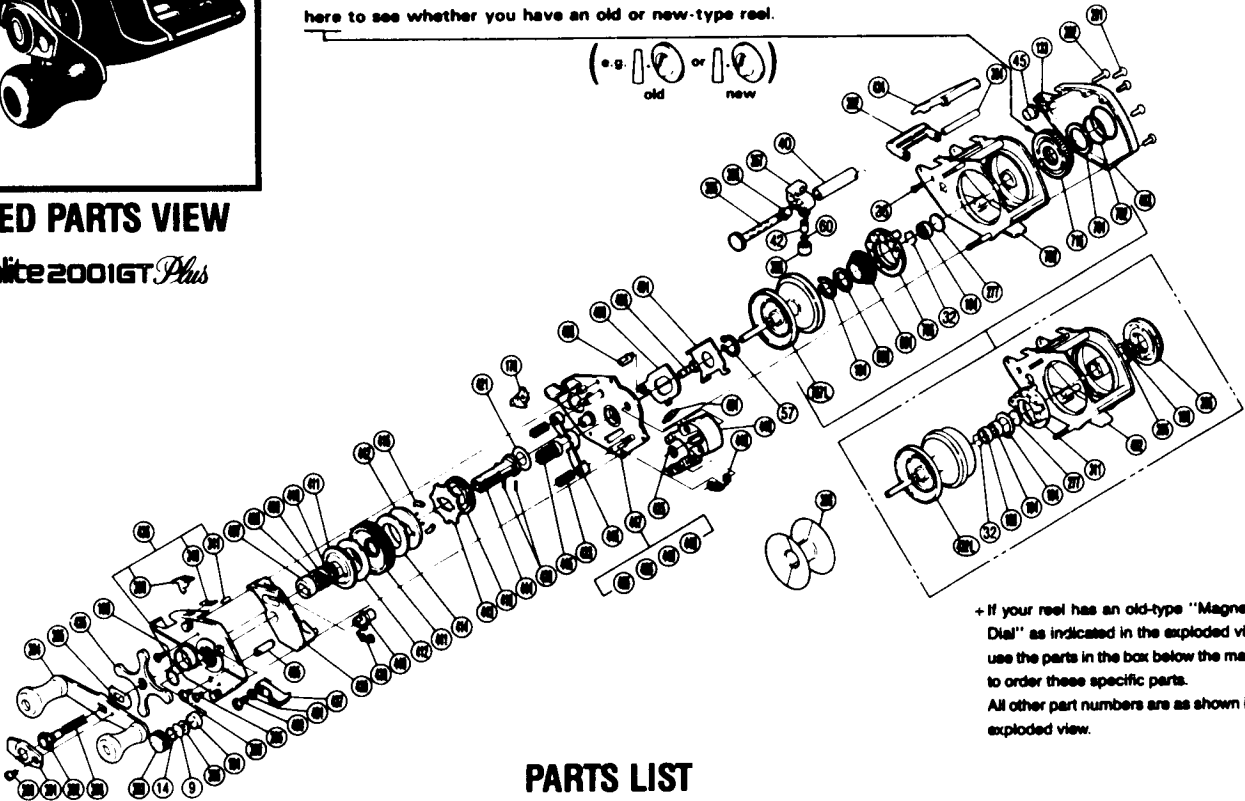
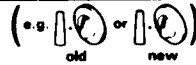

+ If your reel has an old-type "Magnetic Control Dial" as indicated in the exploded view, please use the parts in the box below the main diagram to order these specific parts. All other part numbers are as shown in the main exploded view.

### PARTS LIST

#### PART # DESCRIPTION

BNT 0009 Spacer (A)  
BNT 0014 Friction Washer (B)  
BNT 0032 Bearing Retainer  
BNT 0036 Stabilizer Bar Screw (A) (S)  
BNT 0040 Level Wind Guard  
BNT 0042 Line Guide Pawl  
BNT 0045 Worm Bearing (B)  
BNT 0060 Spacer (Optional)  
BNT 0133 Worm Shaft Retainer  
BNT 0170 Anti-Reverse Pawl (Assembly)  
BNT 0184 Magnet Retainer Lock  
BNT 0188 O Ring  
BNT 0194 Ball Bearing  
BNT 0198 Bearing Spacer  
BNT 0265 Spacer (Optional)  
BNT 0277 Spacer (B)  
BNT 0280 Handle Screw "B"  
BNT 0285 Set Plate Screw  
BNT 0291 Side Plate Screw  
BNT 0292 Stabilizer Bar Screw (B)  
BNT 0311 Magnet Retainer (Assembly)  
BNT 0328 V Spool Converter  
BNT 0333 Cast Control Cap  
BNT 0335 Bearing Washer (A)  
BNT 0340 Switch Spring  
BNT 0341 Switch Spring Lock  
BNT 0355 Worm Shaft Assembly  
BNT 0356 Worm Bearing "A"  
BNT 0357 Line Guide (Assembly)  
BNT 0358 Pawl Cap

#### PART # DESCRIPTION

BNT 0362 Level Wind Protector  
BNT 0364 Stabilizer Bar  
BNT 0365 Magnetic Control Dial  
BNT 0391 Handle Screw Lock Plate  
BNT 0392 Handle Screw "A"  
BNT 0393 Drive Shaft Spring  
BNT 0394 Handle Assembly  
BNT 0395 Friction Washer "A"  
BNT 0398 Anti-Reverse Switch  
BNT 0399 Retractor Guide Screw (Large Head)  
BNT 0400 Fightin' Lever Screw  
BNT 0401 Fightin' Lever Screw Washer  
BNT 0405 Retractor Guide  
BNT 0407 Bushing "B"  
BNT 0408 Friction Washer "B"  
BNT 0409 Drag Spring Washer  
BNT 0410 Friction Washer "C"  
BNT 0411 Key Washer "A"  
BNT 0412 Drag Washer  
BNT 0414 Drive Shaft Washer "B"  
BNT 0416 Gear Protector Rubber  
BNT 0418 Level Wind Drive Gear  
BNT 0420 Drive Shaft Lock  
BNT 0421 Drive Shaft Washer "A"  
BNT 0423 Yoke Spring  
BNT 0425 Clutchbutton Lock  
BNT 0426 Fightin' Lever Cam  
BNT 0428 Slide Cam  
BNT 0431 Slide Plate Spring

#### PART # DESCRIPTION

BNT 0432L Spool Assembly  
BNT 0434 Thumb Rest  
BNT 0435 Star Drag Assembly  
BNT 0436 Right Side Plate Assembly  
BNT 0437 Fightin' Lever  
BNT 0438 Clutch Button Attachment  
BNT 0439 Joint Cam Yoke Spring  
BNT 0440 Joint Cam Yoke  
BNT 0441 Drive Gear  
BNT 0442 Key Washer "B"  
BNT 0443 Anti-Reverse Ratchet  
BNT 0444 Drive Shaft  
BNT 0445 Pinion Gear Assembly  
BNT 0446 Yoke  
BNT 0447 Set Plate Assembly  
BNT 0448 Retractor Spring  
BNT 0449 Clutch Button  
BNT 0450 Slide Plate  
BNT 0451 Slide Plate Cover  
BNT 0452 Frame Assembly  
BNT 0453 Left Side Plate  
BNT 0660 Spring Spacer  
BNT 0661 Magnet Retainer Spring  
BNT 0701 Thrust Washer Spacer (Optional)  
BNT 0702 Dial O Ring  
BNT 0706 Magnet Retainer  
BNT 0716 Magnet Control Dial  
BNT 0767L Spool Assembly  
BNT 0769 Frame Assembly