

If your reel has an old-type "Magnetic Control Dial" as indicated in the exploded view, please use the parts in the box below the main diagram to order these specific parts.
All other part numbers are as shown in the main exploded view

SHIMANO[®]

1988 REPAIR MANUAL

Shimano American Corporation, One Shimano Dr.
Irvine, CA 92718

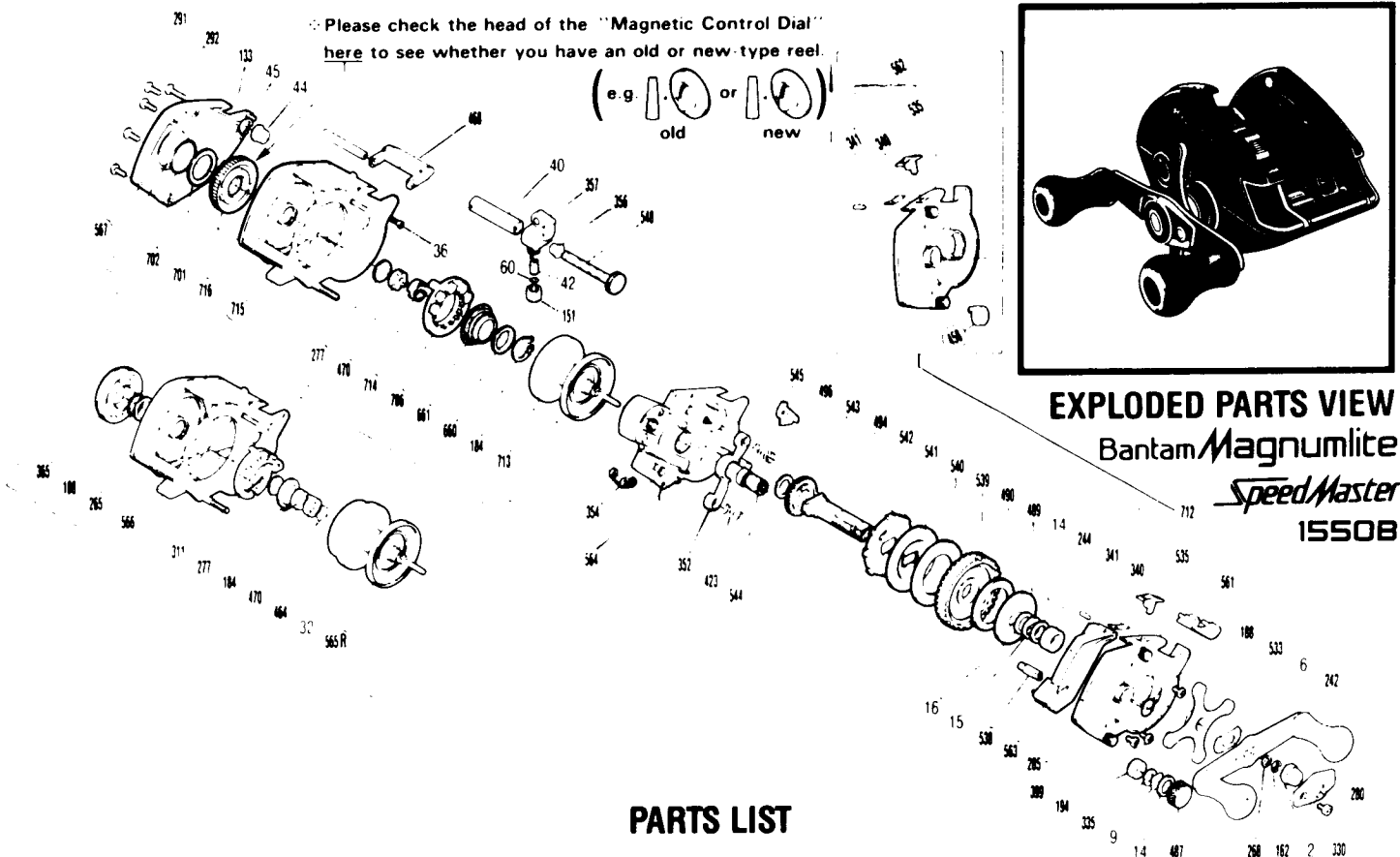

EXPLODED PARTS VIEW
Bantam Magnumlite
Speed Master
1550B

PARTS LIST

PART # DESCRIPTION

BNT 0002 Handle Nut
BNT 0006 Friction Washer (A)
BNT 0009 Spacer (A)
BNT 0014 Friction Washer (B)
BNT 0015 Drag Spring Washer
BNT 0016 Friction Washer (C)
BNT 0032 Bearing Retainer
BNT 0036 Stabilizer Bar Screw (A) (S)
BNT 0040 Level Wind Guard
BNT 0042 Line Guide Pawl
BNT 0044 (Line Guide) Stabilizer Bar
BNT 0045 Worm Bearing (B)
BNT 0060 Spacer (Optional)
BNT 0133 Worm Shaft Retainer
BNT 0151 Pawl Cap
BNT 0162 Drive Shaft Retainer
BNT 0184 Magnet Retainer Lock
BNT 0188 O Ring
BNT 0194 Ball Bearing
BNT 0242 Handle (Assembly)
BNT 0244 Bushing (B)
BNT 0265 Spacer (Optional)
BNT 0268 Drive Shaft Washer (A)
BNT 0277 Spacer (B)
BNT 0280 Handle Screw "B"
BNT 0285 Set Plate Screw
BNT 0291 Side Plate Screw

PART # DESCRIPTION

BNT 0292 Stabilizer Bar Screw (B)
BNT 0311 Magnet Retainer (Assembly)
BNT 0330 Handle Nut (Lock) Plate
BNT 0335 Bearing Washer (A)
BNT 0340 Switch Spring
BNT 0341 Switch Spring Lock
BNT 0352 (Pinion) Yoke
BNT 0354 Retractor Spring
BNT 0356 Worm Bearing "A"
BNT 0357 Line Guide (Assembly)
BNT 0365 Magnetic Control Dial
BNT 0399 Retractor Guide Screw (Large Head)

BNT 0423 Yoke Spring
BNT 0458 Bushing "A"
BNT 0464 Bearing Spacer
BNT 0468 Level Wind Protector
BNT 0470 Bushing "C"
BNT 0487 Cast Control Cap
BNT 0489 Key Washer "A"
BNT 0490 Drag Washer
BNT 0494 Drive Shaft
BNT 0496 Drive Shaft Washer "C"
BNT 0533 Star Drag
BNT 0535 Anti-Reverse Switch
BNT 0538 Retractor Guide
BNT 0539 Drive Gear

PART # DESCRIPTION

BNT 0540 Drive Shaft Washer "B"
BNT 0541 Key Washer "B"
BNT 0542 Anti-Reverse Ratchet
BNT 0543 Idle Gear
BNT 0544 Pinion Gear
BNT 0545 Anti-Reverse Pawl
BNT 0548 Worm Shaft
BNT 0561 Right Side Plate Cover
BNT 0562 Right Side Plate
BNT 0563 Clutch Button Attachment
BNT 0564 Set Plate Assembly
BNT 0565R Spool (Right Handle)
BNT 0566 Frame
BNT 0567 Left Side Plate
BNT 0660 Spring Spacer
BNT 0661 Magnet Retainer Spring
BNT 0701 Thrust Washer Spacer (Optional)
BNT 0702 Dial O Ring
BNT 0706 Magnet Retainer
BNT 0712 Right Side Plate
BNT 0713 Spool
BNT 0714 Bushing Retainer
BNT 0715 Frame
BNT 0716 Magnet Control Dial