

EXPLODED PARTS VIEW
Bantam *Magnumlite*
Speed Master 2200FS

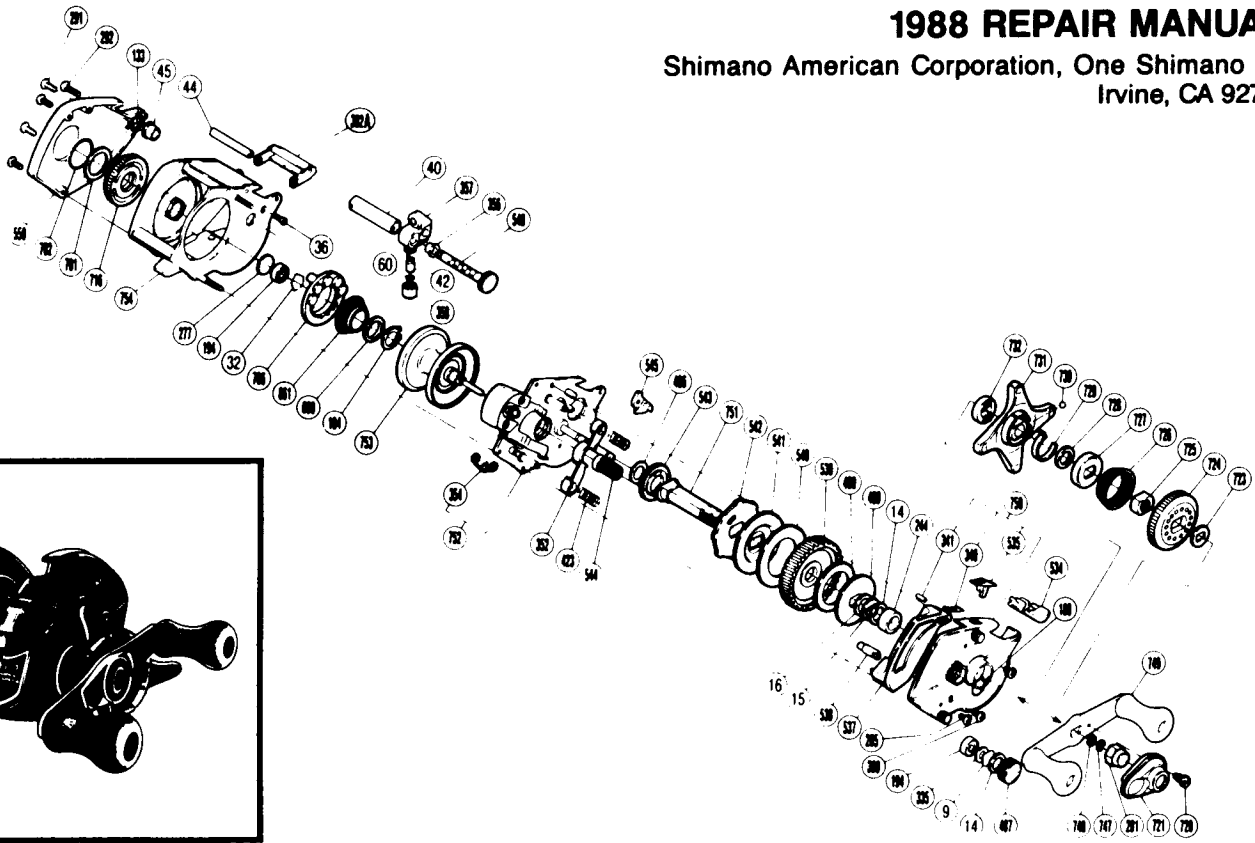

PARTS LIST

PART # DESCRIPTION

| | |
|----------|------------------------------|
| BNT 0009 | Spacer (A) |
| BNT 0014 | Friction Washer (B) |
| BNT 0015 | Drag Spring Washer |
| BNT 0016 | Friction Washer (C) |
| BNT 0032 | Bearing Retainer |
| BNT 0036 | Stabilizer Bar Screw (A) (S) |
| BNT 0040 | Level Wind Guard |
| BNT 0042 | Line Guide Pawl |
| BNT 0044 | (Line Guide) Stabilizer Bar |
| BNT 0045 | Worm Bearing (B) |
| BNT 0060 | Spacer (Optional) |
| BNT 0133 | Worm Shaft Retainer |
| BNT 0184 | Magnet Retainer Lock |
| BNT 0188 | O Ring |
| BNT 0194 | Ball Bearing |
| BNT 0244 | Bushing (B) |
| BNT 0277 | Spacer (B) |
| BNT 0281 | Handle Nut |
| BNT 0285 | Set Plate Screw |
| BNT 0291 | Side Plate Screw |
| BNT 0292 | Stabilizer Bar Screw (B) |
| BNT 0335 | Bearing Washer (A) |
| BNT 0340 | Switch Spring |
| BNT 0341 | Switch Spring Lock |
| BNT 0352 | (Pinion) Yoke |
| BNT 0354 | Retractor Spring |

PART # DESCRIPTION

| | |
|-----------|------------------------------------|
| BNT 0356 | Worm Bearing "A" |
| BNT 0357 | Line Guide (Assembly) |
| BNT 0358 | Pawl Cap |
| BNT 0362A | Level Wind Protector |
| BNT 0399 | Retractor Guide Screw (Large Head) |
| BNT 0423 | Yoke Spring |
| BNT 0487 | Cast Control Cap |
| BNT 0489 | Key Washer "A" |
| BNT 0490 | Drag Washer |
| BNT 0496 | Drive Shaft Washer "C" |
| BNT 0534 | Right Side Platecover |
| BNT 0535 | Anti-Reverse Switch |
| BNT 0537 | Clutch Button Attachment |
| BNT 0538 | Retractor Guide |
| BNT 0539 | Drive Gear |
| BNT 0540 | Drive Shaft Washer "B" |
| BNT 0541 | Key Washer "B" |
| BNT 0542 | Anti-Reverse Ratchet |
| BNT 0543 | Idle Gear |
| BNT 0544 | Pinion Gear |
| BNT 0545 | Anti-Reverse Pawl |
| BNT 0548 | Worm Shaft |
| BNT 0550 | Left Side Plate |
| BNT 0660 | Spring Spacer |
| BNT 0661 | Magnet Retainer Spring |

PART # DESCRIPTION

| | |
|----------|---------------------------------|
| BNT 0701 | Thrust Washer Spacer (Optional) |
| BNT 0702 | Dial O Ring |
| BNT 0706 | Magnet Retainer |
| BNT 0716 | Magnet Control Dial |
| BNT 0720 | Handle Nut Plate Screw |
| BNT 0721 | Handle Nut Plate |
| BNT 0723 | Friction Washer "A" |
| BNT 0724 | Pre-Set Dial |
| BNT 0725 | Pre-Set Nut |
| BNT 0726 | Pre-Set Spring |
| BNT 0727 | Strike |
| BNT 0728 | Pre-Set Washer |
| BNT 0729 | Strike Spring |
| BNT 0730 | Strike Ball |
| BNT 0731 | Star Drag |
| BNT 0732 | Drive Shaft Cam |
| BNT 0747 | Drive Shaft Retainer |
| BNT 0748 | Drive Shaft Washer "A" |
| BNT 0749 | Handle Assembly |
| BNT 0750 | Right Side Plate |
| BNT 0751 | Drive Shaft |
| BNT 0752 | Set Plate Assembly |
| BNT 0753 | Spool |
| BNT 0754 | Frame |