

# SHIMANO<sup>®</sup>

## 1988 REPAIR MANUAL

Shimano American Corporation, One Shimano Dr.  
Irvine, CA 92718

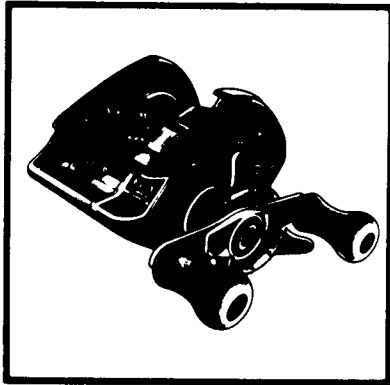

### EXPLODED PARTS VIEW

Bantam *Magnumlite*  
*SpeedMaster* 2200 MFS

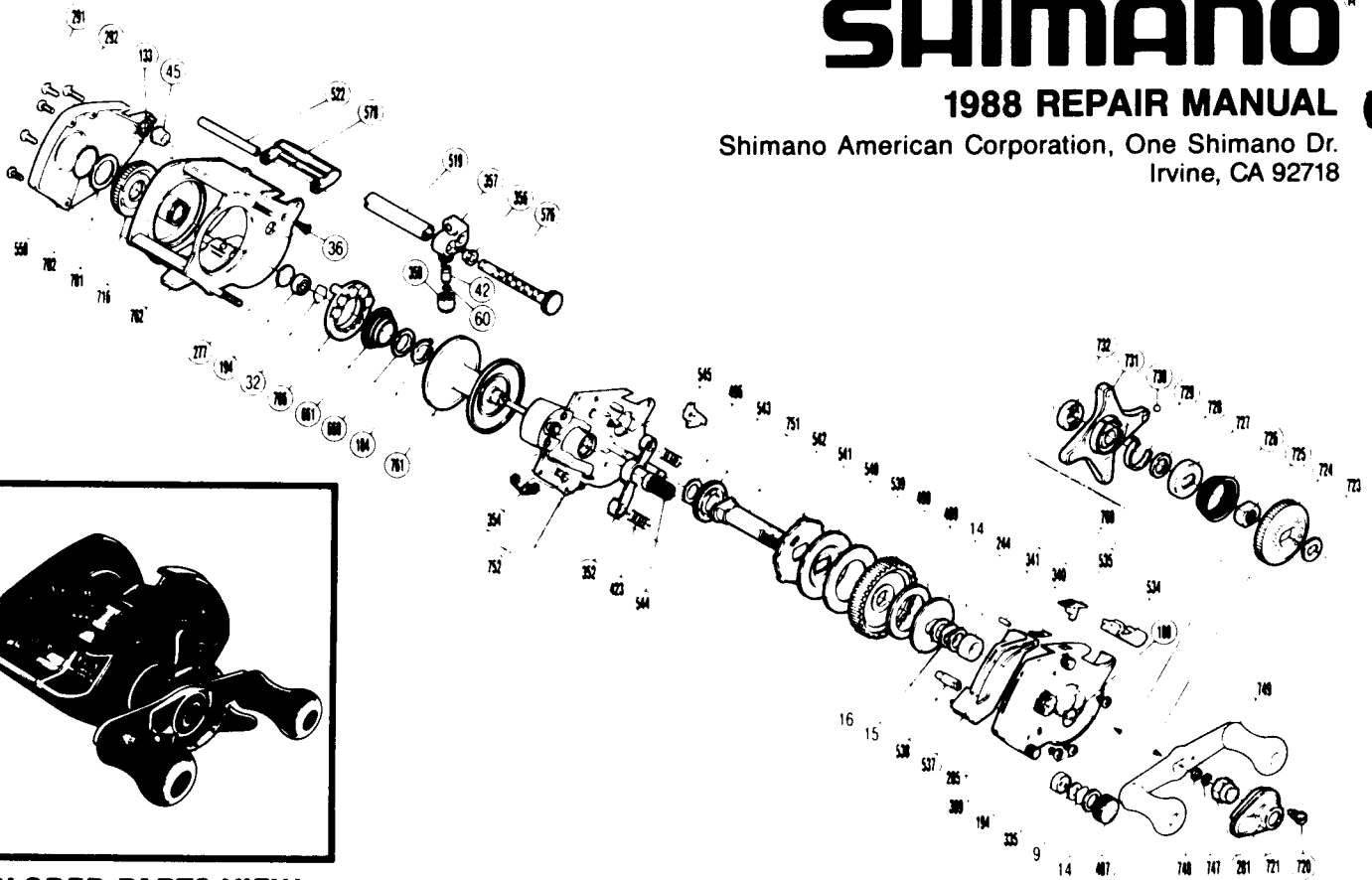

### PARTS LIST

#### PART # DESCRIPTION

BNT 0009	Spacer (A)
BNT 0014	Friction Washer (B)
BNT 0015	Drag Spring Washer
BNT 0016	Friction Washer (C)
BNT 0032	Bearing Retainer
BNT 0036	Stabilizer Bar Screw (A) (S)
BNT 0042	Line Guide Pawl
BNT 0045	Worm Bearing (B)
BNT 0060	Spacer (Optional)
BNT 0133	Worm Shaft Retainer
BNT 0184	Magnet Retainer Lock
BNT 0188	O Ring
BNT 0194	Ball Bearing
BNT 0244	Bushing (B)
BNT 0277	Spacer (B)
BNT 0281	Handle Nut
BNT 0285	Set Plate Screw
BNT 0291	Side Plate Screw
BNT 0292	Stabilizer Bar Screw (B)
BNT 0335	Bearing Washer (A)
BNT 0340	Switch Spring
BNT 0341	Switch Spring Lock
BNT 0352	(Pinion) Yoke
BNT 0354	Retractor Spring
BNT 0356	Worm Bearing "A"
BNT 0357	Line Guide (Assembly)

#### PART # DESCRIPTION

BNT 0358	Pawl Cap
BNT 0399	Retractor Guide Screw (Large Head)
BNT 0423	Yoke Spring
BNT 0487	Cast Control Cap
BNT 0489	Key Washer "A"
BNT 0490	Drag Washer
BNT 0496	Drive Shaft Washer "C"
BNT 0519	Level Wind Guard
BNT 0522	Stabilizer Bar
BNT 0534	Right Side Platecover
BNT 0535	Anti-Reverse Switch
BNT 0537	Clutch Button Attachment
BNT 0538	Retractor Guide
BNT 0539	Drive Gear
BNT 0540	Drive Shaft Washer "B"
BNT 0541	Key Washer "B"
BNT 0542	Anti-Reverse Ratchet
BNT 0543	Idle Gear
BNT 0544	Pinion Gear
BNT 0545	Anti-Reverse Pawl
BNT 0550	Left Side Plate
BNT 0576	Worm Shaft
BNT 0578	Level Wind Protector
BNT 0660	Spring Spacer
BNT 0661	Magnet Retainer Spring

#### PART # DESCRIPTION

BNT 0701	Thrust Washer Spacer (Optional)
BNT 0702	Dial O Ring
BNT 0706	Magnet Retainer
BNT 0716	Magnet Control Dial
BNT 0720	Handle Nut Plate Screw
BNT 0721	Handle Nut Plate
BNT 0723	Friction Washer "A"
BNT 0724	Pre-Set Dial
BNT 0725	Pre-Set Nut
BNT 0726	Pre-Set Spring
BNT 0727	Strike
BNT 0728	Pre-Set Washer
BNT 0729	Strike Spring
BNT 0730	Strike Ball
BNT 0731	Star Drag
BNT 0732	Drive Shaft Cam
BNT 0747	Drive Shaft Retainer
BNT 0748	Drive Shaft Washer "A"
BNT 0749	Handle Assembly
BNT 0751	Drive Shaft
BNT 0752	Set Plate Assembly
BNT 0760	Right Side Plate
BNT 0761	Spool
BNT 0762	Frame