

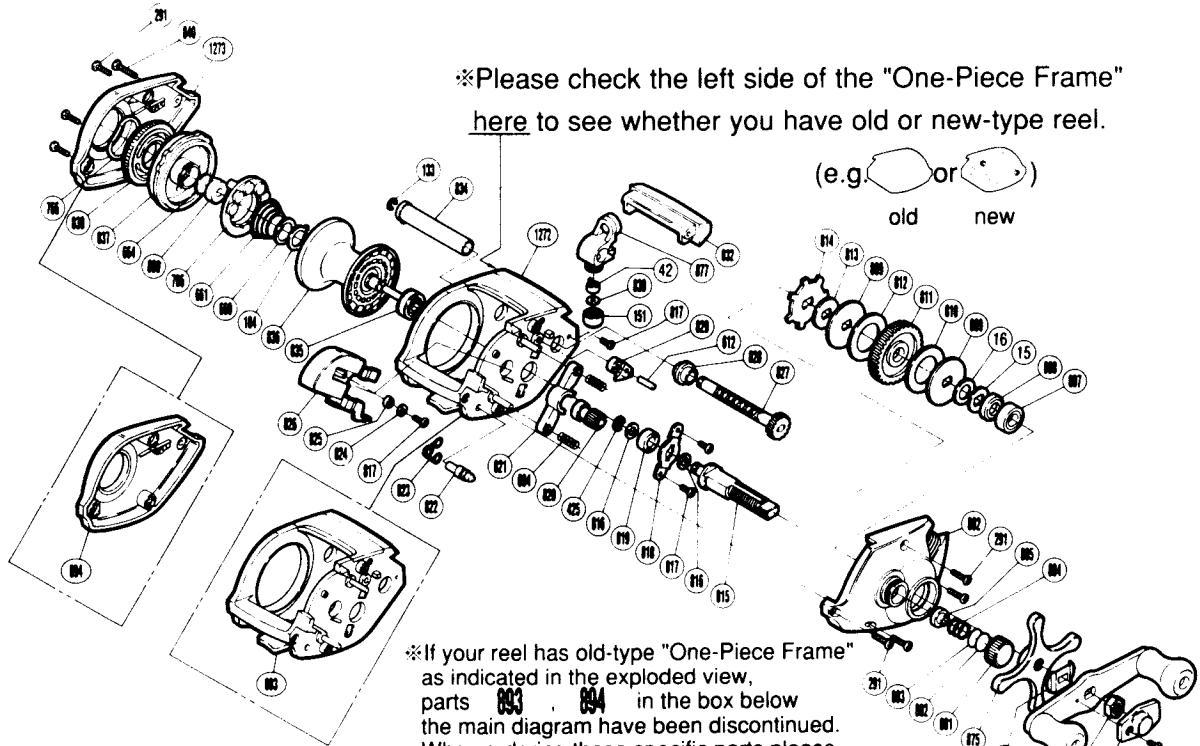

SHIMANO

1992 REPAIR MANUAL

Shimano American Corporation, One Shimano Dr.
Irvine, CA 92718



※Please check the left side of the "One-Piece Frame" here to see whether you have old or new-type reel.

(e.g.  or )
old new

※If your reel has old-type "One-Piece Frame" as indicated in the exploded view, parts 0893, 0894 in the box below the main diagram have been discontinued. When ordering these specific parts please order the assembly listed in diagram new numbers 1272, 1273. All other parts numbers are as shown in the exploded view.

Bantam
P-1500Mag 92

BNT No.	PARTS NAMES	BNT No.	PARTS NAMES	BNT No.	PARTS NAMES
0015	Drag Spring Washer	0808	Friction Washer (B)	0835	Spool Shaft Bushing (B)
0016	Friction Washer (C)	0809	Key Washer (A)	0836	Spool
0042	Line Guide Pawl	0810	Drag Washer (A)	0837	Dial Case
0133	Worm Shaft Retainer	0811	Drive Gear	0838	Magnetic Control Dial
0151	Pawl Cap	0812	Drag Washer (B)	0840	Left Side Plate Screw
0184	Magnet Retainer Lock	0813	Key Washer (B)	0853	Handle Assembly
0291	Side Plate Screw	0814	Anti-Reverse Ratchet	0875	Star Drag
0425	Drive Shaft Lock	0815	Drive Shaft	0877	Line Guide
0604	Yoke Spring	0816	Drive Shaft Washer	0880	Spool Shaft Bushing (C)
0612	Anti-Reverse Pawl Pin	0817	Multi Purpose Screw	0892	Right Side Plate
0660	Spring Spacer	0818	Drive Shaft Retainer	1272	One-Piece Frame
0661	Magnet Retainer Spring	0819	Drive Shaft Bushing	1273	Left Side Plate
0664	Spacer (B)	0820	Pinion Gear		
0706	Magnet Retainer	0821	Yoke		
0766	Dial Friction Washer	0822	Retractor Spring Pin		
0795	Handle Nut Plate Screw	0823	Retractor Spring		
0796	Handle Nut Plate	0824	Yoke Plate Washer (B)		
0797	Handle Nut	0825	Yoke Plate Washer (A)		
0799	Friction Washer (A)	0826	Clutch Button		
0801	Cast Control Cap	0827	Worm Shaft		
0802	Spool Tension Spacer (B)	0828	Worm Bearing		
0803	Spool Tension Spacer (A)	0829	Anti-Reverse Pawl		
0804	Spool Tension Spring	0830	Spacer (optional)		
0805	Spool Shaft Bushing (A)	0832	Level Wind Protector	0893	One Piece Frame
0807	Drive Shaft Bearing	0834	Level Wind Guard	0894	Left Side Plate

Prices and specifications subject to change without notice

(030514)