

SHIMANO®

1987 REPAIR MANUAL

Shimano American Corporation, One Shimano Dr.
Irvine, CA 92718

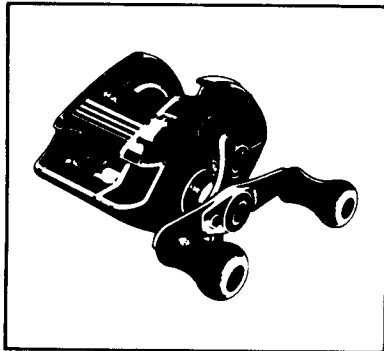

TO ORDER:

This reel belongs to the "Bantam" series.
Please order parts using the abbreviation
"BNT" and the part number.

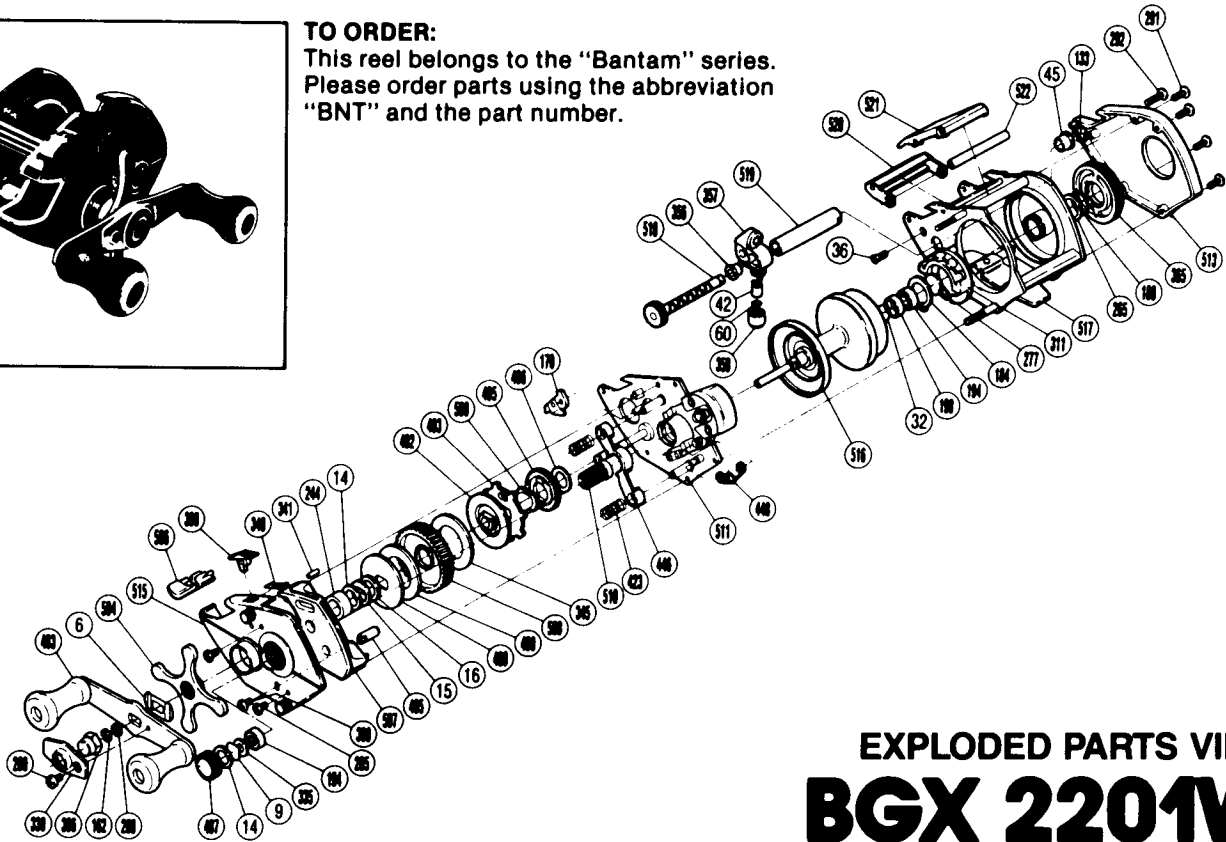

EXPLODED PARTS VIEW BGX 2201W

PARTS LIST

PART # DESCRIPTION

- 6. Friction Washer "A"
- 9. Cast Control Spacer
- 14. Friction Washer "B"
- 15. Drag Spring Washer
- 16. Friction Washer "C"
- 32. Bearing Retainer
- 36. Stabilizer Bar Screw "A"
- 42. Line Guide Pawl
- 45. Worm Bearing "B"
- 60. Spacer (optional)
- 133. Worm Shaft Retainer
- 162. Drive Shaft Retainer
- 170. Anti-Reverse Pawl
- 184. Magnet Retainer Lock
- 188. O Ring
- 194. Ball Bearing
- 198. Bearing Spacer
- 244. Bushing
- 265. Spacer (optional)
- 268. Drive Shaft Washer "A"
- 277. Bearing Spacer "B"
- 280. Handle Nut Plate Screw

PART # DESCRIPTION

- 285. Left Side Plate Screw
- 291. Right Side Plate Screw
- 292. Stabilizer Bar Screw "B"
- 306. Handle Nut
- 311. Magnet Retainer
- 330. Handle Nut Plate
- 335. Bearing Washer "A"
- 340. Switch Spring
- 341. Switch Spring Lock
- 345. Drive Shaft Washer "B"
- 356. Worm Bearing "A"
- 357. Line Guide
- 358. Pawl Cap
- 365. Magnetic Control Dial
- 398. Anti-Reverse Switch
- 399. Retractor Guide Screw
- 405. Retractor Guide
- 423. Yoke Spring
- 446. Yoke
- 448. Retractor Spring
- 483. Handle Assembly
- 487. Cast Control Cap

PART # DESCRIPTION

- 489. Key Washer "A"
- 490. Drag Washer
- 492. Key Washer "B"
- 493. Anti-Reverse Ratchet
- 495. Idle Gear
- 496. Drive Shaft Washer "C"
- 504. Star Drag
- 506. Right Side Plate Cover
- 507. Clutch Button Attachment
- 508. Drive Gear
- 509. Drive Shaft
- 510. Pinion Gear
- 511. Set Plate Assembly
- 513. Right Side Plate
- 515. Left Side Plate
- 516. Spool
- 517. Frame
- 518. Worm Shaft
- 519. Level Wind Guard
- 520. Level Wind Protector
- 521. Thumb Rest
- 522. Stabilizer Bar