

SHIMANO®

1992 REPAIR MANUAL

Shimano American Corporation, One Shimano Dr.
Irvine, CA 92718

※Please check this eared part of the "Dial Case"
here to see whether you have old or new-type reel.

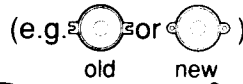

※If your reel has old-type "Dial Case"
as indicated in the exploded view,
parts 1147, 1149 in the box below
the main diagram have been discontinued.
When ordering these specific parts please
order the assembly listed in diagram new
numbers 1254, 1255.
All other parts numbers are as shown in
the exploded view.

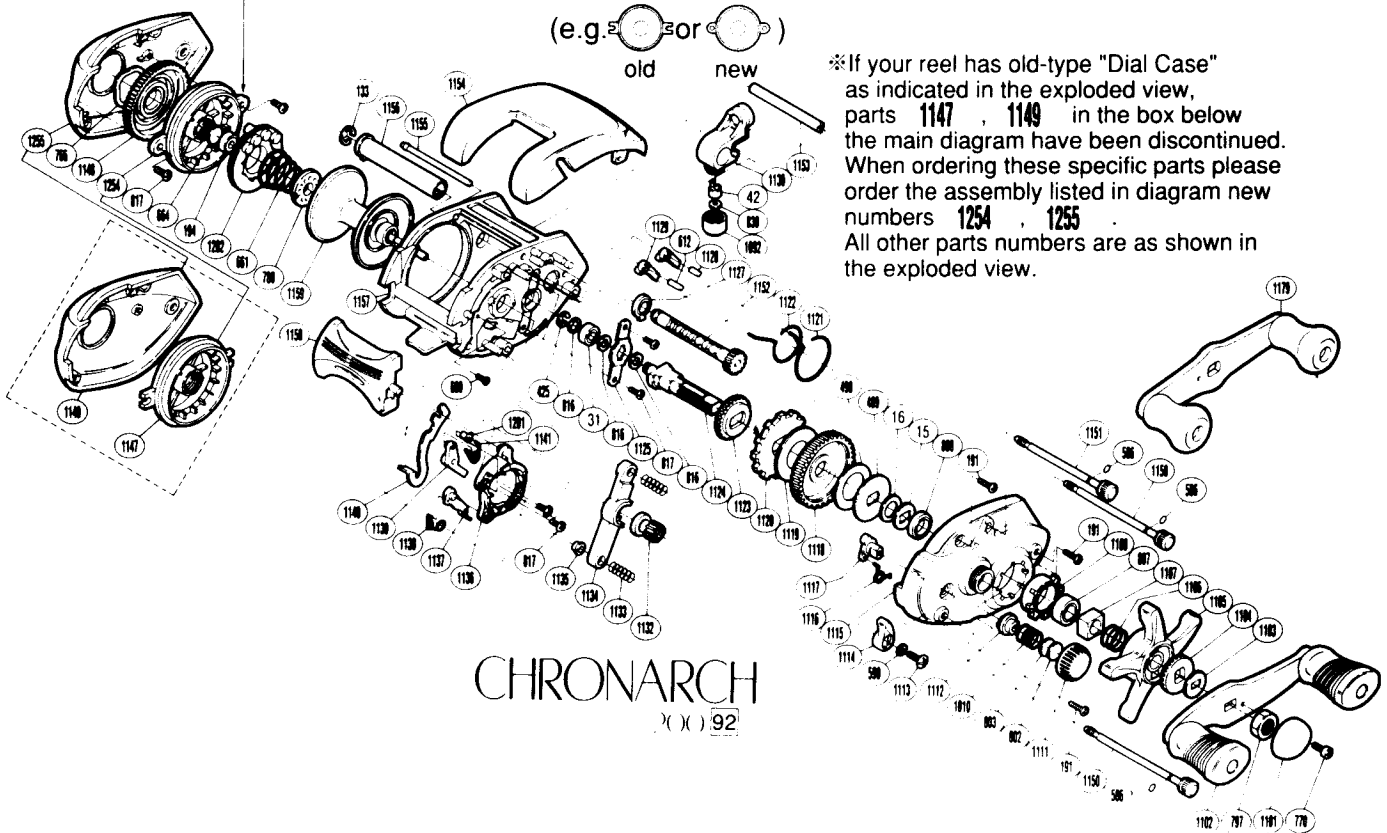

CHRONARCH
() 92

BNT No.	PARTS NAMES	BNT No.	PARTS NAMES	BNT No.	PARTS NAMES
0015	Drag Spring Washer	1102	Twin Power Handle Assembly	1136	Clutch Cam
0016	Friction Washer (C)	1103	Friction Washer (A)	1137	Clutch Pawl
0031	Drive Shaft Bearing (A)	1104	Click Gear	1138	Clutch Pawl Spring
0042	Line Guide Pawl	1105	Star Drag	1139	Joint Plate
0133	Worm Shaft Retainer	1106	Star Drag Spring	1140	Clutch Plate
0191	Right Side Plate Screw	1107	Star Drag Nut	1141	Retractor Spring
0194	Ball Bearing	1108	Bearing Holder	1148	Magnetic Control Dial
0425	Drive Shaft Lock	1111	Cast Control Cap	1150	Side Plate Bolt (A)
0489	Key Washer (A)	1112	Spool Shaft Bushing	1151	Side Plate Bolt (B)
0490	Drag Washer (B)	1113	Flipping Lever Screw	1152	Worm Shaft
0586	Bolt Retainer	1114	Flipping Lever	1153	Stabilizer Bar
0590	Lock Washer	1115	Right Side Plate	1154	Thumb Rest
0609	Clutch Plate Retainer Screw	1116	Cam Spring	1155	Thumb Rest Support
0612	Anti-Reverse Pawl Pin (A)	1117	Flipping Cam	1156	Level Wind Guard
0661	Magnet Retainer Spring	1118	Drive Gear	1157	One-Piece Frame
0664	Spacer (B)	1119	Drag Washer (A)	1158	Quick-Fire II Clutch Bar
0766	Dial Friction Washer	1120	Anti-Reverse Ratchet	1159	Spool Assembly
0770	Handle Nut Cover Screw	1121	Anti-Reverse Pawl Spring (B)	1179	Handle Assembly (spare)
0780	Magnet Retainer Lock	1122	Anti-Reverse Pawl Spring (A)	1201	Retractor Spring Collar
0797	Handle Nut	1123	Idle Gear	1202	Magnet Retainer
0802	Spool Tension Spacer (B)	1124	Drive Shaft	1254	Dial Case
0803	Spool Tension Spacer (A)	1125	Drive Shaft Retainer	1255	Left Side Plate
0807	Drive Shaft Bearing (B)	1127	Worm Bearing		
0808	Friction Washer (B)	1128	Anti-Reverse Pawl Pin (B)		
0816	Drive Shaft Washer	1129	Anti-Reverse Pawl		
0817	Multi Purpose Screw	1130	Line Guide		
0830	Spacer (optional)	1132	Pinion Gear		
1010	Spool Tension Spring	1133	Yoke Spring		
1092	Pawl Cap	1134	Yoke	1147	Dial Case
1101	Handle Nut Cover	1135	Yoke Spacer	1149	Left Side Plate

Prices and specifications subject to change without notice

(030508)