

SHIMANO®

1996 Repair Supplement

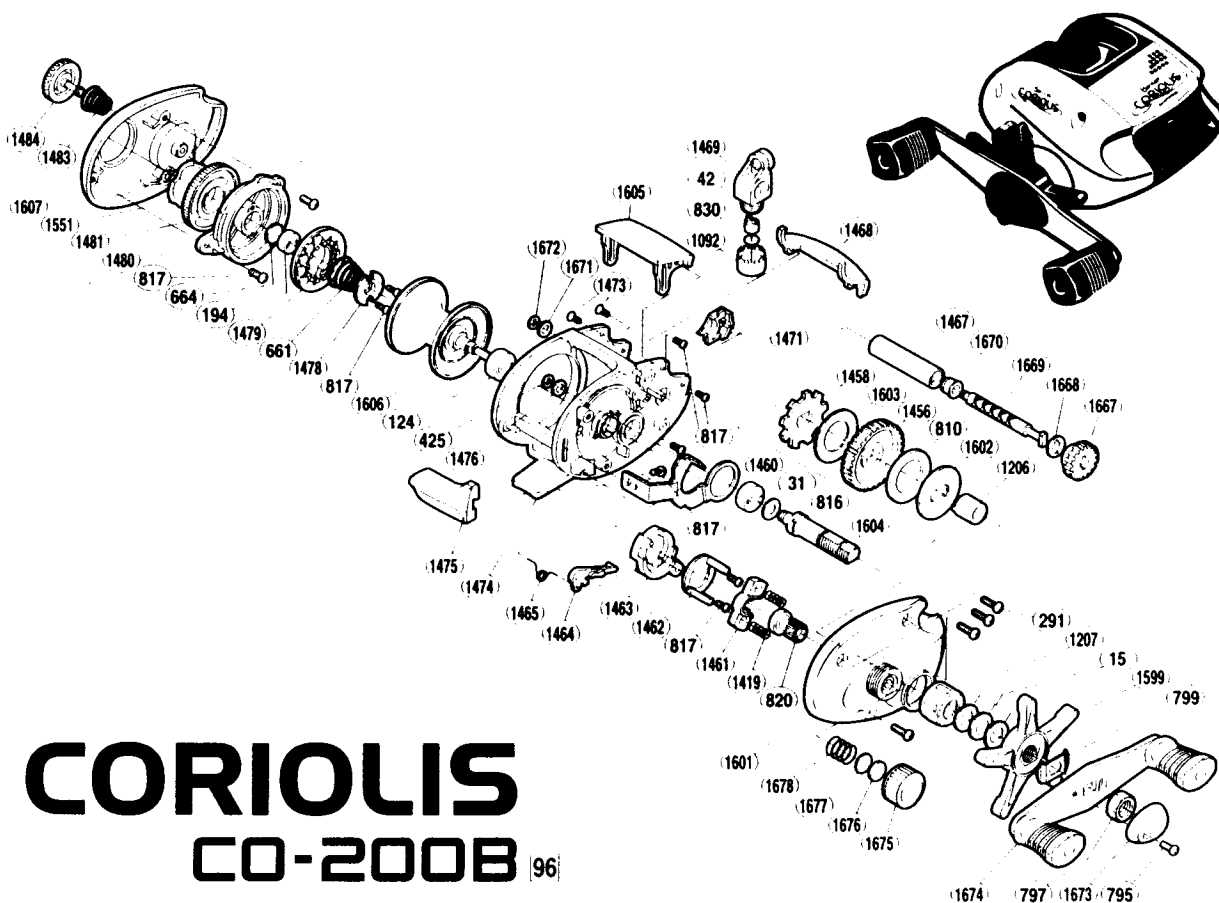

CORIOLIS

CO-200B 96

CO200B

Part #	Description	Part #	Description	Part #	Description
BNT0015	Drag Spring Washer	BNT1458	Anti-Reverse Ratchet	BNT1599	Star Drag
BNT0031	Ball Bearing	BNT1460	Clutch Plate	BNT1601	Right Side Plate
BNT0042	Line Guide Pawl	BNT1461	Yoke	BNT1602	Key Washer
BNT0124	Ball Bearing	BNT1462	Clutch Cam Retainer	BNT1603	Drive Shaft Washer
BNT0194	Ball Bearing	BNT1463	Clutch Cam	BNT1604	Drive Shaft
BNT0291	Right Side Plate Screw	BNT1464	Clutch Pawl	BNT1605	Thumb Rest
BNT0425	Drive Gear Retainer	BNT1465	Clutch Pawl Spring	BNT1606	Spool
BNT0661	Magnet Retainer Spring	BNT1467	Level Wind Guard	BNT1607	Left Side Plate
BNT0664	Spacer (B)	BNT1468	Level Wind Protector	BNT1667	Worm Gear
BNT0795	Handle Nut Plate Screw	BNT1469	Line Guide	BNT1668	Worm Shaft Washer (A)
BNT0797	Handle Nut	BNT1471	Drive Shaft Cover	BNT1669	Worm Shaft
BNT0799	Friction Washer	BNT1473	Multi-Purpose Screw	BNT1670	Worm Bushing
BNT0810	Drag Washer	BNT1474	One-Piece Frame	BNT1671	Worm Shaft Washer (B)
BNT0816	Drive Shaft Washer	BNT1475	Quick-Fire II Clutch Bar	BNT1672	"E" Lock
BNT0817	Multi-Purpose Screw	BNT1476	Drive Shaft Washer (D)	BNT1673	Handle Nut Plate
BNT0820	Pinion Gear	BNT1478	Magnet Holder	BNT1674	Handle Assembly
BNT0830	Spacer (optional)	BNT1479	Magnet Retainer	BNT1675	Cast Control Cap
BNT1092	Pawl Cap	BNT1480	Dial Case	BNT1676	Spool Tension Spacer (B)
BNT1206	Roller Clutch Inner Tube	BNT1481	Magnet Control Dial	BNT1677	Spool Tension Spacer (A)
BNT1207	Roller Clutch Bearing	BNT1483	Lock Spring	BNT1678	Spool Tension Spring
BNT1419	Yoke Spring	BNT1484	Lock Screw Cap		
BNT1456	Drive Gear	BNT1551	Dial Friction Washer		