

# SHIMANO

**CURADO** 

**CU-200E5**

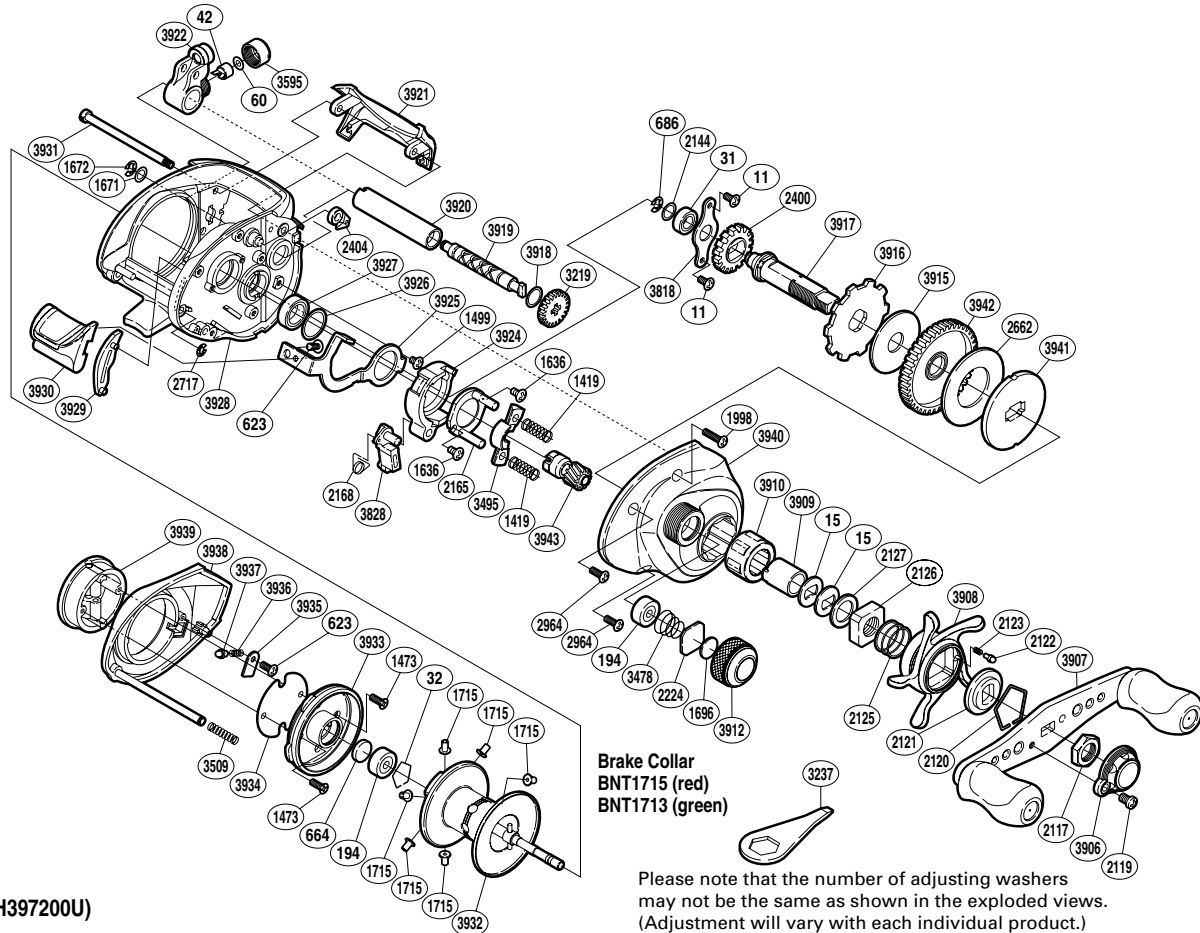

(1RH397200U)

| Part No. | Description          | Part No. | Description              | Part No. | Description                      |
|----------|----------------------|----------|--------------------------|----------|----------------------------------|
| BNT0011  | Screw                | BNT2127  | Star Drag Spacer         | BNT3919  | Worm Shaft                       |
| BNT0015  | Drag Spring Washer   | BNT2144  | Washer                   | BNT3920  | Level Wind Guard                 |
| BNT0031  | Ball Bearing         | BNT2165  | Clutch Cam Retainer      | BNT3921  | Level Wind Protector             |
| BNT0032  | Bearing Retainer     | BNT2168  | Clutch Pawl Spring       | BNT3922  | Line Guide                       |
| BNT0042  | Line Guide Pawl      | BNT2224  | Spool Tension Spacer     | BNT3924  | Clutch Cam                       |
| BNT0060  | Spacer               | BNT2400  | Idle Gear                | BNT3925  | Clutch Plate                     |
| BNT0194  | Ball Bearing         | BNT2404  | Anti-Reverse Pawl        | BNT3926  | Washer                           |
| BNT0623  | Screw                | BNT2662  | Drag Washer              | BNT3927  | Ball Bearing                     |
| BNT0664  | Spacer B             | BNT2717  | E Lock                   | BNT3928  | One-Piece Frame                  |
| BNT0686  | E Lock               | BNT2964  | Screw                    | BNT3929  | Clutch Bar Guide                 |
| BNT1419  | Yoke Spring          | BNT3219  | Idle Gear                | BNT3930  | Quick-Fire II Clutch Bar         |
| BNT1473  | Screw                | BNT3478  | Spool Tension Spring     | BNT3931  | Level Wind Guide                 |
| BNT1499  | Screw                | BNT3495  | Yoke                     | BNT3932  | Spool Assembly                   |
| BNT1636  | Screw                | BNT3509  | Side Plate Spring        | BNT3933  | Brake Case                       |
| BNT1671  | Washer               | BNT3595  | Pawl Cap                 | BNT3934  | Brake Case Spacer                |
| BNT1672  | E Lock               | BNT3818  | Drive Shaft Retainer     | BNT3935  | Brake Spring Retainer            |
| BNT1696  | Cast Control Spacer  | BNT3828  | Clutch Pawl              | BNT3936  | Click Spring                     |
| BNT1715  | Brake Collar (red)   | BNT3906  | Handle Retainer          | BNT3937  | Click Pin                        |
| BNT1998  | Screw                | BNT3907  | Handle Assembly          | BNT3938  | Left Side Plate                  |
| BNT2117  | Handle Nut           | BNT3908  | Star Drag                | BNT3939  | Turnkey Dial                     |
| BNT2119  | Screw                | BNT3909  | Roller Clutch Inner Tube | BNT3940  | Right Side Plate                 |
| BNT2120  | Click Plate Retainer | BNT3910  | Roller Clutch Bearing    | BNT3941  | Key Washer                       |
| BNT2121  | Star Drag Click      | BNT3912  | Cast Control Cap         | BNT3942  | Drive Gear                       |
| BNT2122  | Click Pin            | BNT3915  | Drag Washer              | BNT3943  | Pinion Gear                      |
| BNT2123  | Click Spring         | BNT3916  | Anti-Reverse Ratchet     |          |                                  |
| BNT2125  | Star Drag Spring     | BNT3917  | Drive Shaft              | BNT1713  | Brake Collar (green) (accessory) |
| BNT2126  | Star Drag Nut        | BNT3918  | Washer                   | BNT3237  | Wrench (accessory)               |