

# CURADO

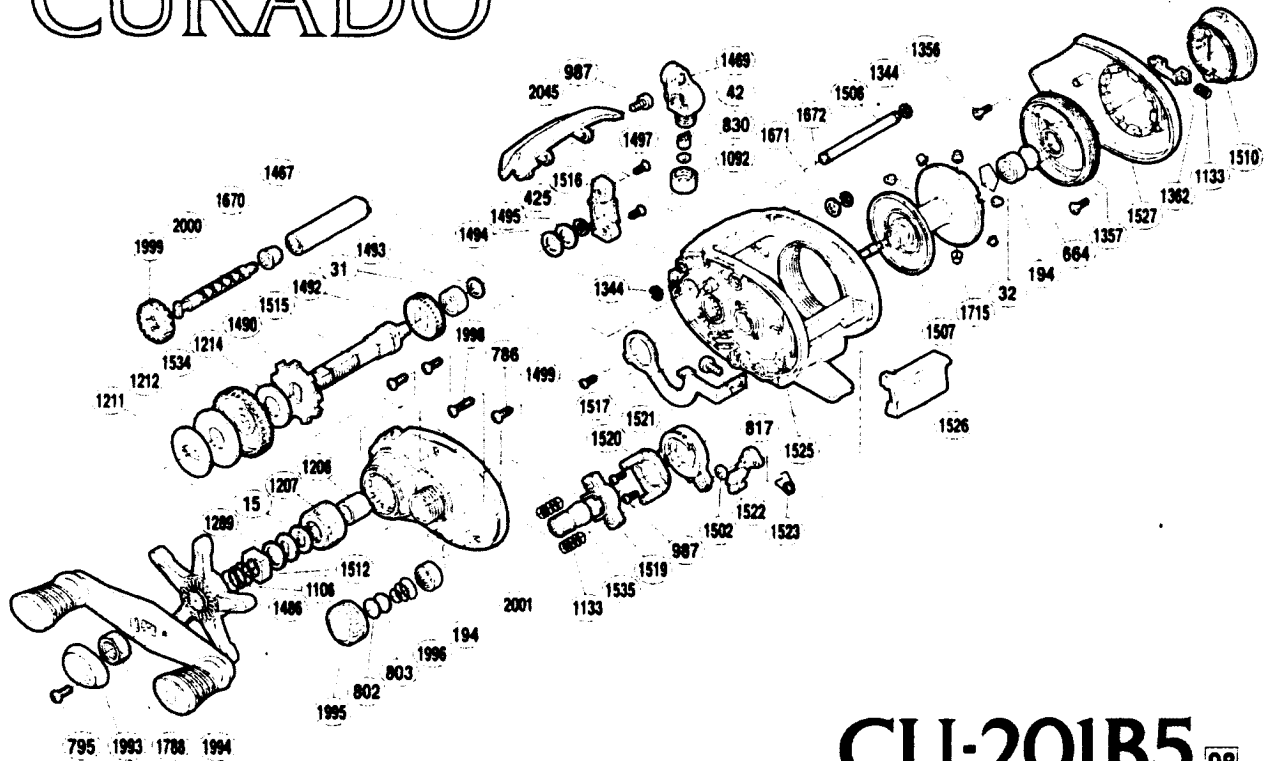

## CU-201B5 98

BNT No.	PARTS NAMES	BNT No.	PARTS NAMES	BNT No.	PARTS NAMES
0015	Drag Spring Washer	1344	"C" Lock	1520	Clutch Cam Retainer
0031	Ball Bearing	1356	Brake Case Retainer Screw	1521	Clutch Cam
0032	Bearing Retainer	1357	Brake Case	1522	Clutch Pawl
0042	Line Guide Pawl	1362	Turnkey Pawl	1523	Clutch Pawl Spring
0194	Ball Bearing	1467	Level Wind Guard	1525	One-Piece Frame
0425	"E" Lock	1469	Line Guide	1526	Quick-Fire II Clutch Bar
0664	Spacer (B)	1486	Star Drag	1527	Right Side Plate
0786	Side Plate Screw (short)	1490	Anti-Reverse Ratchet	1534	Drive Gear
0795	Handle Nut Plate Screw	1492	Idle Gear (A)	1535	Pinion Gear
0802	Spool Tension Spacer (B)	1493	Drive Gear Washer	1670	Worm Bushing
0803	Spool Tension Spacer (A)	1494	Drive Shaft Washer (B)	1671	Worm Shaft Washer (B)
0817	Clutch Bar Screw	1495	Drive Shaft Washer (A)	1672	"E" Lock
0830	Spacer (optional)	1497	Drive Shaft Cover Screw	1715	Brake Collar (red)
0987	Multi Purpose Screw	1499	Clutch Plate Screw	1788	Handle Nut
1092	Pawl Cap	1502	Spacer (optional)	1993	Handle Nut Plate Assembly
1106	Star Drag Spring	1506	Line Guard	1994	Handle Assembly
1133	Yoke / Turnkey Pawl Spring	1507	Spool Assembly	1995	Cast Control Cap
1206	Roller Clutch Inner Tube	1510	Turnkey Dial	1996	Spool Tension Spring
1207	Roller Clutch Bearing	1512	Star Drag Nut	1998	Side Plate Screw (long)
1211	Key Washer	1515	Drive Shaft	1999	Idle Gear (C)
1212	Drag Washer (C)	1516	Drive Shaft Cover	2000	Worm Shaft
1214	Drag Washer (A)	1517	Clutch Plate	2001	Left Side Plate
1289	Star Drag Spacer	1519	Yoke	2045	Thumb Rest

(090730)

Printed in Japan