

SHIMANO®

1994 REPAIR MANUAL

Shimano American Corporation, One Shimano Dr.
Irvine, CA 92718

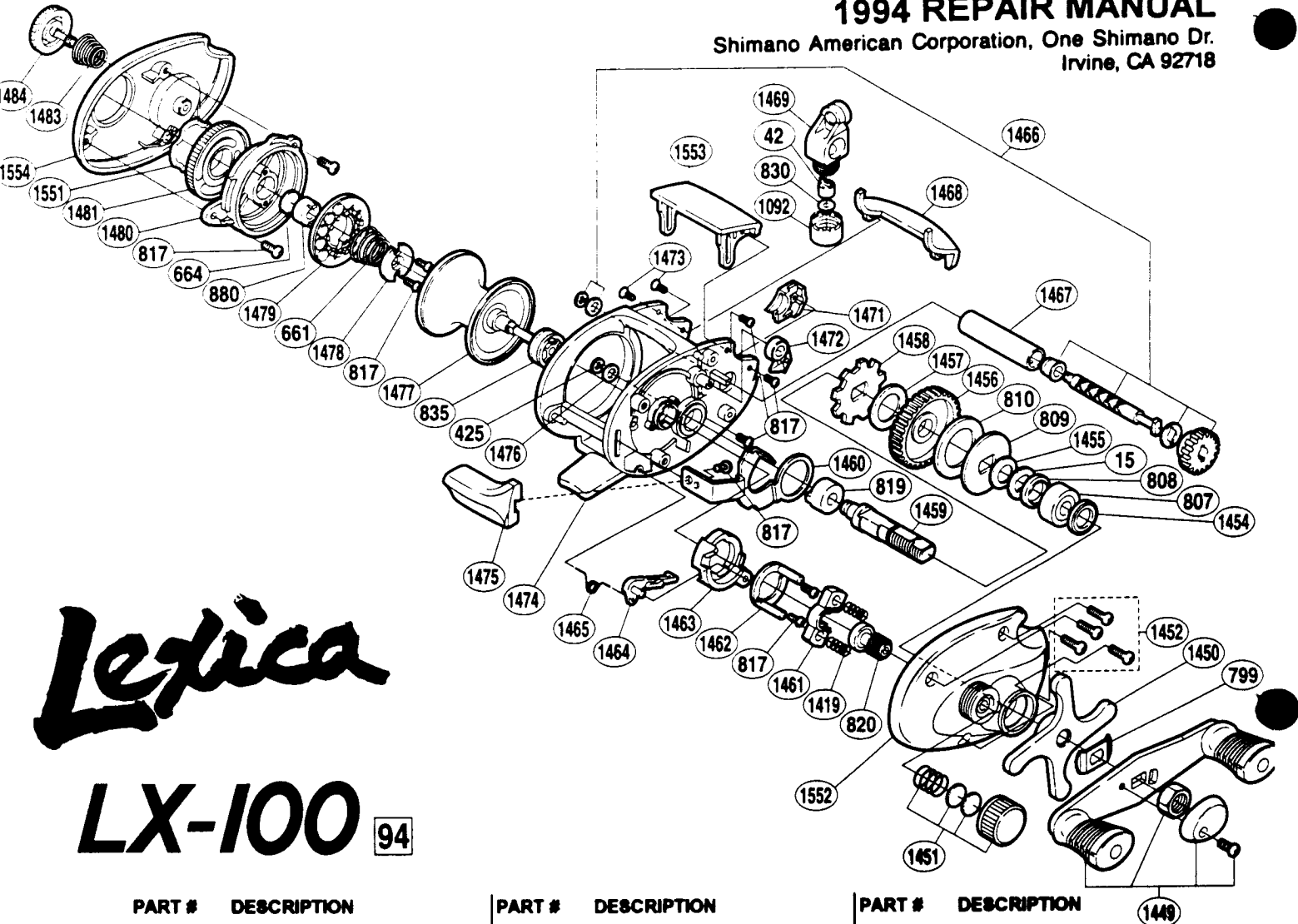

Lexica

LX-100 94

PART # DESCRIPTION

BNT0015	Drag Spring Washer
BNT0042	Line Guide Pawl
BNT0425	Drive Gear Retainer
BNT0661	Magnet Retainer Spring
BNT0664	Spacer (B)
BNT0799	Friction Washer
BNT0807	Drive Shaft Bearing
BNT0808	Friction Washer (B)
BNT0809	Key Washer
BNT0810	Drag Washer
BNT0817	Multi Purpose Screw
BNT0819	Drive Shaft Bushing
BNT0820	Pinion Gear
BNT0830	Spacer (optional)
BNT0835	Spool Shaft Bushing (B)
BNT0880	Spool Shaft Bushing (C)
BNT1092	Pawl Cap
BNT1419	Yoke Spring
BNT1449	Handle Assembly

PART # DESCRIPTION

BNT1450	Star Drag
BNT1451	Cast Control Cap Assembly
BNT1452	Side Palte Screws
BNT1454	Bearing Bushing
BNT1455	Drag Spring Washer
BNT1456	Drive Gear
BNT1457	Drive Shaft Washer (B)
BNT1458	Anti-reverse Ratchet
BNT1459	Drive Shaft
BNT1460	Clutch Plate
BNT1461	Yoke
BNT1462	Clutch Cam Retainer
BNT1463	Clutch Cam
BNT1464	Clutch Pawl
BNT1465	Clutch Pawl Spring
BNT1466	Worm Shaft Assembly
BNT1467	Level Wind Guard
BNT1468	Level Wind Protector

PART # DESCRIPTION

BNT1469	Line Guide
BNT1471	Drive Shaft Cover
BNT1472	Anti-reverse Pawl
BNT1473	Multi Purpose Screw
BNT1474	One-Piece Frame
BNT1475	Quick-Fire II Clutch Bar
BNT1476	Drive Shaft Washer (D)
BNT1477	Spool
BNT1478	Magnet Holder
BNT1479	Magnet Retainer
BNT1480	Dial Case
BNT1481	Magnetic Control Dial
BNT1483	Lock Spring
BNT1484	Lock Screw Cap
BNT1551	Dial Friction Washer
BNT1552	Right Side Plate
BNT1553	Thumb Rest
BNT1554	Left Side Plate