

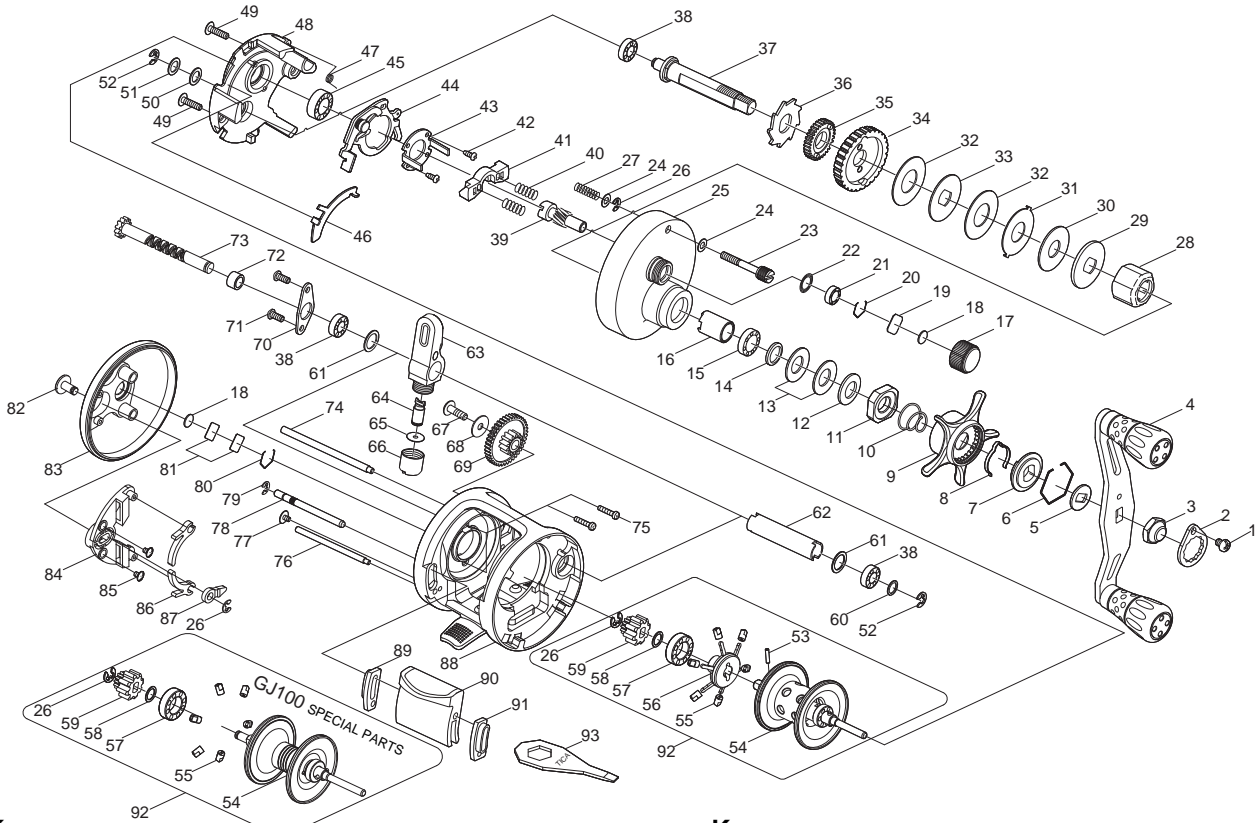

BAIT CASTING REEL

CAIMAN

GJ100M / GJ100



Key No.

Parts No.	Parts name
1	2E2-089-01 A26M-045 SCREW
2	2F6-043-02 ROTOR NUT HOLDING PLATE
3	2E3-075-01 HANDLE NUT
4	2YH-312-03 HANDLE TOTAL ASSEMBLY
5	2W2-058-01 KEY WASH
6	2E4-018-01 RETAINER
7	2F8-050-01 CLICK LEAF SPRING HOLDER
8	2L3-029-01 CLICK LEAF SPRING
9	2D4-008-02 STAR DRAG LEVER
10	2Q1-052-01 STAR DRAG SPRING
11	2E3-029-01 STAR DRAG NUT
12	2W1-020-01 081-130 WASHER
13	2L1-004-01 SPRING WASHER
14	2W1-035-05 080-105 WASHER
15	2Z1-024-05 812-2.5 BALL BEARING
16	2A4-022-01 ONE-WAY CLUTCH INNER TUBE
17	2E3-024-01 CAST CONTROL NUT
18	2W5-026-01 SPACER
19	2W5-029-01 CAST CONTROL SPACER
20	2E4-019-01 BEARING RETAINER
21	2Z1-001-05 508-2.5 BALL BEARING
22	2E9-005-01 O RING
23	2E0-011-01 RIGHT SIDE COVER SCREW
24	2W1-132-01 036-060 WASHER
25	2YF-034-16 RIGHT SIDE COVER ASSEMBLY
26	2E5-006-01 E2.5 RETAINER
27	2Q1-056-01 RIGHT SIDE COVER SCREW SPRING
28	2YZ-007-01 ONE-WAY CLUTCH BEARING ASSEMBLY
29	2W2-032-01 KEY WASHER
30	2W1-126-01 082-210 WASHER
31	2W3-017-01 EARED WASHER
32	2W1-111-01 100-230 WASHER
33	2W2-025-01 KEY WASHER
34	2G1-027-01 DRIVE GEAR
35	2YG-023-01 OSCILLATING GEAR ASSEMBLY
36	2A3-027-01 RATCHET
37	2M3-048-01 DRIVE SHAFT
38	2Z1-018-05 510-3 BALL BEARING
39	2G2-010-01 PINION GEAR
40	2Q1-031-01 YOKE SPRING
41	2A2-039-01 PINION YOKE
42	2E2-047-01 A20M-065 SCREW
43	2F8-030-01 CLUTCH CAM RETAINER
44	2YA-018-01 CLUTCH CAM ASSEMBLY
45	2Z1-010-05 812-3.5 BALL BEARING
46	2M2-017-01 CLUTCH PLATE
47	2Q3-086-01 RETRACTOR SPRING
48	2F8-016-01 GEAR SETTING PLATE
49	2E2-031-01 A26M-075 SCREW

Key No.

Parts No.	Parts name
50	2W1-054-01 052-080 WASHER
51	2W1-070-01 052-080 WASHER
52	2E5-013-01 E3.0 RETAINER
53	2E6-017-01 SPOOL SHAFT PIN
54	2YS-272-02 SPOOL ASSEMBLY
55	2C2-057-01 BRAKE COLLAR
56	2YS-256-01 TIP OF SPOOL ASSEMBLY
57	2Z1-023-01 814-4 BALL BEARING
58	2W1-070-03 052-080 WASHER
59	2F3-041-01 CLICK GEAR
60	2W1-046-01 051-068 WASHER
61	2W1-078-01 072-100 WASHER
62	2C4-015-01 LEVEL WIND GUARD
63	2YR-038-01 LINE GUIDE ASSEMBLY
64	2M5-005-01 LINE GUIDE PIN
65	2W1-100-01 020-068 WASHER
66	2E3-014-01 LINE GUIDE NUT
67	2E2-007-01 B30M-100 SCREW
68	2W1-166-02 031-102 WASHER
69	2G3-087-01 IDLE GEAR
70	2F6-050-01 BEARING HOLDING PLATE
71	2E2-037-01 A26M-060 SCREW
72	2C1-055-01 SPACER
73	2YM-087-01 WORM SHAFT ASSEMBLY
74	2P4-006-02 LEVEL WIND GUIDE
75	2E2-034-01 A20M-090 SCREW
76	2P4-008-02 CASTING BAR SUPPORT
77	2E2-003-01 B26M-036 SCREW
78	2P2-021-01 CASTING BAR PIN
79	2E5-020-01 E1.5 RETAINER
80	2E4-011-01 BEARING RETAINER
81	2W5-015-01 CAST CONTROL SPACER
82	2F7-004-01 CLICK SWITCH
83	2F5-404-03 LEFT SIDE COVER
84	2F6-055-01 CLICK PLATE
85	2E2-022-01 B20M-030 SCREW
86	2F2-020-01 CLICK SPRING
87	2F4-018-01 CLICK PAWL
88	2YB-096-53 BODY ASSEMBLY
89	2C4-014-02 CASTING BAR GUIDE B
90	2YS-085-02 CASTING BAR ASSEMBLY
91	2C4-013-02 CASTING BAR GUIDE A
92	2YT-410-02 SPOOL TOTAL ASSEMBLY
93	2X3-004-02 WRENCH
GJ100	SPECIAL PARTS
25	2YF-034-19 RIGHT SIDE COVER ASSEMBLY
54	2YS-281-02 SPOOL ASSEMBLY
92	2YT-445-02 SPOOL TOTAL ASSEMBLY