



Please order by parts number, not key number
 Bitte, Best.-Nr. angeben (Nicht "key" -nr.)
 Veuillez indiquer le numero de la piece (Non "key" no.)

SPINNING REEL

TL2000R / TL3000R / TL4000R / TL5000R TL6000R / TL8000R / TL9000R / TL10000R

GEAR RATIO(5.2/4.1/3.3)

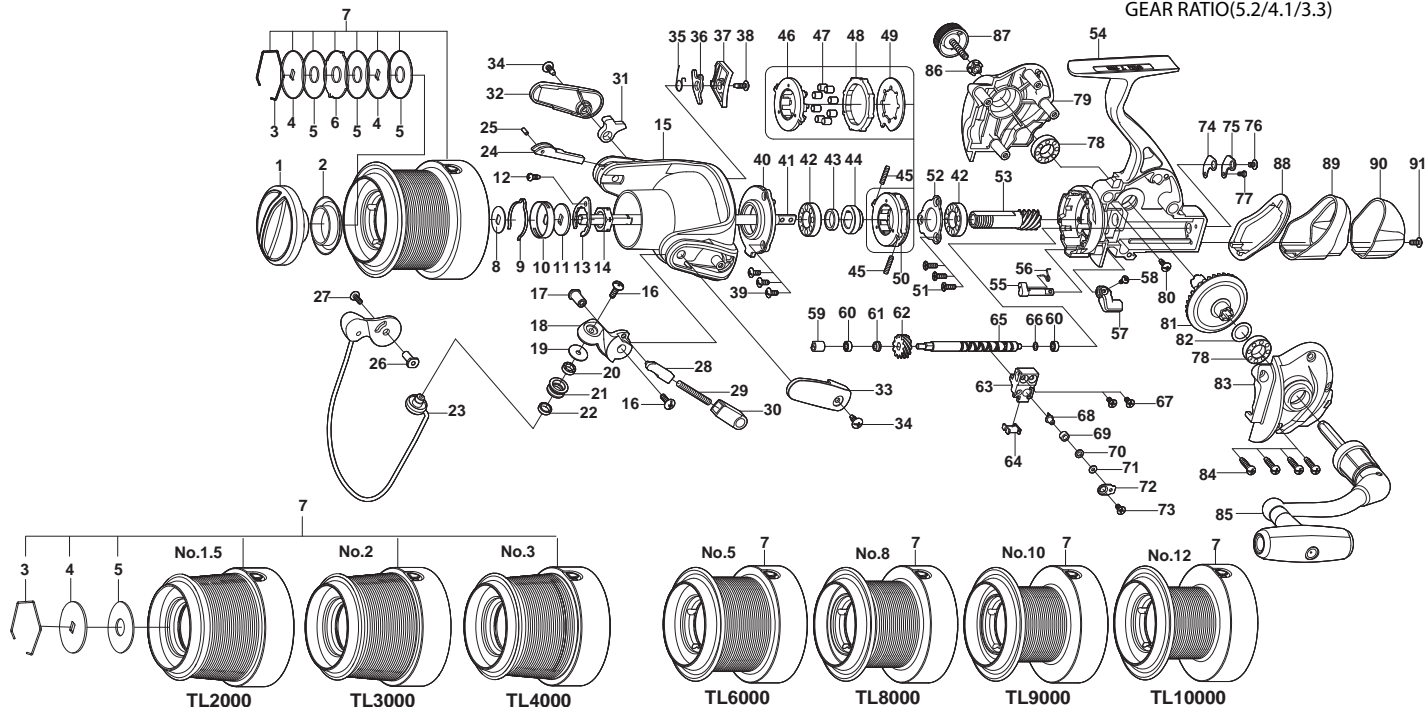

Key NO.	Parts No.	Parts name	Key NO.	Parts No.	Parts name
1	2YD-069-01	DRAG KNOB ASSEMBLY	59	2C2-101-01	WORM SHAFT BUSH
2	2E9-015-01	PROOF WATER RING	60	2Z1-014-05	306-2.5 BALL BEARING
3	2E4-003-01	DRAG WASHER RETAINER	61	2C1-046-01	COLLAR
4	2W2-048-02	KEY WASHER	62	2G3-035-01	OSCILLATING GEAR
5	2W1-175-01	100-300 WASHER	63	2M1-051-01	OSCILLATING SILDER
6	2W3-027-01	EARED WASHER	64	2E5-045-01	OSCILLATING SLIDER RETAINER
7	2YT-284-04	SPOOL TOTAL ASSEMBLY	65	2M4-032-01	WORM SHAFT
8	2W2-050-01	KEY WASHER	66	2W1-058-02	030-050 WASHER
9	2L3-018-01	CLICK LEAF SPRING	67	F26M-060 SCREW	F26M-060 SCREW
10	2F8-027-02	CLICK LEAF SPRING HOLDER	68	2M5-004-01	LINE GUIDE PIN
11	2W2-034-01	KEY WASHER	69	2C2-034-01	LINE GUIDE PIN BUSH
12	2E1-060-01	A26-060 SCREW	70	2W1-107-02	030-050 WASHER
13	2F6-028-01	ROTOR NUT HOLDING PLATE	71	2W1-059-01	020-049 WASHER
14	2E3-026-01	ROTOR NUT	72	2F5-296-01	OSCILLATING SILDER COVER
15	2R1-112-01	ROTOR	73	2E2-014-02	F26M-060 SCREW
16	2E2-007-01	B30M-100 SCREW	74	2W5-031-01	WORM SHAFT COVER GASKET
17	2E3-055-01	SHAFT NUT(A)	75	2F5-161-01	WORM SHAFT COVER
18	2R2-046-01	BAIL ARM	76	2E2-003-01	B26M-036 SCREW
19	2C1-049-01	LINE ROLLER COLLAR	77	2E2-050-01	A20M-035 SCREW
20	2Z1-001-05	508-2.5 BALL BEARING	78	2Z1-035-05	917-5 BALL BEARING
21	2R6-018-01	LINE ROLLER	79	2B2-073-01	BODY COVER(R)
22	2C1-068-01	COLLAR	80	2E1-016-02	B26-080 SCREW
23	2YL-122-01	BAIL ASSEMBLY	81	2G1-081-02	DRIVE GEAR
24	2R5-127-01	BAIL PAWL	82	2W1-014-00	091-130 WASHER
25	2P1-055-01	BAIL TRIP PIN	83	2B2-074-01	BODY COVER(L)
26	2E3-056-01	SHAFT NUT(B)	84	2E1-006-02	A30-130 SCREW
27	2E2-005-03	B26M-080 SCREW	85	2YH-199-01	HANDLE ASSEMBLY
28	2R5-126-01	BAIL TRIP SHAFT	86	2C3-047-01	HANDLE SCREW SLEEVE
29	2Q1-077-01	BAIL SPRING	87	2H6-002-10	HANDLE SCREW CAP
30	2C2-102-01	BAIL SPRING GUIDE	88	2E9-031-01	REAR COVER PROOF WATER RING
31	2R5-128-01	BAIL TRIP LEVER A	89	2F5-291-01	REAR COVER A
32	2R4-132-01	BAIL TRIP COVER	90	2F5-292-01	REAR COVER B
33	2R4-131-01	BAIL SPRING COVER	91	2E2-029-03	B26M-060 SCREW
34	2E1-037-01	B30-080 SCREW	TL2000R	SPECIAL PARTS	
35	2Q3-104-01	BAIL TRIP LEVER SPRING	7	2YT-281-04	SPOOL TOTAL ASSEMBLY
36	2R5-129-01	BAIL TRIP LEVER B	TL3000R	SPECIAL PARTS	
37	2F5-270-01	ROTOR COVER	7	2YT-282-04	SPOOL TOTAL ASSEMBLY
38	2E1-016-02	B26-080 SCREW	TL4000R	SPECIAL PARTS	
39	2E2-037-01	A26M-060 SCREW	7	2YT-283-04	SPOOL TOTAL ASSEMBLY
40	2F8-094-01	BEARING HOLDER	TL6000R	SPECIAL PARTS	
41	2M3-101-01	MAIN SHAFT	7	2YT-285-04	SPOOL TOTAL ASSEMBLY
42	2Z1-008-05	1020-5 BALL BEARING	TL8000R	SPECIAL PARTS	
43	2C1-096-01	COLLAR	7	2YT-286-04	SPOOL TOTAL ASSEMBLY
44	2A4-034-01	ONE-WAY CLUTCH INNER TUBE	TL9000R	SPECIAL PARTS	
45	2Q1-071-01	CAGE SPRING	7	2YT-287-04	SPOOL TOTAL ASSEMBLY
46	2F8-084-01	CAGE	TL10000R	SPECIAL PARTS	
47	2Z3-003-01	ROLLER	7	2YT-288-04	SPOOL TOTAL ASSEMBLY
48	2A3-009-01	ANTI-REVERSE RATCHET	GEAR RATIO 5.2	SPECIAL PARTS	
49	2F2-033-01	ANTI-REVERSE PAWL	32	2R4-132-02	BAIL TRIP COVER
50	2YZ-020-01	ONE-WAY CLUTCH BEARING ASSEMBLY	53	2G2-098-01	PINION GEAR
51	2E2-052-02	F26M-080 SCREW	62	2G3-025-01	OSCILLATING GEAR
52	2F5-259-01	BEARING RETAINER	81	2G1-080-02	DRIVE GEAR
53	2G2-099-01	PINION GEAR	GEAR RATIO 3.3	SPECIAL PARTS	
54	2YB-176-01	BODY ASSEMBLY	32	2R4-132-03	BAIL TRIP COVER
55	2A2-075-01	ANTI-REVERSE CAM	53	2G2-100-01	PINION GEAR
56	2Q3-009-01	ANTI-REVERSE SPRING	62	2G3-048-01	OSCILLATING GEAR
57	2A1-026-01	ANTI-REVERSE LEVER	81	2G1-082-02	DRIVE GEAR
58	2E2-013-02	B20M-060 SCREW			