

# ZEBCO 2010N

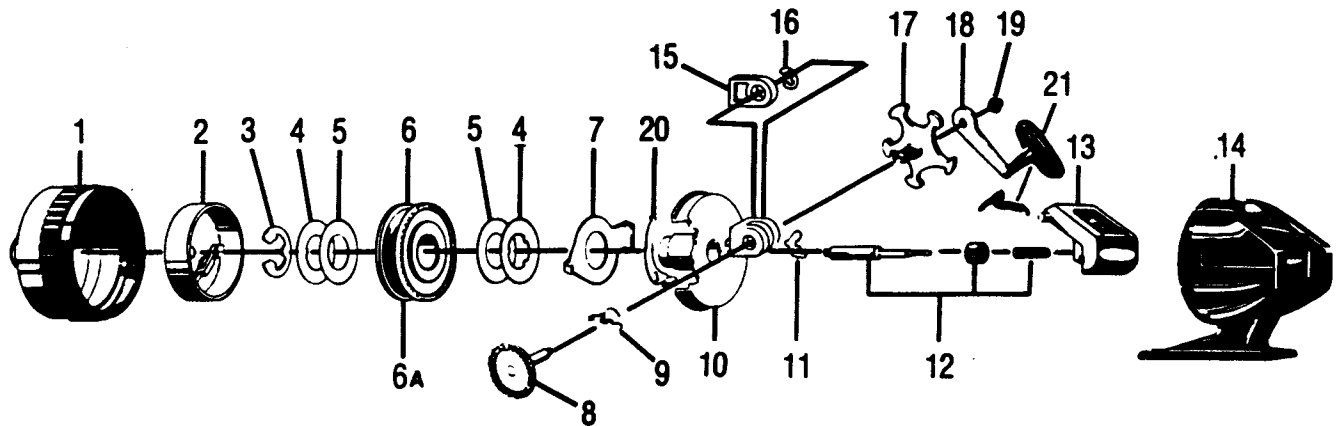

Key No.	Part No.	Description	Price
1	QY324-5	FRONT COVER S/A	4.75
2	QY310	SPINNER HEAD ASSEMBLY	4.97
3	XZ034	SPOOL CLIP	.33
4	BJ040	SPOOL WASHER	.56
5	BJ108	FLAT WASHER	.38
6	QY021	SPOOL	2.14
6	QY036	SPOOL LIP WASHER	.49
6	QY321-6H	WOUND SPOOL W/ LINE 6#	4.81
7	QY027	CLUTCH RING	.88
8	QY308	CRANK SHAFT ASSEMBLY	3.03
9	JY061	PAWL ACTUATOR	.44
10	QY301	BODY ASSEMBLY	6.51
11	JY060	ANTI-REVERSE PAWL	.44
12	QY315	CENTERSHAFT ASSEMBLY	3.53
13	TY009	THUMB STOP	1.00
14	QY323-5	BACK COVER ASSY.	6.18
15	JY054	SLIDE DRAG ACTUATOR	1.27
16	JY121	RETAINER CLIP	.38
17	QY032-1	DRAG STAR	.42
18	QY318-6	HANDLE ASSY.	3.03
19	AZ003	CRANK NUT	.56
20	RY033	RATCHET SPRING	.49
21	QY038	THUMB STOP SPRING	.49
22	QY026-3	CRANK SHAFT BUSHING	2.32

Prices subject to change without notice. Prices do not include postage and handling.

**PLEASE ORDER BY PART NUMBER**

Rev. 5/93

Zebco Division Brunswick Corporation, Box 270, Tulsa, OK 74101 USA 918-836-5581

