

ZEBCO ZX20

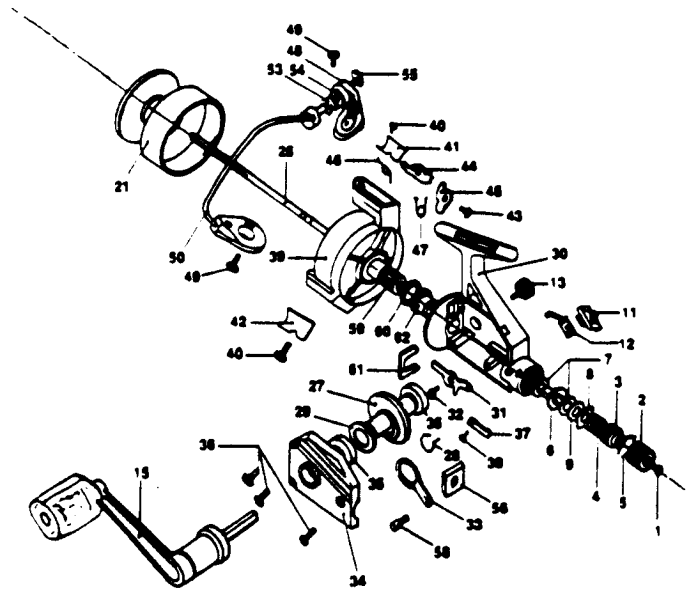

KEY PART NO. NO.	DESCRIPTION	PRICE	KEY PART NO. NO.	DESCRIPTION	PRICE
1 JK079	DRAG SCREW	.37	36 JK057	SIDE PLATE SCREW	.37
2 JK032	DRAG NUT	1.24	37 JK068	CLICK CLAW	.85
3 JK127	PRESSURE SLEEVE	.70	38 JK067	CLICK CLAW SPRING	.37
4 JK128	PRESSURE SPRING	1.50	39 JK009	ROTOR	4.12
5 JK070	SAFETY RING	.85	40 JK085	ROTOR COVER SCREW	.37
6 JK104	DRAG WHEEL	.97	41 JK087	ROTOR COVER (L)	.97
7 JK030	BRAKE DISC A	.54	42 JK024	ROTOR COVER (S)	.80
8 JK039	NOTCHED DISC B	.54	43 JK037	STOP LEVER SCREW	.37
9 JK046	BRAKE DISC C	.54	44 JK019	STOP LEVER (L)	.80
10 JK129	LOCK WASHER	.54	45 JK018	STOP LEVER (S)	.80
11 JK059	ANTI-REVERSE LEVER	.70	46 JK049	TURNING SPRING	.85
12 JK090	ANTI-REVERSE SPRING	1.44	47 JK047	STOP LEVER SPRING	.85
13 JK073	HANDLE SCREW CAP	.91	48 JK007	ANGLE LEVER	1.71
15 JK318	HANDLE ASSY.	5.09	49 JK051	ANGLE LEVER SCREW	.37
21 JK321	SPOOL ASSY.	4.02	50 JK347	BAIL ASSY.	3.43
25 JK315	MAIN SHAFT ASSY.	2.68	53 JK004	LINE ROLLER	.97
27 JK012	DRIVE GEAR	3.16	54 JK016	LINE ROLLER WASHER	.54
28 JK213	DRIVE GEAR SPRING	.64	55 JK108	LINE ROLLER SCREW	.37
29 JK026	DRIVE GEAR WASHER	.54	56 JK081	SLIDE	.80
30 JK301	BODY ASSY.	6.43	58 JK084	SLIDE SCREW	.59
31 JK063	ANTI-REVERSE PAWL	.85	59 JK011	PINION GEAR	2.14
32 JK089	A/R PAWL SCREW	.37	60 JK010	PINION GEAR WASHER	.37
33 JK025	OSCILLATOR GUIDE	1.17	61 JK125	ROTOR HOLDING PLATE	.37
34 JK323	SIDE PLATE	2.51	62 JK126	PINION GEAR BUSHING	.59
35 JK013	SIDE PLATE BUSHING	.70			

Prices subject to change without notice. Prices do not include postage and handling.

PLEASE ORDER BY PART NUMBER

Rev. 11/90

Zebco Division Brunswick Corporation, Box 270, Tulsa, OK 74101 USA 918-836-5581

