

Zebco Omega 33 33XBL™

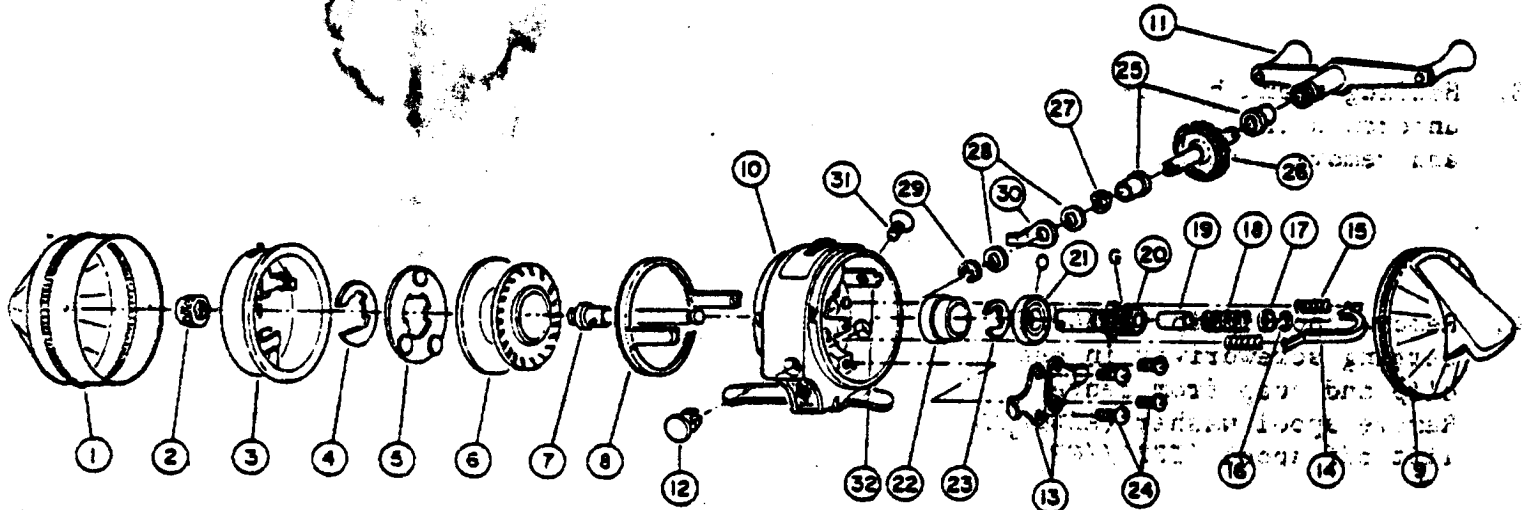

Key No.	Part No.	Description
1	IZ24//SA	Front Cover Assembly
2	AZ6/2	Spinner Head Nut
3	IZ10//SA	Spinner Head Assembly
4	GZ34//THT	Spool Clip
5	AZ40//SA	Spool Washer
6	IZ21//CP	Spool-order form attached
7	IZ15//SA	Center Shaft
8	IZ46//SA	Brake Ring Retainer
8	MZ53//TP	Brake Ring Gasket
9	IZ23//SA	Back Cover Assembly
10	IZ1//SA	Body Assembly
11	IZ18-1//SA	Handle Assembly
12	IZ3-2//TP	Cap Nut
13	IZ29//TP	Bearing Retainer
14	IZ31//SA	Brake Bar
15	AZ73/1	Brake Ring Spring
16	WZ22/0	Center Shaft Clip
17	GZ73/1	Control Clip Retainer

Key No.	Part No.	Description	Price
18	IZ20/0	Center Shaft Spring	
19	AZ78/1	Center Shaft Spacer	
20	AZ11//TP	Pinion Shaft	
21	AZ28/0	Ball Bearing	
22	AZ30/1/0	Bearing Spacer	
23	PZ30/0	Bearing Spacer Clip	
24	AZ57/1	Retainer Screw	
25	IZ26/0	Crank Bearing	
26	IZ8-1//SA	Crank Shaft Assembly	
27	JO88/0	Tension Washer	
28	AZ54/0	Anti-Reverse Drag Washer	
29	WZ22/0	Center Shaft Clip	
30	IZ52//CP	Anti-Reverse Drag	
31	LZ55/1	Cover Lock Screw	
32	IZ56/0	Cover Lock	
	AZ33/2	Clutch Washer	
	IZ29//TP	Bearing Retainer	
	IZ9//SA	Thumb Stop	

Zebco Division Brunswick Corporation, Box 270, Tulsa OK 74101 USA 918+836+5581

Omega 33 Jan. 1979



1979 Prices