

# ZEBCO PRO STAFF 2010N, 2020N, 2030N

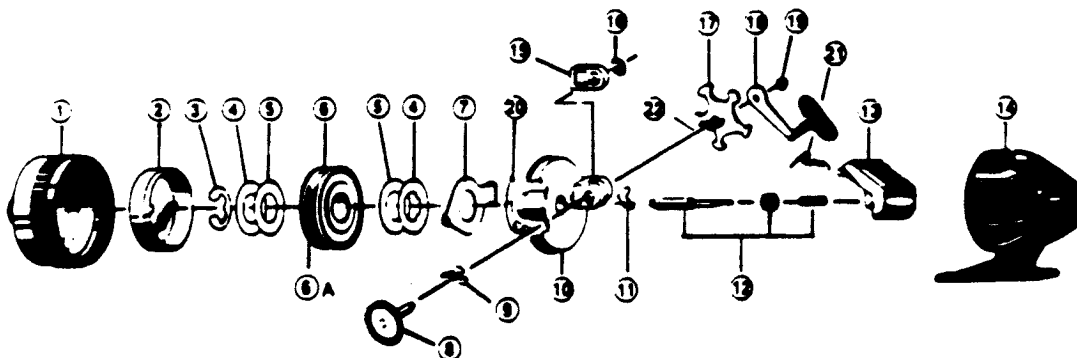

KEY PART NO. NO.	DESCRIPTION
1 QY324-5	FRONT COVER S/A
2 QY310	SPINNER HEAD ASSEMBLY
3 XZ034	SPOOL CLIP
4 BJ040	SPOOL WASHER
5 BJ108	FLAT WASHER
6 QY021	SPOOL
6 QY036	SPOOL LIP WASHER
5 QY321-6H	WOUND SPOOL W/ LINE 6#
7 QY027	CLUTCH RING
8 QY308	CRANK SHAFT ASSEMBLY
9 JY061	PAWL ACTUATOR
10 QY301	BODY ASSEMBLY
11 JY060	ANTI-REVERSE PAWL
12 QY315	CENTERSHAFT ASSEMBLY
13 TY009	THUMB STOP
14 QY323-5	BACK COVER ASSY.
15 JY054	SLIDE DRAG ACTUATOR
16 JY121	RETAINER CLIP
17 QY032-1	DRAG STAR
18 QY318-5	HANDLE ASSY.
19 AZ003	CRANK NUT
20 RY033	RATCHET SPRING
21 QY038	THUMB STOP SPRING
22 QY026-3	CRANK SHAFT BUSHING

## 2010N

KEY PART NO. NO.	DESCRIPTION	PRICE
1 QY324-5	FRONT COVER S/A	4.43
2 QY310	SPINNER HEAD ASSEMBLY	4.64
3 XZ034	SPOOL CLIP	.29
4 BJ040	SPOOL WASHER	.52
5 BJ108	FLAT WASHER	.36
6 QY021	SPOOL	2.00
6 QY036	SPOOL LIP WASHER	.46
5 QY321-6H	WOUND SPOOL W/ LINE 6#	4.49
7 QY027	CLUTCH RING	.82
8 QY308	CRANK SHAFT ASSEMBLY	2.83
9 JY061	PAWL ACTUATOR	.41
10 QY301	BODY ASSEMBLY	6.08
11 JY060	ANTI-REVERSE PAWL	.41
12 QY315	CENTERSHAFT ASSEMBLY	3.30
13 TY009	THUMB STOP	.93
14 QY323-5	BACK COVER ASSY.	5.77
15 JY054	SLIDE DRAG ACTUATOR	1.18
16 JY121	RETAINER CLIP	.36
17 QY032-1	DRAG STAR	.41
18 QY318-5	HANDLE ASSY.	2.83
19 AZ003	CRANK NUT	.52
20 RY033	RATCHET SPRING	.39
21 QY038	THUMB STOP SPRING	.46
22 QY026-3	CRANK SHAFT BUSHING	2.16

KEY PART NO. NO.	DESCRIPTION	PRICE
1 JY324-12	FRONT COVER S/A	4.43
2 JY310	SPINNERHEAD	4.64
3 JY034	SPOOL CLIP	.41
4 JY040	SPOOL WASHER	.72
5 JY108	FLAT WASHER, DRAG	.35
6 JY021	SPOOL	2.00
6 JY321-8H	WOUND SPOOL 8# MONO HP	4.87
7 NY027	CLUTCH RING	.82
8 JY308	CRANK GEAR SUB-ASSEMBLY	2.83
9 JY061	PAWL ACTUATOR	.41
10 JY301	BODY SUB-ASSM	7.42
11 JY060	ANTI-REVERSE PAWL	.41
12 JY315	CENTER SHAFT S/A	3.35
13 KY009	THUMB STOP	.93
14 JY323-5	BACK COVER S/A	6.08
15 JY054	SLIDE DRAG ACTUATOR	1.18
16 JY121	RETAINER CLIP	.36
17 JY032-1	DRAG STAR	.39
18 JY318-5	HANDLE ASSY.	2.83
19 AZ003	CRANK NUT	.52
20 RY033	RATCHET SPRING	.39
21 QY038	THUMB STOP SPRING	.46
22 WY026	CRANK SHAFT BUSHING	2.16

KEY PART NO. NO.	DESCRIPTION	PRICE
1 JY324-12	FRONT COVER S/A	4.43
2 JY310	SPINNERHEAD	4.64
3 JY034	SPOOL CLIP	.41
4 JY040	SPOOL WASHER	.72
5 JY108	FLAT WASHER, DRAG	.35
6 JY021	SPOOL	2.00
6 JY321-8H	WOUND SPOOL 8# MONO HP	4.87
7 NY027	CLUTCH RING	.82
8 JY308	CRANK GEAR SUB-ASSEMBLY	2.83
9 JY061	PAWL ACTUATOR	.41
10 JY301	BODY SUB-ASSM	7.42
11 JY060	ANTI-REVERSE PAWL	.41
12 JY315	CENTER SHAFT S/A	3.35
13 KY009	THUMB STOP	.93
14 JY323-5	BACK COVER S/A	6.08
15 JY054	SLIDE DRAG ACTUATOR	1.18
16 JY121	RETAINER CLIP	.36
17 JY032-1	DRAG STAR	.39
18 JY318-5	HANDLE ASSY.	2.83
19 AZ003	CRANK NUT	.52
20 RY033	RATCHET SPRING	.39
21 QY038	THUMB STOP SPRING	.46
22 WY026	CRANK SHAFT BUSHING	2.16

## 2020N

KEY PART NO. NO.	DESCRIPTION	PRICE
1 JY324-12	FRONT COVER S/A	4.43
2 JY310	SPINNERHEAD	4.64
3 JY034	SPOOL CLIP	.41
4 JY040	SPOOL WASHER	.72
5 JY108	FLAT WASHER, DRAG	.35
6 JY021	SPOOL	2.00
6 JY321-8H	WOUND SPOOL 8# MONO HP	4.87
7 NY027	CLUTCH RING	.82
8 JY308	CRANK GEAR SUB-ASSEMBLY	2.83
9 JY061	PAWL ACTUATOR	.41
10 JY301	BODY SUB-ASSM	7.42
11 JY060	ANTI-REVERSE PAWL	.41
12 JY315	CENTER SHAFT S/A	3.35
13 KY009	THUMB STOP	.93
14 JY323-5	BACK COVER S/A	6.08
15 JY054	SLIDE DRAG ACTUATOR	1.18
16 JY121	RETAINER CLIP	.36
17 JY032-1	DRAG STAR	.39
18 JY318-5	HANDLE ASSY.	2.83
19 AZ003	CRANK NUT	.52
20 RY033	RATCHET SPRING	.39
21 QY038	THUMB STOP SPRING	.46
22 WY026	CRANK SHAFT BUSHING	2.16

KEY PART NO. NO.	DESCRIPTION	PRICE
1 KY324-5	FRONT COVER ASSY.	4.64
2 KY310-1	SPINNERHEAD S/A	5.00
3 GZ034-1	SPOOL RETAINER CLIP	.52
4 CJ040-1	SPOOL WASHER (METAL)	.88
5 CJ108-1	FLAT WASHER	.36
6 KY021	SPOOL	2.00
6 KY321-14H	SPOOL W/14# HI PERF LINE	5.85
7 KY027-1	CLUTCH RING	.93
8 KY308-1	CRANK SHAFT S/A	2.93
9 JY061	PAWL ACTUATOR	.41
10 KY301	BODY ASSEMBLY 2030	7.73
11 JY060	ANTI-REVERSE PAWL	.41
12 KY315	CENTER SHAFT SUB-ASSEMBLY	3.55
13 KY009	THUMB STOP	.93
14 KY323-6	BACK COVER S/A	6.18
15 KY054-1	SLIDE DRAG ACTUATOR	1.18
16 JY121	RETAINER CLIP	.36
17 KY032-1	DRAG STAR	.41
18 KY318-3	HANDLE ASSY.	3.04
19 AZ003	CRANK NUT	.52
21 KY038	THUMB STOP SPRING	.69
22 KY026-5	CRANK BUSHING	2.64

KEY PART NO. NO.	DESCRIPTION	PRICE
1 KY324-5	FRONT COVER ASSY.	4.64
2 KY310-1	SPINNERHEAD S/A	5.00
3 GZ034-1	SPOOL RETAINER CLIP	.52
4 CJ040-1	SPOOL WASHER (METAL)	.88
5 CJ108-1	FLAT WASHER	.36
6 KY021	SPOOL	2.00
6 KY321-14H	SPOOL W/14# HI PERF LINE	5.85
7 KY027-1	CLUTCH RING	.93
8 KY308-1	CRANK SHAFT S/A	2.93
9 JY061	PAWL ACTUATOR	.41
10 KY301	BODY ASSEMBLY 2030	7.73
11 JY060	ANTI-REVERSE PAWL	.41
12 KY315	CENTER SHAFT SUB-ASSEMBLY	3.55
13 KY009	THUMB STOP	.93
14 KY323-6	BACK COVER S/A	6.18
15 KY054-1	SLIDE DRAG ACTUATOR	1.18
16 JY121	RETAINER CLIP	.36
17 KY032-1	DRAG STAR	.41
18 KY318-3	HANDLE ASSY.	3.04
19 AZ003	CRANK NUT	.52
21 KY038	THUMB STOP SPRING	.69
22 KY026-5	CRANK BUSHING	2.64

## 2030N

KEY PART NO. NO.	DESCRIPTION	PRICE
1 KY324-5	FRONT COVER ASSY.	4.64
2 KY310-1	SPINNERHEAD S/A	5.00
3 GZ034-1	SPOOL RETAINER CLIP	.52
4 CJ040-1	SPOOL WASHER (METAL)	.88
5 CJ108-1	FLAT WASHER	.36
6 KY021	SPOOL	2.00
6 KY321-14H	SPOOL W/14# HI PERF LINE	5.85
7 KY027-1	CLUTCH RING	.93
8 KY308-1	CRANK SHAFT S/A	2.93
9 JY061	PAWL ACTUATOR	.41
10 KY301	BODY ASSEMBLY 2030	7.73
11 JY060	ANTI-REVERSE PAWL	.41
12 KY315	CENTER SHAFT SUB-ASSEMBLY	3.55
13 KY009	THUMB STOP	.93
14 KY323-6	BACK COVER S/A	6.18
15 KY054-1	SLIDE DRAG ACTUATOR	1.18
16 JY121	RETAINER CLIP	.36
17 KY032-1	DRAG STAR	.41
18 KY318-3	HANDLE ASSY.	3.04
19 AZ003	CRANK NUT	.52
21 KY038	THUMB STOP SPRING	.69
22 KY026-5	CRANK BUSHING	2.64

Prices subject to change without notice. Prices do not include postage and handling.

**PLEASE ORDER BY PART NUMBER**

Rev. 11/90

Zebco Division Brunswick Corporation, Box 270, Tulsa, OK 74101 USA 918-836-5581

