

BRUNSWICK CORPORATION

CONSUMER DIVISION

POST OFFICE BOX 270,  
TULSA, OKLAHOMA 74101

# ZEBCO PARTS LIST AND ORDER BLANK

## MODEL US76

PLEASE ORDER BY PART NUMBER, NOT KEY NUMBER

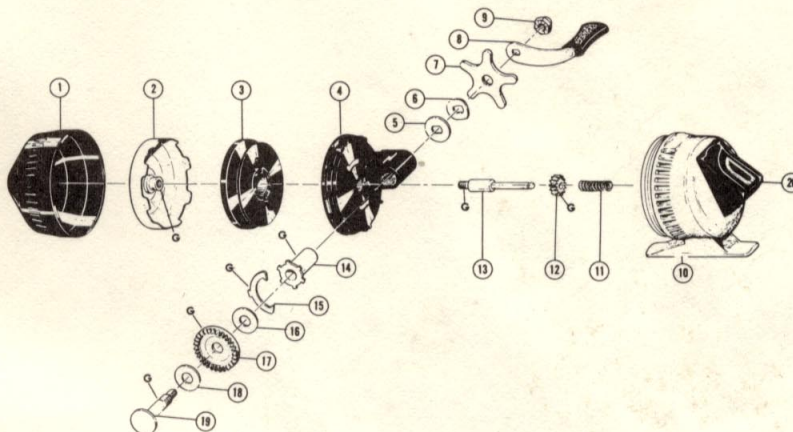

IF REQUIRED REPAIRS CANNOT BE MADE AT YOUR NEAREST FACTORY APPROVED SERVICE STATION, YOU MAY ORDER THE FOLLOWING REPLACEMENT PARTS DIRECT FROM THE FACTORY OR RETURN REEL TO FACTORY.

Your Order No. \_\_\_\_\_ Date \_\_\_\_\_  
 Charge To \_\_\_\_\_ Ship To \_\_\_\_\_  
 Address \_\_\_\_\_ Address \_\_\_\_\_  
 City & State \_\_\_\_\_ City & State \_\_\_\_\_

### DEFECTIVE PARTS REPLACED AT FACTORY ONLY

| KEY NO. | DESCRIPTION       | PART NO. | QUANTITY | PRICE  | EXTENSION |
|---------|-------------------|----------|----------|--------|-----------|
| 1       | Front Cover       | DZ-24-A  |          | \$ .35 |           |
| 2       | Spinner Head      | DZ-10-SA |          | .35    |           |
| 3       | Spool (Empty)     | DZ-21    |          | .50    |           |
| 4       | Body              | DZ-1-SA  |          | .35    |           |
| 5       | Flat Washer       | DZ-30    |          | .05    |           |
| 6       | Curved Washer     | DZ-31    |          | .05    |           |
| 7       | Star Drag         | DZ-59    |          | .10    |           |
| 8       | Handle            | DX-18-SA |          | .15    |           |
| 9       | Crank Nut         | DZ-3     |          | .05    |           |
| 10      | Back Cover        | DZ-23-SA |          | .35    |           |
| 11      | Spring            | DZ-20    |          | .05    |           |
| 12      | Pinion Gear       | DZ-11    |          | .15    |           |
| 13      | Center Shaft      | DZ-15-SA |          | .15    |           |
| 14      | Crank Bushing     | DZ-26    |          | .10    |           |
| 15      | Anti-Reverse Pawl | DZ-60    |          | .15    |           |
| 16      | Fiber Washer      | DZ-33    |          | 2/.05  |           |
| 17      | Face Gear         | DZ-12    |          | .25    |           |
| 18      | Fiber Washer      | DZ-33    |          | 2/.05  |           |
| 19      | Crank Shaft       | DZ-8-SA  |          | .15    |           |
| 20      | Thumb Stop        | DZ-9     |          | .10    |           |

(Continued on Reverse Side)