

# QUANTUM ENERGY (1 Series)

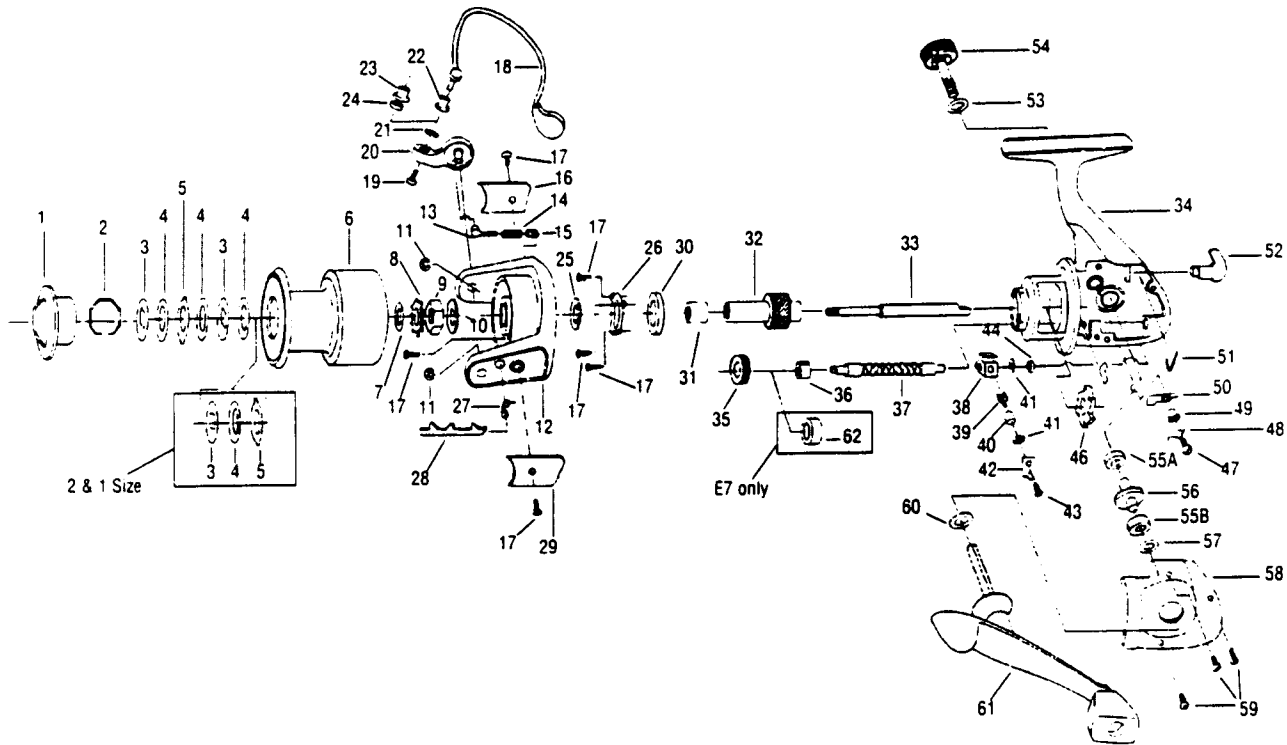

## ENERGY E7-1 / E5-1 / E3-1 / E2-1 PARTS LIST

KEY NO.	E7-1	E5-1	E3-1	E2-1	DESCRIPTION	RICE	KEY NO.	E7-1	E5-1	E3-1	E2-1	DESCRIPTION	RICE
1	FH332-02	FH332-01	FH332-02	FH332-03	DRAG KNOB ASSEMBLY	2.80	32	FH011-01	-	-	-	PINION	3.35
2	AQ038-01	-	-	-	DRAG RETAINER	.30	33	FH015-01	FH015-01	FH015-01	FH015-02	MAIN SHAFT	2.45
3	TU080-01	-	-	-	DRAG WASHER D	1.10	34	FH301-08	FH301-04	FH301-05	FH301-06	BODY ASSEMBLY	12.95
4	GH033-01	-	-	-	DRAG WASHER B	2.52	35	FH200-01	-	-	-	LEVEL WIND GEAR	1.60
5	TU081-01	-	-	-	DRAG WASHER A	1.10	36	GH202-01	TU202-01	TU202-01	TU202-01	WORM SHAFT BUSHING LEFT	7.40
6	ZQ321-04	ZQ321-01	ZQ321-02	ZQ321-03	SPOOL ASSEMBLY	7.00	37	FH201-01	-	-	-	WORM SHAFT	2.30
7	TU030-01	-	-	-	CLICK GEAR WASHER	.90	38	FH204-01	-	-	-	PAWL HOLDER	1.75
8	TU037-01	-	-	-	CLICK GEAR	1.15	39	TU207-01	-	-	-	PAWL	2.55
9	GU006-02	-	-	-	ROTOR NUT	.80	40	UQ208-03	-	-	-	PAWL COLLAR	.30
10	TL065-01	-	-	-	ROTOR D WASHER	1.10	41	GU105-31	-	-	-	PAWL/LEVEL WIND WASHER	.30
11	GH034-01	-	-	-	E-CLIP	.30	42	GH205-01	-	-	-	PAWL HOLDER RETAINER	1.15
12	ZQ009-04	ZQ009-01	ZQ009-02	ZQ009-03	ROTOR	7.40	43	UQ100-02	-	-	-	MAIN SHAFT SCREW	.30
13	QL031-01	-	-	-	BAIL SPRING SHAFT	.75	44	GH202-02	GH203-01	GH203-01	GH203-01	WORM SHAFT BUSHING RIGHT	7.40
14	KQ049-05	-	-	-	BAIL SPRING	.30	45	TU206-01	-	-	-	WORM SHAFT RETAINER	1.10
15	QL020-01	-	-	-	BAIL SPRING HOLDER	.30	46	GH074-01	-	-	-	CLUTCH BEARING	10.40
16	ZQ087-04	ZQ087-01	ZQ087-02	ZQ087-03	ARM LEVER/ SPRING COVER	2.60	47	GH077-01	-	-	-	ANTI-REVERSE PAWL SCREW	.30
17	UQ057-01	-	-	-	SCREW	.30	48	TU061-01	-	-	-	ANTI-REVERSE PAWL SPRING	.30
18	ZQ347-04	ZQ347-01	ZQ347-02	ZQ347-03	BAIL ASSEMBLY	3.70	49	TU091-01	-	-	-	ANTI-REVERSE PAWL POST	1.10
19	AQ108-02	-	-	-	LINE SLIDER SCREW	.30	50	TU063-01	-	-	-	ANTI-REVERSE PAWL	1.15
20	ZQ007-04	ZQ007-01	ZQ007-02	ZQ007-03	ARM LEVER	2.25	51	GH089-01	-	-	-	ANTI-REVERSE LEVER SPRING	1.15
21	GU105-25	-	-	-	LINE ROLLER WASHER	.30	52	GH090-01	GH090-01	GH090-02	GH090-02	ANTI-REVERSE LEVER	2.25
22	TU004-01	TU004-01	N/A	N/A	LINE ROLLER WITH BALL BEARING	6.70	53	BQ105-01	-	-	-	HANDLE CAP WASHER	.30
23	N/A	N/A	GH018-01	GH018-01	LINE ROLLER BUSHING	1.10	54	GH073-01	GH073-01	GH073-02	GH073-01	HANDLE CAP/SCREW	1.75
24	N/A	N/A	GH004-01	GH004-01	LINE ROLLER	3.15	55A	BL157-01	BL157-01	GH013-01	GH013-01	BEARING	5.25
	GU105-12	-	-	-	ROTOR WASHER	.30	55B	BL157-01	BL157-01	BL157-01	GH013-01	BEARING	5.25
	FH040-01	-	-	-	BEARING PLATE	.35	56	FH012-01	-	-	-	DRIVE GEAR	1.05
27	GH049-01	-	-	-	KICK LEVER SPRING	.30	57	GU105-13	-	-	-	ADJUST WASHER	.62
28	ZQ019-01	-	-	-	KICK LEVER	1.90	58	FH023-08	FH023-04	FH023-05	FH023-06	SIDECOVER	5.10
29	ZQ024-04	ZQ024-01	ZQ024-02	ZQ024-03	KICK LEVER COVER	2.60	59	KQ057-01	-	-	-	SIDECOVER SCREWS	.30
30	BL157-01	-	-	-	PINION BALL BEARING	5.25	60	BQ132-01	-	-	-	HANDLE STAND WASHER	.30
31	TU052-01	-	-	-	BEARING SLEEVE	2.60	61	FH318-03	FH318-01	FH318-02	FH318-03	HANDLE ASSEMBLY	11.10
							62	GH212-01	N/A	N/A	N/A	WORM SHAFT COLLAR	1.10