

QUANTUM ENERGY (4 Series)

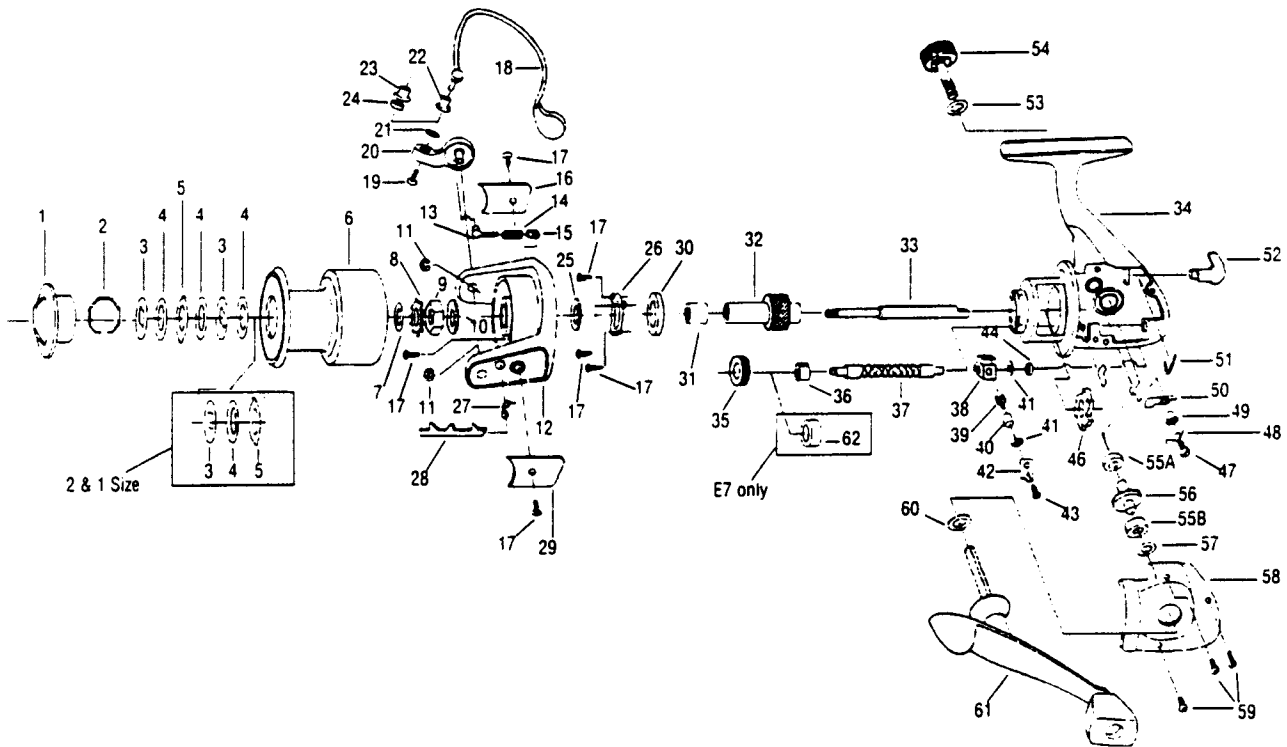

ENERGY E7-4 / E5-4 / E3-4 / E2-4 PARTS LIST

KEY					DESCRIPTION	RICE	KEY					DESCRIPTION	RICE
NO.	E7-4	E5-4	E3-4	E2-4			NO.	E7-4	E5-4	E3-4	E2-4		
1	GH332-02	GH332-01	GH332-02	GH332-03	DRAG KNOB ASSEMBLY	2.80	33	TU015-01	TU015-01	TU015-02	MAIN SHAFT	3.05	
2	AQ038-01	-	-	-	DRAG RETAINER	.30	34	GH301-04	GH301-01	GH301-02	GH301-03	BODY ASSEMBLY	12.95
3	TU080-01	-	-	-	DRAG WASHER D	1.10	35	GH200-01	-	-	-	LEVEL WIND GEAR	2.85
4	GH033-01	-	-	-	DRAG WASHER B	2.52	36	GH202-01	TU202-01	TU202-01	TU202-01	WORM SHAFT BUSHING LEFT	7.40
5	TU081-01	-	-	-	DRAG WASHER A	1.10	37	TU201-01	-	-	-	WORM SHAFT	2.80
6	GH321-04	GH321-01	GH321-02	GH321-03	SPOOL ASSEMBLY	7.00	38	TU204-01	-	-	-	PAWL HOLDER	3.15
7	TU030-01	-	-	-	CLICK GEAR WASHER	.90	39	TU207-01	-	-	-	PAWL	2.55
8	TU037-01	-	-	-	CLICK GEAR	1.15	40	UQ208-03	-	-	-	PAWL COLLAR	.30
9	GU006-02	-	-	-	ROTOR NUT	.80	41	GU105-31	-	-	-	PAWL/LEVEL WIND WASHER	.30
10	TL065-01	-	-	-	ROTOR D WASHER	1.10	42	GH205-01	-	-	-	PAWL HOLDER RETAINER	1.15
11	GH034-01	-	-	-	E-CLIP	.30	43	UQ100-02	-	-	-	MAIN SHAFT SCREW	.30
12	GH009-04	GH009-01	GH009-02	GH009-03	ROTOR	9.25	44	GH202-02	GH203-01	GH203-01	GH203-01	WORM SHAFT BUSHING RIGHT	7.40
13	QL031-01	-	-	-	BAIL SPRING SHAFT	.75	45	TU208-01	-	-	-	WORM SHAFT RETAINER	1.10
14	KQ049-05	-	-	-	BAIL SPRING	.30	46	GH074-01	-	-	-	CLUTCH BEARING	10.40
15	QL020-01	-	-	-	BAIL SPRING HOLDER	.30	47	GH077-01	-	-	-	ANTI-REVERSE PAWL SCREW	.15
16	GH087-04	GH087-01	GH087-02	GH087-03	ARM LEVER SPRING COVER	2.60	48	TU061-01	-	-	-	ANTI-REVERSE PAWL SPRING	.30
17	UQ057-01	-	-	-	SCREW	.30	49	TU091-01	-	-	-	ANTI-REVERSE PAWL POST	1.10
18	GH347-04	GH347-01	GH347-02	GH347-03	BAIL ASSEMBLY	3.70	50	TU063-01	-	-	-	ANTI-REVERSE PAWL	1.15
19	AQ108-02	-	-	-	LINE SLIDER SCREW	.30	51	GH089-01	-	-	-	ANTI-REVERSE LEVER SPRING	1.15
20	GH007-04	GH007-01	GH007-02	GH007-03	ARM LEVER	2.25	52	GH090-01	GH090-01	GH090-02	GH090-02	ANTI-REVERSE LEVER	2.25
21	GU105-25	-	-	-	LINE ROLLER WASHER	.30	53	BQ105-01	-	-	-	HANDLE CAP WASHER	.30
22	TU004-01	TU004-01	N/A	N/A	LINE ROLLER WITH BALL BEARING	6.70	54	GH073-01	-	-	-	HANDLE CAP/SCREW	1.75
24	N/A	N/A	GH004-01	GH004-01	LINE ROLLER	3.15	55A	BL157-01	BL157-01	GH013-01	GH013-01	BEARING	1.75
25	GU105-12	-	-	-	ROTOR WASHER	.30	55B	BL157-01	BL157-01	BL157-01	GH013-01	BEARING	5.25
26	UQ040-01	-	-	-	BEARING PLATE	1.10	56	GH012-01	-	-	-	DRIVE GEAR	1.90
27	GH049-01	-	-	-	KICK LEVER SPRING	.30	57	GU105-13	-	-	-	ADJUST WASHER	.62
28	GH019-01	-	-	-	KICK LEVER	1.90	58	GH023-04	GH023-01	GH023-02	GH023-03	SIDECOVER	5.40
29	GH024-04	GH024-01	GH024-02	GH024-03	KICK LEVER COVER	2.60	59	KQ057-01	-	-	-	SIDECOVER SCREWS	.30
30	UK028-01	-	-	-	PINION BALL BEARING	5.55	60	BQ132-01	-	-	-	HANDLE STAND WASHER	.30
31	TU052-01	-	-	-	BEARING SLEEVE	2.80	61	GH318-03	GH318-01	GH318-02	GH318-03	HANDLE ASSEMBLY	11.10
32	GH011-01	-	-	-	PINION	4.10	62	GH212-01	N/A	N/A	N/A	WORM SHAFT COLLAR	1.10