

QUANTUM QB4

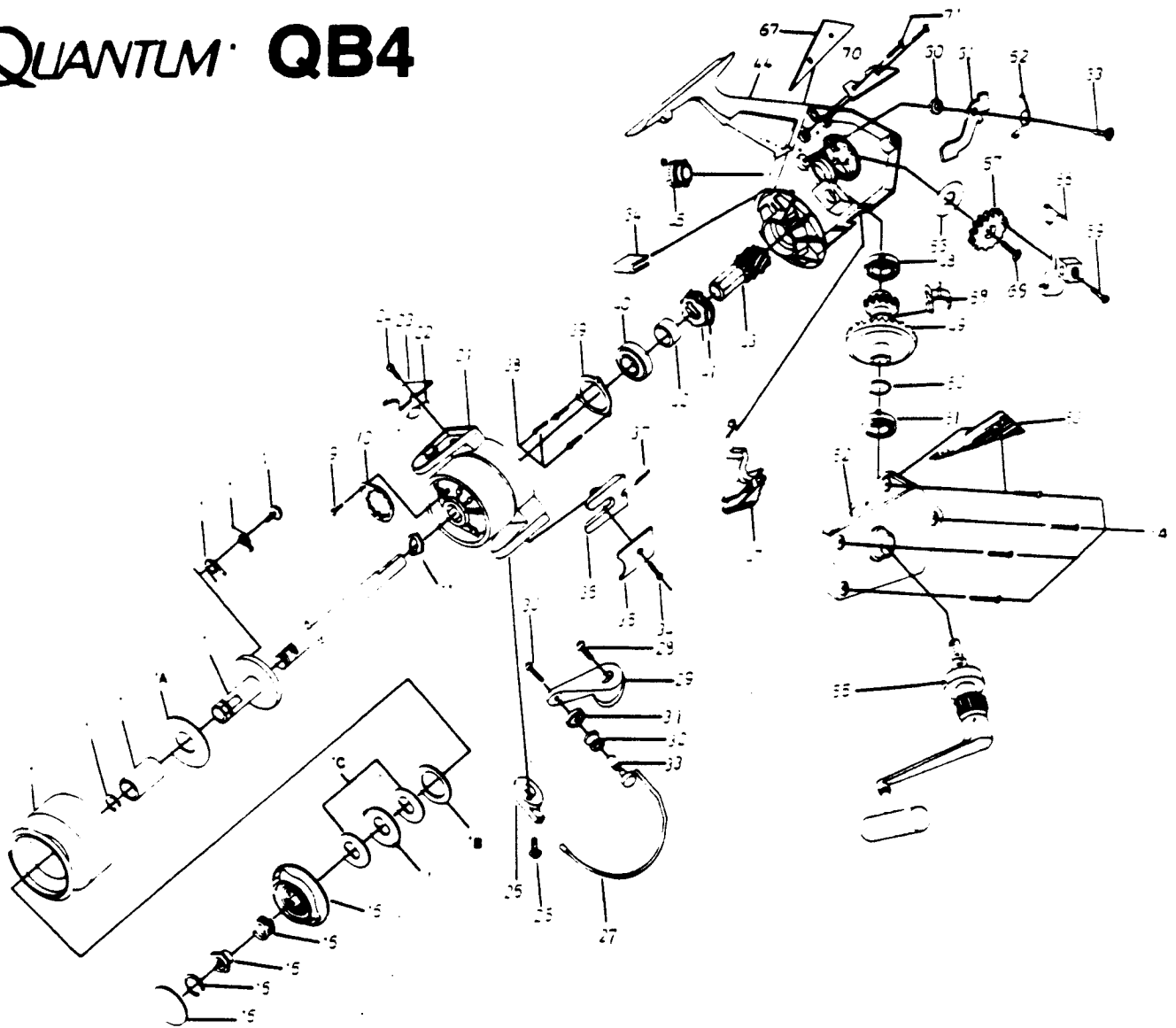

KEY PART

NO.	NO.	DESCRIPTION	PRICE
1C	UK039	DRAG WASHER 'B'	1.44
1B	UK046	DRAG WASHER 'C'	1.29
1A	UK163	SPOOL RETAINER BUSHING	1.87
1	UK321	SPOOL ASSY.	7.96
9	UK058	NUT RING SCREW	1.34
10	UK088	ROTOR NUT RING	.91
11	UK006	ROTOR NUT	1.29
12	UK315	CENTER SHAFT	6.70
16	UK050	DRAG KNOB ASSY.	4.82
21	UK009	ROTOR	4.87
22	UK022	ARM LEVER SPRING	.91
23	UK087	ARM LEVER COVER	1.07
24	UK085	ARM LEVER COVER SCREW	1.34
25	UK048	BAIL HOLDER SCREW	1.34
26	UK345	BAIL HOLDER	3.21
27	UK346	BAIL WIRE	3.38
28	UK051	ARM LEVER SCREW	1.50
29	UK007	ARM LEVER	1.34
30	UK108	LINE SLIDER SCREW	1.39
31	UK017	LINE SLIDER COLLAR	1.34
32	UK004	LINE ROLLER	2.09
33	UK016	LINE ROLLER BUSHING	1.61
34	UK037	BAIL HOLDER COVER SCREW	.75
35	UK024	BAIL HOLDER COVER	1.07
36	UK019	KICK LEVER	1.50
37	UK049	KICK LEVER SPRING	.75
38	UK080	BEARING COVER SCREW	1.07
39	UK040	BEARING COVER	1.39
40	UK028	PINION BEARING	9.37

KEY PART

NO.	NO.	DESCRIPTION	PRICE
41	UK060	STOPPER GEAR	2.09
42	UK126	PINION COLLAR	1.29
43	UK011	PINION	6.43
44	UK301	BODY	6.70
45	UK073	DUST COVER	1.44
47	UK059	ANTI-REVERSE SWITCH	.97
48	UK013	BODY BUSHING	.97
49	UK012	CRANK GEAR	6.43
50	UK026	CRANK GEAR WASHER	.91
51	UK164	SIDE PLATE BUSHING	.97
52	UK323	SIDE PLATE	1.93
53	UK324	GROOVE PART 'L'	.91
54	UK057	SIDE PLATE SCREW	2.31
55	UK318	HANDLE ASSY.	11.25
56	UK165	OSC. GUIDE WASHER	.97
57	UK053	OSCILLATOR GEAR	1.29
58	UK025	OSCILLATOR GUIDE	1.29
59	UK084	CENTER SHAFT SCREW	.75
60	UK014	STOPPER SUPPORT BUSHING	.91
61	UK063	STOPPER	1.44
62	UK061	STOPPER SPRING	.91
63	UK089	STOPPER SCREW	.97
64	UK166	STOPPER SUPPORT	1.87
67	UK325	GROOVE PART 'R'	.91
68	UK086	SLIDING SPRING	.75
69	UK078	OSC. GEAR SCREW	1.34
70	UK167	OSC. GUIDE SUPPORT	1.50
71	UK168	OSC. SUPPORT SCREW	.75

Prices subject to change without notice. Prices do not include postage and handling.

PLEASE ORDER BY PART NUMBER

Rev. 11/90

Zebco Division Brunswick Corporation, Box 270, Tulsa, OK 74101 USA 918-836-5581

