

QUANTUM QB5

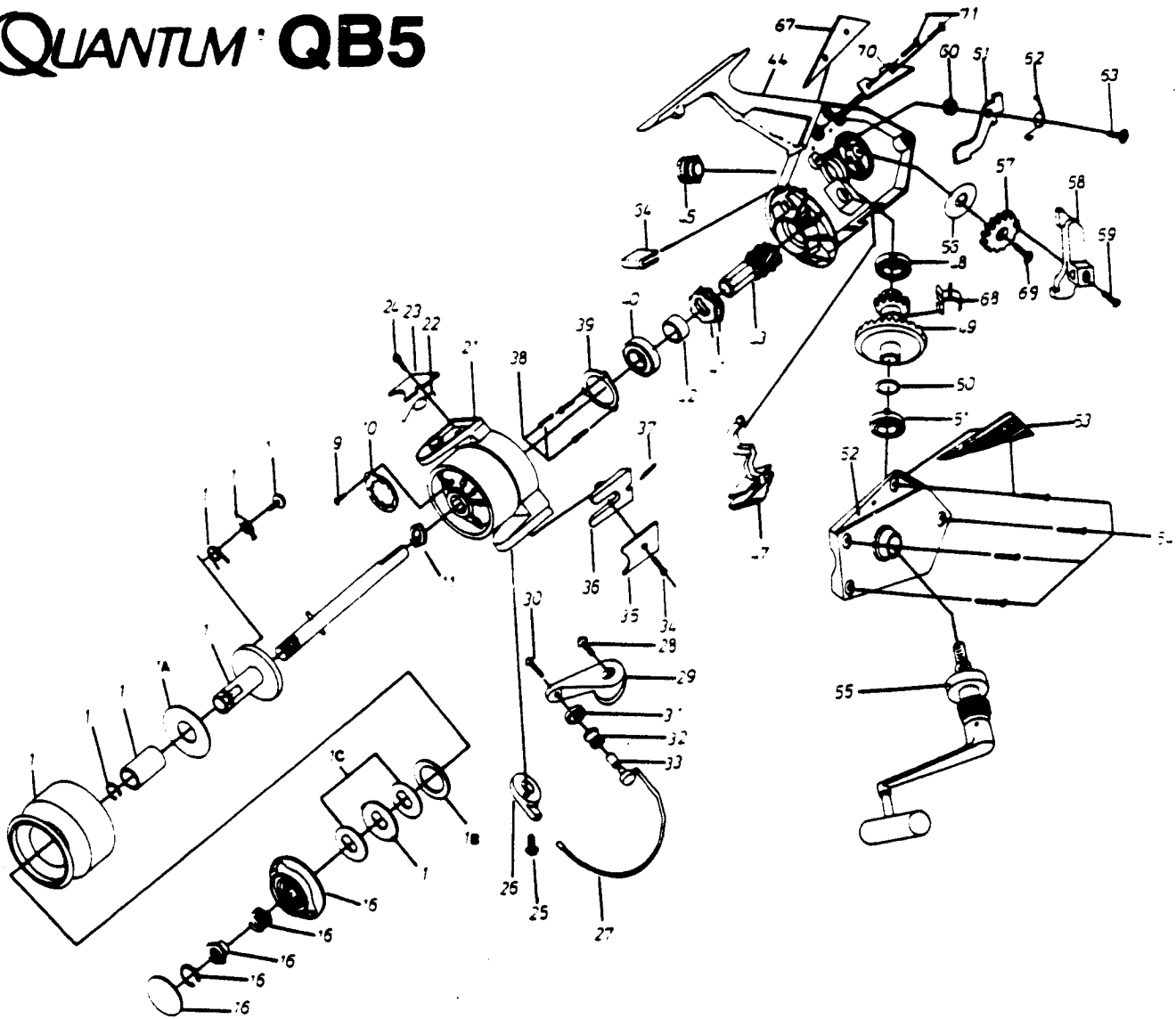

KEY PART NO.	DESCRIPTION	PRICE	KEY PART NO.	DESCRIPTION	PRICE
10 WK039	DRAG WASHER 'B'	1.93	41 WK060	STOPPER GEAR	2.41
11 WK046	DRAG WASHER 'C'	1.39	42 WK126	PINION COLLAR	1.34
12 WK163	SPOOL RETAINER BUSHING	3.11	43 WK011	PINION	6.70
1 WK321	SPOOL ASSY.	8.46	44 WK301	BODY	7.87
9 UK058	NUT RING SCREW	1.34	45 WK073	DUST COVER	1.61
10 WK088	ROTOR NUT RING	1.07	47 WK059	ANTI-REVERSE SWITCH	.91
11 WK006	ROTOR NUT	1.34	48 WK013	BODY BUSHING	.91
12 WK315	CENTER SHAFT	6.43	49 WK012	CRANK GEAR	6.43
16 WK050	DRAG KNOB ASSY.	5.25	50 WK026	CRANK GEAR WASHER	.91
21 WK009	ROTOR	5.36	51 WK164	SIDE PLATE BUSHING	.91
22 WK022	ARM LEVER SPRING	.91	52 WK323	SIDE PLATE	1.93
23 WK087	ARM LEVER COVER	1.29	53 WK324	GROOVE PART 'L'	.91
24 UK084	CENTER SHAFT SCREW	.75	54 WK057	SIDE PLATE SCREW	2.14
25 UK048	BAIL HOLDER SCREW	1.34	55 WK318	HANDLE ASSY.	11.73
26 WK345	BAIL HOLDER	3.32	56 WK165	OSC. GUIDE WASHER	.91
27 WK346	BAIL WIRE	3.75	57 WK053	OSCILLATOR GEAR	1.34
28 UK051	ARM LEVER SCREW	1.50	58 WK025	OSCILLATOR GUIDE	1.34
29 WK007	ARM LEVER	1.34	59 WK084	CENTER SHAFT SCREW	.75
30 UK108	LINE SLIDER SCREW	1.39	60 WK014	STOPPER SUPPORT BUSHING	.91
31 WK017	LINE SLIDER COLLAR	1.39	61 WK063	STOPPER	1.61
32 WK004	LINE ROLLER	2.14	62 WK061	STOPPER SPRING	.91
33 UK016	LINE ROLLER BUSHING	1.61	63 UK089	STOPPER SCREW	.97
34 UK037	BAIL HOLDER COVER SCREW	.75	64 UK166	STOPPER SUPPORT	1.87
35 WK024	BAIL HOLDER COVER	1.29	67 WK325	GROOVE PART 'R'	.91
36 WK019	KICK LEVER	1.61	68 WK086	SLIDING SPRING	.75
37 UK049	KICK LEVER SPRING	.75	69 WK078	OSC. GEAR SCREW	1.39
38 UK080	BEARING COVER SCREW	1.07	70 WK167	OSC. GUIDE SUPPORT	1.61
39 WK040	BEARING COVER	2.09	71 UK168	OSC. SUPPORT SCREW	.75
40 WK028	PINION BEARING	10.01			

Prices subject to change without notice. Prices do not include postage and handling.

PLEASE ORDER BY PART NUMBER

Rev. 11/90

Zebco Division Brunswick Corporation, Box 270, Tulsa, OK 74101 USA 918-636-5661

