

# QUANTUM QB6

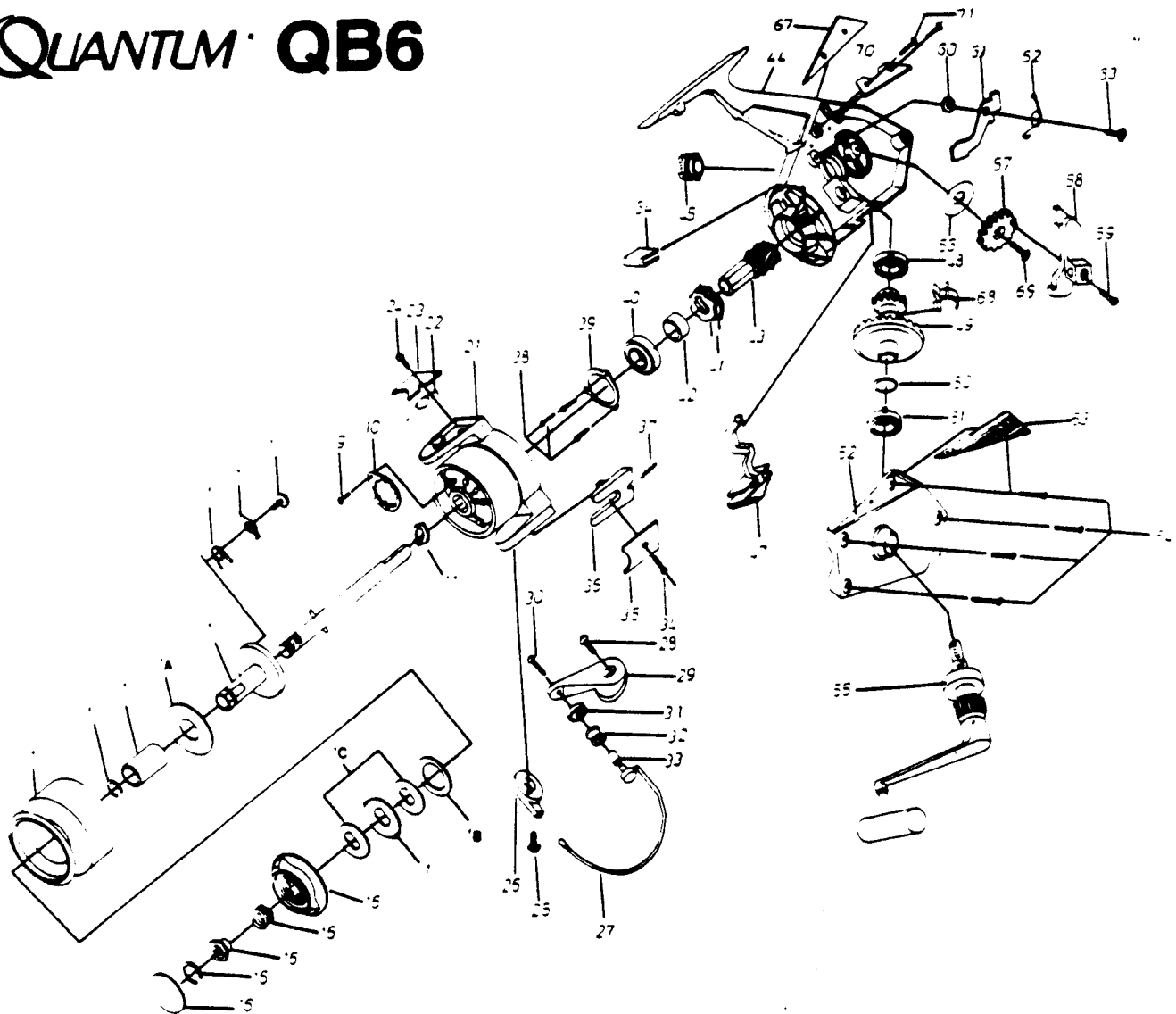

KEY PART NO. NO.	DESCRIPTION	PRICE
1C WK039	DRAG WASHER 'B'	1.93
1B WK046	DRAG WASHER 'C'	1.39
1A WK163	SPOOL RETAINER BUSHING	3.11
1 XK321	SPOOL ASBY.	8.46
9 UK058	NUT RING SCREW	1.34
10 WK088	ROTOR NUT RING	1.07
11 WK006	ROTOR NUT	1.34
12 WK315	CENTER SHAFT	6.43
16 WK050	DRAG KNOB ASBY.	5.25
21 XK009	ROTOR	5.79
22 WK022	ARM LEVER SPRING	.91
23 WK087	ARM LEVER COVER	1.29
24 UK085	ARM LEVER COVER SCREW	1.34
25 UK048	BAIL HOLDER SCREW	1.34
26 WK345	BAIL HOLDER	3.32
27 XK346	BAIL WIRE	3.75
28 UK051	ARM LEVER SCREW	1.50
29 WK007	ARM LEVER	1.34
30 UK108	LINE SLIDER SCREW	1.39
31 WK017	LINE SLIDER COLLAR	1.29
32 WK004	LINE ROLLER	2.14
33 UK016	LINE ROLLER BUSHING	1.61
34 UK037	BAIL HOLDER COVER SCREW	.75
35 WK024	BAIL HOLDER COVER	1.29
36 WK019	KICK LEVER	1.61
37 UK049	KICK LEVER SPRING	.75
38 UK080	BEARING COVER SCREW	1.07
39 WK040	BEARING COVER	2.09
40 WK028	PINION BEARING	10.01

KEY PART NO. NO.	DESCRIPTION	PRICE
41 WK060	STOPPER GEAR	2.41
42 WK126	PINION COLLAR	1.34
43 WK011	PINION	6.70
44 XK301	BODY	7.87
45 WK073	DUST COVER	1.61
47 WK059	ANTI-REVERSE SWITCH	.91
48 WK013	BODY BUSHING	.91
49 WK012	CRANK GEAR	6.43
50 WK026	CRANK GEAR WASHER	.91
51 WK164	SIDE PLATE BUSHING	.91
52 XK323	SIDE PLATE	1.93
53 WK324	GROOVE PART 'L'	.91
54 WK057	SIDE PLATE SCREW	2.14
55 WK318	HANDLE ASBY.	11.73
56 WK165	OSC. GUIDE WASHER	.91
57 WK053	OSCILLATOR GEAR	1.34
58 WK025	OSCILLATOR GUIDE	1.34
59 WK084	CENTER SHAFT SCREW	.75
60 WK014	STOPPER SUPPORT BUSHING	.91
61 WK063	STOPPER	1.61
62 WK061	STOPPER SPRING	.91
63 UK089	STOPPER SCREW	.97
64 UK166	STOPPER SUPPORT	1.87
67 WK325	GROOVE PART 'R'	.91
68 WK086	SLIDING SPRING	.75
69 WK078	OSC. GEAR SCREW	1.39
70 WK167	OSC. GUIDE SUPPORT	1.61
71 UK168	OSC. SUPPORT SCREW	.75

Prices subject to change without notice. Prices do not include postage and handling.

**PLEASE ORDER BY PART NUMBER**

Rev. 11/90

Zebco Division Brunswick Corporation, Box 270, Tulsa, OK 74101 USA 918-636-6581

