

QUANTUM® QB8

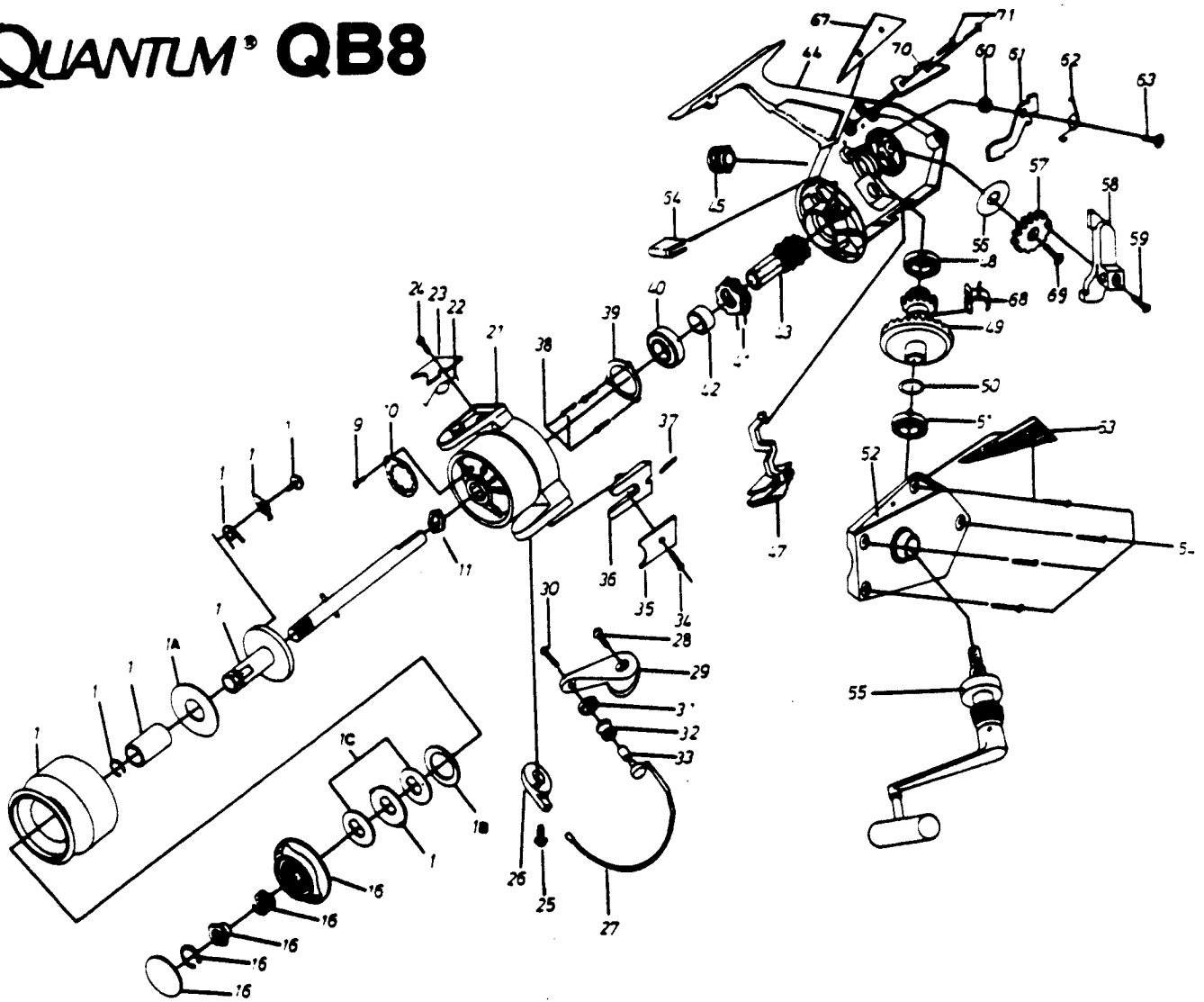

KEY PART NO. NO.	DESCRIPTION	PRICE
1C WK039	DRAG WASHER 'B'	1.93
1B WK046	DRAG WASHER 'C'	1.39
1A YK163	SPOOL RETAINER BUSHING	3.21
1 YK321	SPOOL ASSY.	12.04
9 UK058	NUT RING SCREW	1.34
10 WK088	ROTOR NUT RING	1.07
11 YK006	ROTOR NUT	1.44
12 YK315	CENTER SHAFT	7.45
16 YK050	DRAG KNOB ASSY.	5.79
21 YK009	ROTOR	6.64
22 YK022	ARM LEVER SPRING	.91
23 YK087	ARM LEVER COVER	1.39
24 UK085	ARM LEVER COVER SCREW	1.34
25 YK048	BAIL HOLDER SCREW	1.39
26 YK345	BAIL HOLDER	3.38
27 YK346	BAIL WIRE	3.85
28 YK051	ARM LEVER SCREW	1.61
29 YK007	ARM LEVER	1.34
30 YK108	LINE SLIDER SCREW	1.44
31 YK017	LINE SLIDER COLLAR	1.44
32 YK004	LINE ROLLER	2.19
33 YK016	LINE ROLLER BUSHING	1.93
34 UK037	BAIL HOLDER COVER SCREW	.75
35 YK024	BAIL HOLDER COVER	1.39
36 YK019	KICK LEVER	1.93
37 YK049	KICK LEVER SPRING	.97
38 UK080	BEARING COVER SCREW	1.07
39 YK040	BEARING COVER	2.09
40 YK028	PINION BEARING	10.12

KEY PART NO. NO.	DESCRIPTION	PRICE
41 YK060	STOPPER GEAR	2.68
42 YK126	PINION COLLAR	1.39
43 YK011	PINION	7.23
44 YK301	BODY	9.11
45 YK073	DUST COVER	1.93
47 YK059	ANTI-REVERSE SWITCH	.91
48 WK013	BODY BUSHING	.91
49 YK012	CRANK GEAR	7.45
50 WK026	CRANK GEAR WASHER	.91
51 WK164	SIDE PLATE BUSHING	.91
52 YK323	SIDE PLATE	1.93
53 YK324	GROOVE PART 'L'	.91
54 WK057	SIDE PLATE SCREW	2.14
55 YK318	HANDLE ASSY.	13.66
56 YK165	OSC. GUIDE WASHER	1.29
57 YK053	OSCILLATOR GEAR	1.44
58 YK025	OSCILLATOR GUIDE	1.44
59 WK084	CENTER SHAFT SCREW	.75
60 WK014	STOPPER SUPPORT BUSHING	.91
61 YK063	STOPPER	1.87
62 YK061	STOPPER SPRING	1.87
63 UK089	STOPPER SCREW	.97
64 YK166	STOPPER SUPPORT	1.93
67 YK325	GROOVE PART 'R'	.91
68 WK086	SLIDING SPRING	.75
69 YK078	OSC. GEAR SCREW	1.44
70 YK167	OSC. GUIDE SUPPORT	1.87
71 UK168	OSC. SUPPORT SCREW	.75

Prices subject to change without notice. Prices do not include postage and handling.

PLEASE ORDER BY PART NUMBER

Rev. 11/90

Zebco Division Brunswick Corporation, Box 270, Tulsa, OK 74101 USA 918-636-6681

