

QUANTUM QC4

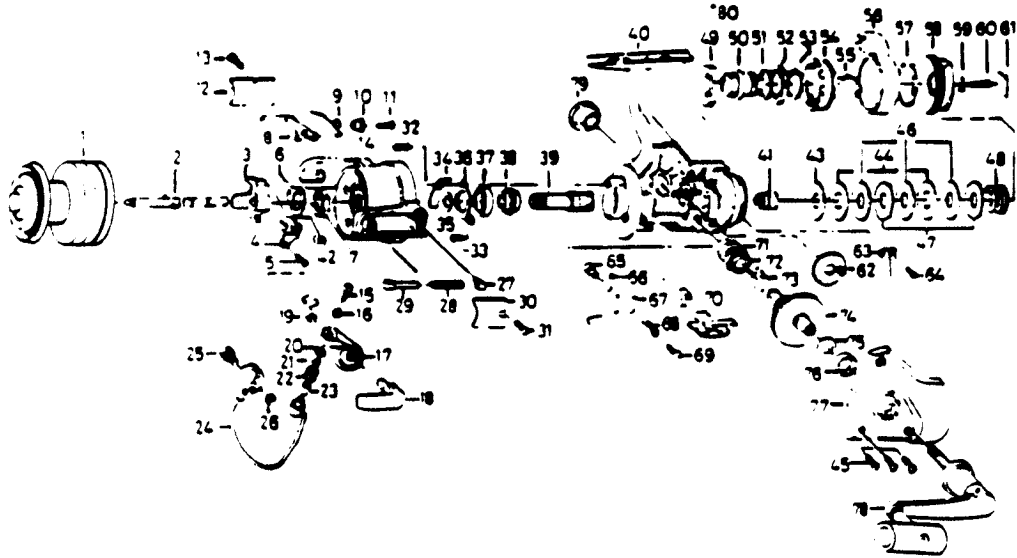

KEY PART NO.	DESCRIPTION	PRICE	KEY PART NO.	DESCRIPTION	PRICE
NT321-1	SPOOL ASBY. EXTRA	6.88	43 NT039	DRAG WASHER B	1.66
1 NT321	SPOOL ASBY. (MAIN)	6.88	44 NT041	BARRED WASHER	1.83
2 NT315	MAIN SHAFT	3.73	45 NT057	SIDE COVER SCREW	2.87
3 NT025	OSCILLATING SLIDER	1.83	46 NT046	DRAG WASHER C	2.87
4 NT083	OSC. SLIDER RETAINER	.98	47 NT030	KEY WASHER	1.83
5 NT161	OSC. SLIDER SCREW	.85	48 NT031	DRAG COIL SPRING	1.66
6 NT088	ROTOR NUT LOCK WASHER	1.43	49 NT112	DRAG NUT A	3.44
7 NT006	ROTOR NUT	1.27	50 NT121	DRAG SCREW	1.43
8 NT019	BAIL TRIP LEVER	2.24	51 NT106	DRAG SCREW WASHER A	.98
9 NT049	BAIL TRIP LEVER SPRING	.85	52 NT110	DRAG HOLDER	1.83
10 NT137	BAIL TRIP LV. BUSHING	1.09	53 NT111	DRAG SCREW WASHER B	.98
11 NT037	BAIL TRIP LEVER SCREW	.85	54 NT117	DRAG NUT B	4.58
12 NT024	BAIL TRIP COVER	1.09	55 NT118	DRAG SPRING	1.09
13 NT085	BAIL SPG COVER SCRM	1.09	56 NT094	POWER LEVER	4.53
14 NT009	ROTOR	5.16	57 NT098	POWER LEVER RETAINER	.46
15 NT108	BAIL SCREW	1.27	58 NT032	DRAG KNOB	3.39
16 NT102	LOCK WASHER	.46	59 NT119	DRAG KNOB WASHER	.85
17 NT007	BAIL ARM	1.83	60 NT079	DRAG KNOB SCREW	.85
18 NT115	CAM CAST LEVER	5.68	61 NT120	DRAG KNOB NAME PLATE	1.27
19 NT002	CAM CAST LV. RETAINER	.46	62 NT053	OSCILLATING GEAR	1.43
20 MT017	LINE ROLLER COLLAR	.46	63 NT068	CLICK LEAF SPRING	.98
21 MT015	LINE ROLLER	.46	64 NT067	CLICK LEAF SPRING SCRM	.85
22 MT004	LINE ROLLER	1.72	65 NT014	ANTI-REV PAML COLLAR	.98
23 MT016	LINE ROLLER BUSHING	.46	66 NT063	ANTI-REV. PAML A	1.27
24 NT347	BAIL	4.02	67 NT064	ANTI-REV. PAML B	1.43
25 NT044	BAIL HOLDER PIN	1.83	68 NT061	ANTI-REV PAML SPG A	.85
26 MT003	BAIL TRIP CAM RET.	.85	69 NT089	ANTI-REV PAML SCREW	.85
27 NT020	BAIL SPG SHAFT HLDG	.98	70 NT089	ANTI-REV. LEVER	1.27
28 NT022	BAIL SPRING	.46	71 NT052	BUSHING	2.24
29 NT029	BAIL SPRING SHAFT	1.09	72 NT253	OSCILLATING PN GEAR	1.66
30 NT087	BAIL SPRING COVER	.98	73 NT086	ANTI-REV PAML SPG B	.98
31 NT085	BAIL SPG COVER SCRM	1.09	74 NT012	DRIVE GEAR	10.61
32 NT080	BEARING RET. SCREW A	.98	75 NT026	DRIVE GEAR WASHER	.46
33 NT093	BEARING RET. SCREW B	.85	76 NT157	BALL BEARING	9.12
34 NT082	BAIL TRIP PLATE	1.43	77 NT323	SIDE COVER	5.90
35 NT027	PINION WASHER	.85	78 NT318	HANDLE ASBY.	10.49
36 NT040	BEARING RETAINER	1.83	79 NT073	HANDLE SCREW CAP	2.30
37 NT028	BALL BEARING	9.12	80 NT121	DRAG SCREW	1.43
38 NT060	ANTI-REV. RATCHET	3.73			
39 NT011	PINION GEAR	6.82			
40 NT301	BODY	9.46			
41 NT066	CLICK GEAR	1.83			
42 NT058	RTR NUT LOCK SCREW	.85			

*Not pictured
Located between Keys 48 & 50

Prices subject to change without notice. Prices do not include postage and handling.

PLEASE ORDER BY PART NUMBER

Rev. 11/80

Zebco Division Brunswick Corporation, Box 276, Tula, OK 74101 USA 918-686-8881

